

Exam Questions AZ-303

Microsoft Azure Architect Technologies (beta)

<https://www.2passeasy.com/dumps/AZ-303/>



NEW QUESTION 1

- (Exam Topic 1)

You need to identify the storage requirements for Contoso.

For each of the following statements, select Yes if the statement is true. Otherwise, select No. NOTE: Each correct selection is worth one point.

Statements	Yes	No
Contoso requires a storage account that supports Blob storage.	<input type="radio"/>	<input type="radio"/>
Contoso requires a storage account that supports Azure Table storage.	<input type="radio"/>	<input type="radio"/>
Contoso requires a storage account that supports Azure File Storage.	<input type="radio"/>	<input type="radio"/>

A. Mastered

B. Not Mastered

Answer: A

Explanation:

Box 1: Yes

Contoso is moving the existing product blueprint files to Azure Blob storage.

Use unmanaged standard storage for the hard disks of the virtual machines. We use Page Blobs for these. Box 2: No

Box 3: No

NEW QUESTION 2

- (Exam Topic 1)

You need to configure the Device settings to meet the technical requirements and the user requirements. Which two settings should you modify? To answer, select the appropriate settings in the answer area.

Answer Area

 Save

 Discard

Users may join devices to Azure AD ⓘ

AllSelectedNone

Selected

No member selected

Additional local administrators on Azure AD joined devices ⓘ

SelectedNone

Selected

No member selected

Users may register their devices with Azure AD ⓘ

AllNone

Require Multi-Factor Auth to join devices ⓘ

YesNo

Maximum number of devices per user ⓘ

50

Users may sync settings and app data across devices ⓘ

AllSelectedNone

Selected

No member selected

A. Mastered

B. Not Mastered

Answer: A

Explanation:

Box 1: Selected

NEW QUESTION 3

- (Exam Topic 1)

You need to implement a backup solution for App1 after the application is moved. What should you create first?

- A. a recovery plan
- B. an Azure Backup Server
- C. a backup policy
- D. a Recovery Services vault

Answer: D

Explanation:

A Recovery Services vault is a logical container that stores the backup data for each protected resource, such as Azure VMs. When the backup job for a protected resource runs, it creates a recovery point inside the Recovery Services vault.

Scenario:

There are three application tiers, each with five virtual machines. Move all the virtual machines for App1 to Azure.

Ensure that all the virtual machines for App1 are protected by backups.

References: <https://docs.microsoft.com/en-us/azure/backup/quick-backup-vm-portal>

NEW QUESTION 4

- (Exam Topic 1)

You need to move the blueprint files to Azure. What should you do?

- A. Generate a shared access signature (SAS). Map a drive, and then copy the files by using File Explorer.
- B. Use the Azure Import/Export service.
- C. Generate an access key.
- D. Map a drive, and then copy the files by using File Explorer.
- E. Use Azure Storage Explorer to copy the files.

Answer: D

Explanation:

Azure Storage Explorer is a free tool from Microsoft that allows you to work with Azure Storage data on Windows, macOS, and Linux. You can use it to upload and download data from Azure blob storage.

Scenario:

Planned Changes include: move the existing product blueprint files to Azure Blob storage. Technical Requirements include: Copy the blueprint files to Azure over the Internet. References:

<https://docs.microsoft.com/en-us/azure/machine-learning/team-data-science-process/move-data-to-azure-blob-us>

NEW QUESTION 5

- (Exam Topic 1)

You need to meet the user requirement for Admin1. What should you do?

- A. From the Subscriptions blade, select the subscription, and then modify the Properties.
- B. From the Subscriptions blade, select the subscription, and then modify the Access control (IAM) settings.
- C. From the Azure Active Directory blade, modify the Properties.
- D. From the Azure Active Directory blade, modify the Groups.

Answer: A

Explanation:

Change the Service administrator for an Azure subscription

- > Sign in to Account Center as the Account administrator.
- > Select a subscription.
- > On the right side, select Edit subscription details.

Scenario: Designate a new user named Admin1 as the service administrator of the Azure subscription. References:

<https://docs.microsoft.com/en-us/azure/billing/billing-add-change-azure-subscription-administrator>

NEW QUESTION 6

- (Exam Topic 1)

You need to recommend a solution for App1. The solution must meet the technical requirements. What should you include in the recommendation? To answer, select the appropriate options in the answer area.

NOTE: Each correct selection is worth one point.

Number of virtual networks:

▼

1

2

3

Number of subnets per virtual network:

▼

1

2

3

- A. Mastered
- B. Not Mastered

Answer: A

Explanation:

Box 1: 3
One virtual network for every tier Box 2: 1
Only one subnet for each tier, to minimize the number of open ports.
Scenario: You have a public-facing application named App1. App1 is comprised of the following three tiers: ➤ A SQL database
➤ A web front end
➤ A processing middle tier
Each tier is comprised of five virtual machines. Users access the web front end by using HTTPS only. Technical requirements:
➤ Move all the virtual machines for App1 to Azure.
➤ Minimize the number of open ports between the App1 tiers.

NEW QUESTION 7

- (Exam Topic 2)
You have Azure Storage accounts as shown in the following exhibit.

Home > Storage accounts

Storage accounts

Contoso

+ Add

Edit columns

Refresh

Assign Tags

Delete

Subscriptions: All 2 selected – Don't see a subscription? Switch directories

Filter by name...

All subscriptions

All resource groups

All types

All locations

No grouping

3 items

<input type="checkbox"/>	NAME ↑	TYPE	KIND	RESOURCE ...	LOCATION	SUBSCRIPTL...	ACCESS T...	REPLICAT...
<input type="checkbox"/>	storageaccount1	Storage account	Storage	ContosoRG1	East US	Subscription 1	-	Read-access ge... ***
<input type="checkbox"/>	storageaccount2	Storage account	StorageV2	ContosoRG1	Central US	Subscription 1	Hot	Geo-redundant... ***
<input type="checkbox"/>	storageaccount3	Storage account	BlobStorage	ContosoRG1	East US	Subscription 1	Hot	Locally-redund... ***

Use the drop-down menus to select the answer choice that completes each statement based on the information presented in the graphic.
NOTE: Each correct selection is worth one point.

You can use [answer choice] for Azure Table Storage.

storageaccount1 only

storageaccount2 only

storageaccount3 only

storageaccount1 and storageaccount2 only

storageaccount2 and storageaccount3 only

You can use [answer choice] for Azure Blob storage.

storageaccount3 only

storageaccount2 and storageaccount3 only

storageaccount1 and storageaccount3 only

all the storage accounts

- A. Mastered
- B. Not Mastered

Answer: A

Explanation:

Note: The three different storage account options are: General-purpose v2 (GPv2) accounts, General-purpose v1 (GPv1) accounts, and Blob storage accounts.

- General-purpose v2 (GPv2) accounts are storage accounts that support all of the latest features for blobs, files, queues, and tables.
- Blob storage accounts support all the same block blob features as GPv2, but are limited to supporting only block blobs.
- General-purpose v1 (GPv1) accounts provide access to all Azure Storage services, but may not have the latest features or the lowest per gigabyte pricing.

References:

https://docs.microsoft.com/en-us/azure/storage/common/storage-account-options

NEW QUESTION 8

- (Exam Topic 2)

You create a virtual machine scale set named Scale1. Scale1 is configured as shown in the following exhibit. The subscription contains the Azure SQL databases shown in the following table.

INSTANCES

Instance count

4

Instance size

View full pricing details

D51_v2 (1 vCPU, 3.5 GB)

Deploy as low priority

No

Yes

Use managed disks

No

Yes

Show advanced settings

AUTOSCALE

Autoscale

Disabled

Enabled

Minimum number of VMs

2

Maximum number of VMs

20

Scale out

CPU threshold (%)

80

Number of VMs to increase by

2

Scale in

CPU threshold (%)

30

Number of VMs to decrease by

4

Use the drop-down menus to select the answer choice that completes each statement based on the information presented in the graphic.
NOTE: Each correct selection is worth one point.

If Scale1 is utilized at 85 percent for six minutes, Scale1 will be running [answer choice].

2 virtual machines

4 virtual machines

6 virtual machines

8 virtual machines

10 virtual machines

If Scale1 is first utilized at 25 percent for six minutes, and then utilized at 50 percent for six minutes, Scale1 will be running [answer choice].

2 virtual machines

4 virtual machines

6 virtual machines

8 virtual machines

10 virtual machines

- A. Mastered
- B. Not Mastered

Answer: A

Explanation:

Box 1:

The Autoscale scale out rule increases the number of VMs by 2 if the CPU threshold is 80% or higher. The initial instance count is 4 and rises to 6 when the 2 extra instances of VMs are added.

Box 2:

The Autoscale scale in rule decreases the number of VMs by 4 if the CPU threshold is 30% or lower. The initial instance count is 4 and thus cannot be reduced to 0 as the minimum instances is set to 2. Instances are only added when the CPU threshold reaches 80%.

References:

https://docs.microsoft.com/en-us/azure/azure-monitor/platform/autoscale-overview

<https://docs.microsoft.com/en-us/azure/azure-monitor/platform/autoscale-best-practices> <https://docs.microsoft.com/en-us/azure/azure-monitor/platform/autoscale-common-scale-patterns>

NEW QUESTION 9

- (Exam Topic 2)

You create a new Azure subscription. You create a resource group named RG1. In RG1, you create the resources shown in the following table.

Name	Type
VNET1	Virtual network
VM1	Virtual machine
GWSN1	Gateway subnet
VPNGW1	Virtual network gateway

You need to configure an encrypted tunnel between your on-premises network and VNET1.

Which two additional resources should you create in Azure? Each correct answer presents part of the solution.

- A. a point-to-site configuration
- B. a local network gateway
- C. a VNet-to-VNet connection
- D. a VPN gateway
- E. a site-to-site connection

Answer: DE

Explanation:

A Site-to-Site VPN gateway connection is used to connect your on-premises network to an Azure virtual network over an IPsec/IKE (IKEv1 or IKEv2) VPN tunnel. This type of connection requires a VPN device, a local network gateway, located on-premises that has an externally facing public IP address assigned to it. Finally, create a Site-to-Site VPN connection between your virtual network gateway and your on-premises VPN device.

References:

<https://docs.microsoft.com/en-us/azure/vpn-gateway/vpn-gateway-howto-site-to-site-resource-manager-portal>

NEW QUESTION 10

- (Exam Topic 2)

A company hosts virtual machines (VMs) in an on-premises datacenter and in Azure. The on-premises and Azure-based VMs communicate using ExpressRoute. The company wants to be able to continue regular operations if the ExpressRoute connection fails. Failover connections must use the Internet and must not require Multiprotocol Label Switching (MPLS) support.

You need to recommend a solution that provides continued operations. What should you recommend?

- A. Set up a second ExpressRoute connection.
- B. Increase the bandwidth of the existing ExpressRoute connection.
- C. Increase the bandwidth for the on-premises internet connection.
- D. Set up a VPN connection.

Answer: D

Explanation:

References:

<https://docs.microsoft.com/en-us/azure/architecture/reference-architectures/hybrid-networking/expressroutevpn->

NEW QUESTION 10

- (Exam Topic 2)

You have 10 Azure virtual machines on a subnet named Subnet1. Subnet1 is on a virtual network named VNet1.

You plan to deploy a public Azure Standard Load Balancer named LB1 to the same Azure region as the 10 virtual machines.

You need to ensure that traffic from all the virtual machines to the internet flows through LB1. The solution must prevent the virtual machines from being accessible on the internet.

Which three actions should you perform? Each correct answer presents part of the solution.

NOTE: Each correct selection is worth one point.

- A. Add health probes to LB1.
- B. Add the network interfaces of the virtual machines to the backend pool of LB1.
- C. Add an inbound rule to LB1.
- D. Add an outbound rule to LB1.
- E. Associate a network security group (NSG) to Subnet1.
- F. Associate a user-defined route to Subnet1.

Answer: ABD

Explanation:

Reference:

<https://docs.microsoft.com/en-us/azure/load-balancer/tutorial-load-balancer-standard-manage-portal2>

NEW QUESTION 15

- (Exam Topic 2)

You have an Azure subscription that contains multiple resource groups. You create an availability set as shown in the following exhibit.

Create availability set

*Name
AS1

*Subscription
Azure Pass

*Resource group
RG1

Create new

*Location
West Europe

Fault domains
2

Update domains
3

Use managed disks
No(Classic) Yes(Alignet)

You deploy 10 virtual machines to AS1.

Use the drop-down menus to select the answer choice that completes each statement based on the information presented in the graphic.

NOTE: Each correct selection is worth one point.

During planned maintenance, at least [answer choice]

4
5
6
8

 virtual machines will be available.

To add another virtual machines to AS1, the virtual machines must be added to [answer choice].

any region and the RG1 resource group
the West Europe region and any resource group
the West Europe region and the RG1 resource group

- A. Mastered
B. Not Mastered

Answer: A

Explanation:

Box 1: 6

Two out of three update domains would be available, each with at least 3 VMs.

An update domain is a group of VMs and underlying physical hardware that can be rebooted at the same time. As you create VMs within an availability set, the Azure platform automatically distributes your VMs across these update domains. This approach ensures that at least one instance of your application always remains running as the Azure platform undergoes periodic maintenance.

Box 2: the West Europe region and the RG1 resource group References:

<https://docs.microsoft.com/en-us/azure/virtual-machines/windows/regions-and-availability>

NEW QUESTION 18

- (Exam Topic 2)

Note: This question is part of series of questions that present the same scenario. Each question in the series contains a unique solution that might meet the stated goals. Some question sets might have more than one correct solution, while others might not have a correct solution.

After you answer a question in this section, you will NOT be able to return to it. As a result, these questions will not appear in the review screen.

You have a server named Server1 that runs Windows Server 2019. Server1 is a container host. You are creating a Dockerfile to build a container image.

You need to add a file named File1.txt from Server1 to a folder named C:\Folder1 in the container image. Solution: You add the following line to the Dockerfile.

ADD File1.txt C:/Folder1/

You then build the container image. Does this meet the goal?

- A. Yes
B. No

Answer: B

Explanation:

Copy is the correct command to copy a file to the container image. The ADD command can also be used. However, the root directory is specified as '/' and not as 'C:/'.

Reference:

https://docs.docker.com/develop/develop-images/dockerfile_best-practices/#add-or-copy <https://docs.docker.com/engine/reference/builder/>

NEW QUESTION 21

- (Exam Topic 2)

You network contains an Active Directory domain named adatum.com and an Azure Active Directory (Azure AD) tenant named adatum.onmicrosoft.com. Adatum.com contains the user accounts in the following table.

Name	Member of
User1	Domain Admins
User2	Schema Admins
User3	Incoming Forest Trust Builders
User4	Replicator
User5	Enterprise Admins

Adatum.onmicrosoft.com contains the user accounts in the following table.

Name	Role
UserA	Global administrator
UserB	User administrator
UserC	Security administrator
UserD	Service administrator

You need to implement Azure AD Connect. The solution must follow the principle of least privilege. Which user accounts should you use? To answer, select the appropriate options in the answer area. NOTE: Each correct selection is worth one point.

Adatum.com:

User1
User2
User3
User4
User5

Adatum.onmicrosoft.com:

UserA
UserB
UserC
UserD

- A. Mastered
- B. Not Mastered

Answer: A

Explanation:

Box 1: User5

In Express settings, the installation wizard asks for the following: AD DS Enterprise Administrator credentials

Azure AD Global Administrator credentials

The AD DS Enterprise Admin account is used to configure your on-premises Active Directory. These credentials are only used during the installation and are not used after the installation has completed. The Enterprise Admin, not the Domain Admin should make sure the permissions in Active Directory can be set in all domains. Box 2: UserA

Azure AD Global Admin credentials are only used during the installation and are not used after the installation has completed. It is used to create the Azure AD Connector account used for synchronizing changes to Azure AD. The account also enables sync as a feature in Azure AD.

References:

<https://docs.microsoft.com/en-us/azure/active-directory/connect/active-directory-aadconnect-accounts-permissio>

NEW QUESTION 22

- (Exam Topic 2)

Your company has an office in Seattle.

You have an Azure subscription that contains a virtual network named VNET1. You create a site-to-site VPN between the Seattle office and VNET1.

VNET1 contains the subnets shown in the following table.

Name	IP address space
Subnet1	10.1.1.0/24
GatewaySubnet	10.1.200.0/28

You need to redirect all Internet-bound traffic from Subnet1 to the Seattle office. What should you create?

- A. a route for Subnet1 That uses the virtual network gateway as the next hop
- B. a route for GatewaySubnet that uses the virtual network gateway as the next hop
- C. a route for GatewaySubnet that uses the local network gateway as the next hop
- D. a route for Subnet1 that uses The local network gateway as the next hop

Answer: B

Explanation:

A route with the 0.0.0.0/0 address prefix instructs Azure how to route traffic destined for an IP address that is not within the address prefix of any other route in a subnet's route table. When a subnet is created, Azure creates a default route to the 0.0.0.0/0 address prefix, with the Internet next hop type. We need to create a custom route in Azure to use a virtual network gateway in the Seattle office as the next hop.

References:

<https://docs.microsoft.com/en-us/azure/virtual-network/virtual-networks-udr-overview>

NEW QUESTION 24

- (Exam Topic 2)

You have a virtual network named VNet1 as shown in the exhibit.

 Refresh

 Move

 Delete

Resource group [\(change\)](#)
Production

Address space
10.2.0.0/16

Location
West US

DNS servers
Azure provided DNS service

Subscription [\(change\)](#)
Production subscription

Subscription ID
14d26092-8e42-4ea7-b770-9dcef70fb1ea

Tags [\(change\)](#)
[Click here to add tags](#)

Connected devices

 Search connected devices

Device	Type	Ip Address	Subnet
No results.			

No devices are connected to VNet1.

You plan to peer VNet1 to another virtual network named Vnet2 in the same region. VNet2 has an address space of 10.2.0.0/16.

You need to create the peering. What should you do first?

- A. Modify the address space of VNet1.
- B. Configure a service endpoint on VNet2
- C. Add a gateway subnet to VNet1.
- D. Create a subnet on VNet1 and VNet2.

Answer: A

Explanation:

The virtual networks you peer must have non-overlapping IP address spaces. References:

<https://docs.microsoft.com/en-us/azure/virtual-network/virtual-network-manage-peering#requirements-and-cons>

NEW QUESTION 25

- (Exam Topic 2)

You have an Azure subscription that contains the Azure SQL servers shown in the following table.

Name	Region	In resource group
Sql1	West US	RG1
Sql2	West US	RG1

The subscription contains the elastic pool shown in the following table.

Name	On Azure SQL server
Pool1	Sql1
Pool2	Sql1
Pool3	Sql2

The subscription contains the Azure SQL databases shown in the following table.

Name	On Azure SQL server	Pool
DB1	Sql1	Pool1
DB2	Sql1	Pool2
DB3	Sql1	None

For each of the following statements, select Yes if the statement is true. Otherwise, select No. NOTE: Each correct selection is worth one point.

Answer Area

Statements	Yes	No
DB1 can be removed from Pool1 and added to Pool2.	<input type="radio"/>	<input type="radio"/>
DB2 can be removed from Pool2 and added to Pool3.	<input type="radio"/>	<input type="radio"/>
DB3 can be added to Pool1.	<input type="radio"/>	<input type="radio"/>

- A. Mastered
- B. Not Mastered

Answer: A

Explanation:

Note: You cannot add databases from different servers into the same pool
Box 1: Yes
Pool2 contains DB2 but DB1 and DB2 are on Sql1. DB1 can thus be added to Pool2.
Box 2: Yes
Pool3 is empty.
Box 3: Yes
Pool1 contains DB1 but DB3 and DB1 are on Sql1. DB3 can thus be added to Pool1.
References:
<https://docs.microsoft.com/en-us/azure/sql-database/sql-database-elastic-pool>

NEW QUESTION 30

- (Exam Topic 2)

You have an Azure subscription that contains the storage accounts shown in the following table.

Name	Contains
storagecontoso1	A blob service and a table service
storagecontoso2	A blob service and a file service
storagecontoso3	A queue service
storagecontoso4	A file service and a queue service
storagecontoso5	A table service

You enable Azure Advanced Threat Protection (ATP) for all the storage accounts. You need to identify which storage accounts will generate Azure ATP alerts. Which two storage accounts should you identify? Each correct answer presents part of the solution. NOTE: Each correct selection is worth one point.

- A. storagecontoso1
- B. storagecontoso2
- C. storagecontoso3
- D. storagecontoso4
- E. storaaecontoso5

Answer: AB

Explanation:

Advanced threat protection for Azure Storage is currently available only for Blob Storage.

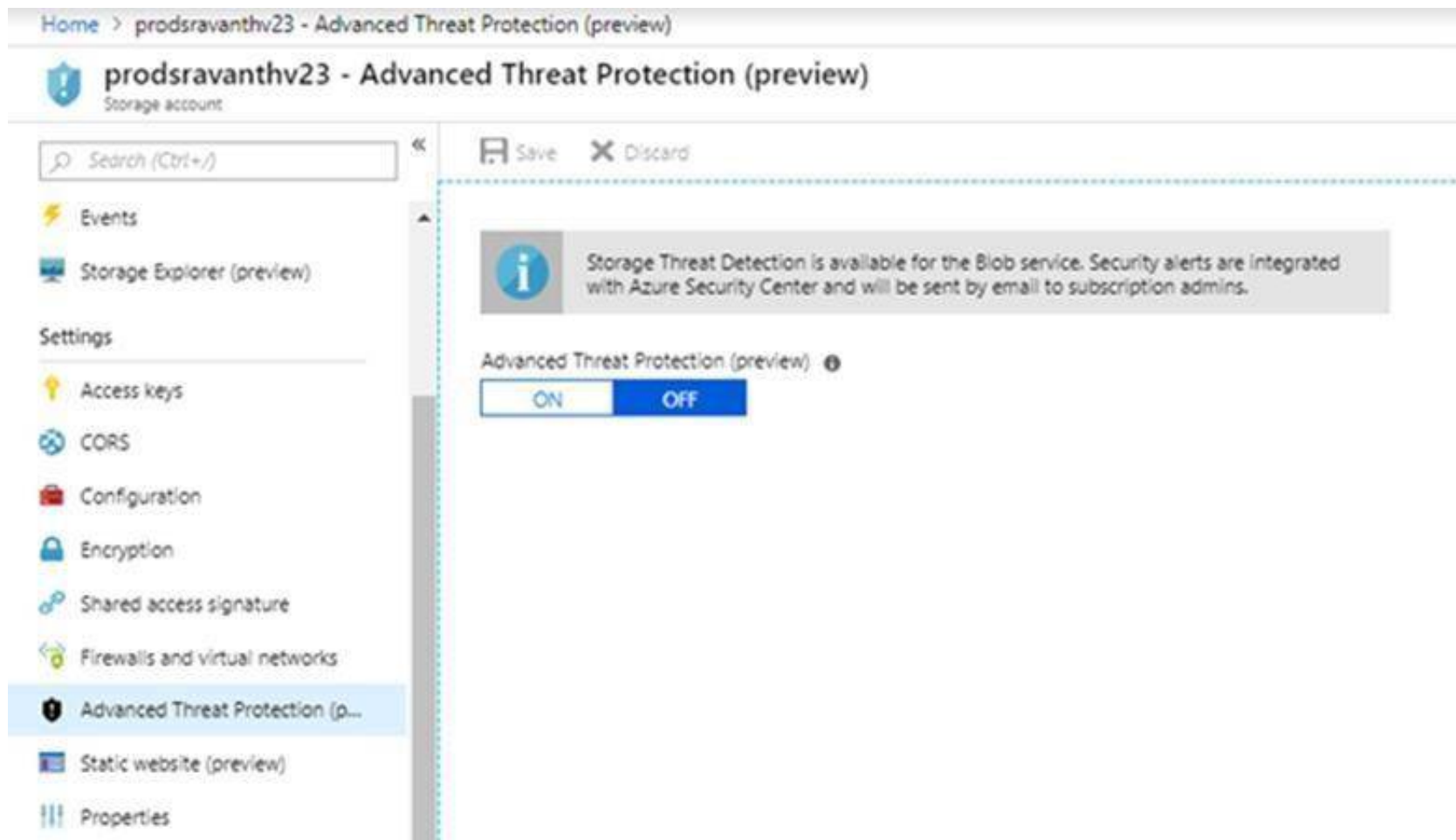

<https://docs.microsoft.com/en-us/azure/storage/common/storage-advanced-threat-protection?tabs=azure-portal>

NEW QUESTION 33

- (Exam Topic 2)

Your company has a virtualization environment that contains the virtualization hosts shown in the following table.

Name	Hypervisor	Guest
Server1	VMware	VM1, VM2, VM3
Server2	Hyper-V	VMA, VMB, VMC

The virtual machines are configured as shown in the following table.

Name	Generation	Memory	Operating system (OS)	OS disk	Data disk
VM1	Not applicable	4 GB	Windows Server 2016	200 GB	800 GB
VM2	Not applicable	12 GB	Red Hat Enterprise Linux 7.2	3 TB	200 GB
VM3	Not applicable	32 GB	Windows Server 2012 R2	200 GB	1 TB
VMA	1	8 GB	Windows Server 2012	100 GB	2 TB
VMB	1	16 GB	Red Hat Enterprise Linux 7.2	150 GB	3 TB
VMC	2	24 GB	Windows Server 2016	500 GB	6 TB

All the virtual machines use basic disks. VM1 is protected by using BitLocker Drive Encryption (BitLocker). You plan to migrate the virtual machines to Azure by using Azure Site Recovery.

You need to identify which virtual machines can be migrated.

Which virtual machines should you identify for each server? To answer, select the appropriate options in the answer area.

NOTE: Each correct selection is worth one point.

The virtual machines that can be migrated from Server1.

- VM1 only
- VM2 only
- VM3 only
- VM1 and VM2 only
- VM1 and VM3 only
- VM1, VM2, and VM3

The virtual machines that can be migrated from Server2.

- VMA only
- VMB only
- VMC only
- VMA and VMB only
- VMA and VMC only
- VMA, VMB, and VMC

- A. Mastered
- B. Not Mastered

Answer: A

Explanation:

The virtual machines that can be migrated from Server1.

VM1 only
VM2 only
VM3 only
VM1 and VM2 only
VM1 and VM3 only
VM1, VM2, and VM3

The virtual machines that can be migrated from Server2.

VMA only
VMB only
VMC only
VMA and VMB only
VMA and VMC only
VMA, VMB, and VMC

NEW QUESTION 36

- (Exam Topic 2)

You have an Azure subscription that contains the storage accounts shown in the following table.

Name	Kind	Performance tier	Replication	Location
storage1	StorageV2	Premium	Locally-redundant storage (LRS)	East US
storage2	Storage	Standard	Geo-redundant storage (GRS)	UK West
storage3	BlobStorage	Standard	Locally-redundant storage (LRS)	North Europe

For each of the following statements, select Yes if the statement is true. Otherwise, select No. NOTE: Each correct selection is worth one point.

Answer Area

Statements	Yes	No
storage1 can host Azure file shares.	<input type="radio"/>	<input type="radio"/>
There are six copies of the data in storage2.	<input type="radio"/>	<input type="radio"/>
storage3 can be converted to a GRS account.	<input type="radio"/>	<input type="radio"/>

- A. Mastered
- B. Not Mastered

Answer: A

Explanation:

Answer Area

Statements	Yes	No
storage1 can host Azure file shares.	<input type="radio"/>	<input checked="" type="radio"/>
There are six copies of the data in storage2.	<input checked="" type="radio"/>	<input type="radio"/>
storage3 can be converted to a GRS account.	<input checked="" type="radio"/>	<input type="radio"/>

NEW QUESTION 40

- (Exam Topic 2)

You have an Azure App Service app.

You need to implement tracing for the app. The tracing information must include the following:

- > Usage trends
- > AJAX call responses
- > Page load speed by browser
- > Server and browser exceptions

What should you do?

- A. Configure IIS logging in Azure Log Analytics.
- B. Configure a connection monitor in Azure Network Watcher.
- C. Configure custom logs in Azure Log Analytics.
- D. Enable the Azure Application Insights site extension.

Answer: D

Explanation:

For web pages, Application Insights JavaScript SDK automatically collects AJAX calls as dependencies. Note: Some of the things you can track or collect are: What are the most popular webpages in your application, at what time of day and where is that traffic coming from?

Dependency rates or response times and failure rates to find out if there's an external service that's causing performance issues on your app, maybe a user is using a portal to get through to your application and there are response time issues going through there for instance.

Exceptions for both server and browser information, as well as page views and load performance from the end users' side.

Reference:

<https://azure.microsoft.com/en-us/blog/ajax-collection-in-application-insights/> <https://blog.pragmaticworks.com/what-is-application-insights>

NEW QUESTION 44

- (Exam Topic 2)

An administrator plans to create a function app in Azure that will have the following settings:

- > Runtime stack: .NET Core
- > Operating System: Linux
- > Plan type: Consumption
- > Enable Application Insights: Yes

You need to ensure that you can back up the function app.

Which settings should you recommend changing before creating the function app? D18912E1457D5D1DDCBD40AB3BF70D5D

- A. Runtime stack
- B. Enable Application Insights
- C. Operating System
- D. Plan type

Answer: D

Explanation:

The Backup and Restore feature requires the App Service plan to be in the Standard, Premium or Isolated tier. Reference:

<https://docs.microsoft.com/en-us/azure/app-service/manage-backup#requirements-and-restrictions>

NEW QUESTION 48

- (Exam Topic 2)

You have an Azure subscription that contains 10 virtual machines on a virtual network.

You need to create a graph visualization to display the traffic flow between the virtual machines. What should you do from Azure Monitor?

- A. From Activity log, use quick insights.
- B. From Metrics, create a chart.
- C. From Logs, create a new query.
- D. From Workbooks, create a workbook.

Answer: C

Explanation:

Navigate to Azure Monitor and select Logs to begin querying the data Reference:

<https://azure.microsoft.com/en-us/blog/analysis-of-network-connection-data-with-azure-monitor-for-virtual-mac>

NEW QUESTION 49

- (Exam Topic 2)

You have an Azure Active Directory (Azure AD) tenant named contoso.com. The tenant contains the users shown in the following table.

Name	Member of
User1	Group1
User2	Group2

The tenant contains computers that run Windows 10. The computers are configured as shown in the following table.

Name	Member of
Computer1	GroupA
Computer2	GroupA
Computer3	GroupB

You enable Enterprise State Roaming in contoso.com for Group1 and GroupA.
 For each of the following statements, select Yes if the statement is true. Otherwise, select No.
 NOTE: Each correct selection is worth one point.

Answer Area

Statements	Yes	No
If User1 modifies the desktop background of Computer1, User1 will see the changed background when signing in to Computer3.	<input type="radio"/>	<input type="radio"/>
If User2 modifies the desktop background of Computer1, User2 will see the changed background when signing in to Computer2.	<input type="radio"/>	<input type="radio"/>
If User1 modifies the desktop background of Computer3, User1 will see the changed background when signing in to Computer2.	<input type="radio"/>	<input type="radio"/>

- A. Mastered
- B. Not Mastered

Answer: A

Explanation:
 Enterprise State Roaming provides users with a unified experience across their Windows devices and reduces the time needed for configuring a new device.
 Box 1: Yes
 Box 2: No
 Box 3: Yes
 References:
<https://docs.microsoft.com/en-us/azure/active-directory/devices/enterprise-state-roaming-overview>

NEW QUESTION 54

- (Exam Topic 2)
 You are implementing authentication for applications in your company. You plan to implement self-service password reset (SSPR) and multifactor authentication (MFA) in Azure Active Directory (Azure AD).
 You need to select authentication mechanisms that can be used for both MFA and SSPR.
 Which two authentication methods should you use? Each correct answer presents a complete solution. NOTE: Each correct selection is worth one point.

- A. Short Message Service (SMS) messages
- B. Authentication app
- C. Email addresses
- D. Security questions
- E. App passwords

Answer: AB

Explanation:
 References:
<https://docs.microsoft.com/en-us/azure/active-directory/authentication/concept-authentication-methods>

NEW QUESTION 59

- (Exam Topic 2)
 You have an Azure subscription.
 You have an on-premises virtual machine named VM1. The settings for VM1 are shown in the exhibit. (Click the Exhibit tab.)

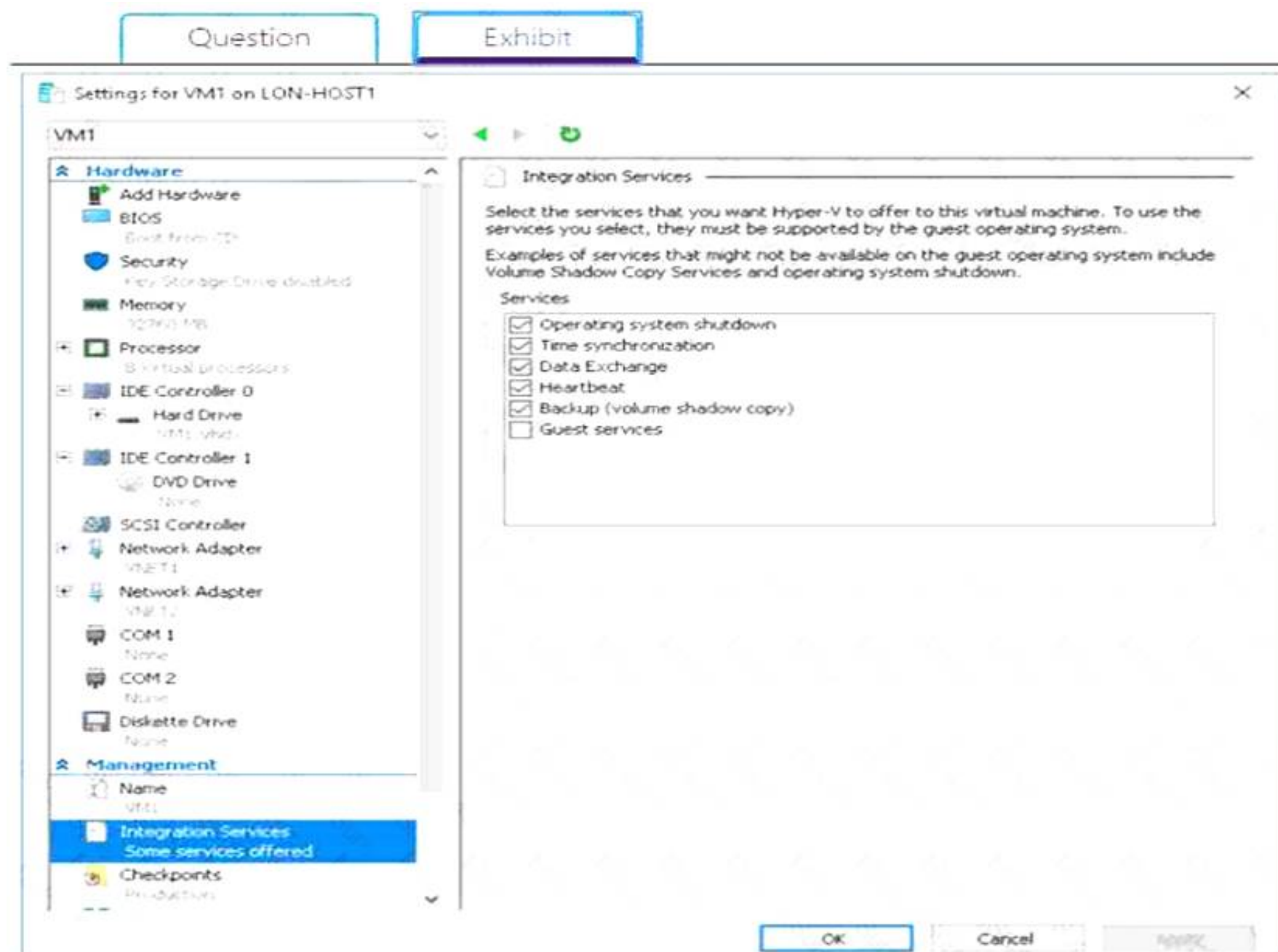

You need to ensure that you can use the disks attached to VM1 as a template for Azure virtual machines. What should you modify on VM1?

- A. the hard drive
- B. Integration Services
- C. the memory
- D. the network adapters
- E. the processor

Answer: A

Explanation:

From the exhibit we see that the disk is in the VHDX format.

Before you upload a Windows virtual machines (VM) from on-premises to Microsoft Azure, you must prepare the virtual hard disk (VHD or VHDX). Azure supports only generation 1 VMs that are in the VHD file format and have a fixed sized disk. The maximum size allowed for the VHD is 1,023 GB. You can convert a generation 1 VM from the VHDX file system to VHD and from a dynamically expanding disk to fixed-sized.

References:

[https://docs.microsoft.com/en-us/azure/virtual-machines/windows/prepare-for-upload-vhd-image?toc=azure virtual-machines windows toc.json](https://docs.microsoft.com/en-us/azure/virtual-machines/windows/prepare-for-upload-vhd-image?toc=azure%20virtual-machines%20windows%20toc.json)

NEW QUESTION 64

- (Exam Topic 2)

You create an Azure virtual machine named VM1 in a resource group named RG1. You discover that VM1 performs slower than expected.

You need to capture a network trace on VM1. What should you do?

- A. From Diagnostic settings for VM1, configure the performance counters to include network counters.
- B. From the VM1 blade, configure Connection troubleshoot.
- C. From the VM1 blade, install performance diagnostics and run advanced performance analysis
- D. From Diagnostic settings for VM1, configure the log level of the diagnostic agent.

Answer: C

Explanation:

The performance diagnostics tool helps you troubleshoot performance issues that can affect a Windows or Linux virtual machine (VM). Supported troubleshooting scenarios include quick checks on known issues and best practices, and complex problems that involve slow VM performance or high usage of CPU, disk space, or memory.

Advanced performance analysis, included in the performance diagnostics tool, includes all checks in the performance analysis, and collects one or more of the traces, as listed in the following sections. Use this scenario to troubleshoot complex issues that require additional traces. Running this scenario for longer periods will increase the overall size of diagnostics output, depending on the size of the VM and the trace options that are selected.

References:

<https://docs.microsoft.com/en-us/azure/virtual-machines/troubleshooting/performance-diagnostics>

NEW QUESTION 67

- (Exam Topic 2)

You have an Azure Container Registry and an Azure container instance.

You pull an image from the registry, and then update the local copy of the image.
 You need to ensure that the updated image can be deployed to the container instance. The solution must ensure that you can deploy the updated image or the previous version of the image.
 What should you do?

- A. Run the docker image push command and specify the tag parameter.
- B. Run the az image copy command and specify the tag paramete
- C. Run the az aks update command and specify the attach-acr parameter.
- D. Run the kubectl apply command and specify the dry-run parameter.

Answer: B

NEW QUESTION 69

- (Exam Topic 2)

You have the Azure SQL Database servers shown in the following table.

Name	Elastic pool
sqlserver1	Pool1
sqlserver2	Pool1, Pool2

You have the Azure SQL databases shown in the following table.

Name	Azure SQL Database server	Elastic pool
DB1	sqlserver1	None
DB2	sqlserver1	Pool1
DB3	sqlserver2	Pool1
DB4	sqlserver2	Pool2

You create a failover group named failover1 that has the following settings:

- Primary server: sqlserver1
- Secondary server: sqlserver2
- Read/Write failover policy: Automatic
- Read/Write grace period (hours): 1 hour

Statements	Yes	No
You can add DB1 to failover1.	<input type="radio"/>	<input type="radio"/>
You can add DB3 to failover1.	<input type="radio"/>	<input type="radio"/>
Sqlserver1 and sqlserver2 are in the same Azure region.	<input type="radio"/>	<input type="radio"/>

- A. Mastered
- B. Not Mastered

Answer: A

Explanation:

Statements	Yes	No
You can add DB1 to failover1.	<input checked="" type="radio"/>	<input type="radio"/>
You can add DB3 to failover1.	<input type="radio"/>	<input checked="" type="radio"/>
Sqlserver1 and sqlserver2 are in the same Azure region.	<input checked="" type="radio"/>	<input type="radio"/>

NEW QUESTION 74

- (Exam Topic 2)

You have an Azure subscription that contains an Azure Log Analytics workspace. You have a resource group that contains 100 virtual machines. The virtual machines run Linux. You need to collect events from the virtual machines to the Log Analytics workspace. Which type of data source should you configure in the workspace?

- A. Syslog
- B. Linux performance counters
- C. custom fields

Answer: A

Explanation:

<https://docs.microsoft.com/en-us/azure/azure-monitor/learn/quick-collect-azurevm>

Syslog is an event logging protocol that is common to Linux. Applications will send messages that may be stored on the local machine or delivered to a Syslog collector. When the Log Analytics agent for Linux is installed, it configures the local Syslog daemon to forward messages to the agent. The agent then sends the

message to Azure Monitor where a corresponding record is created.
Reference:
<https://docs.microsoft.com/en-us/azure/azure-monitor/platform/data-sources-custom-logs>

NEW QUESTION 77

- (Exam Topic 2)

Note: This question is part of a series of questions that present the same scenario. Each question in the series contains a unique solution that might meet the stated goals. Some question sets might have more than one correct solution, while others might not have a correct solution.

After you answer a question in this section, you will NOT be able to return to it. As a result, these questions will not appear in the review screen.

Your company is deploying an on-premises application named Appl. Users will access App1 by using a URL of <https://app1.contoso.com>. You register App1 in Azure Active Directory (Azure AD) and publish Appl by using the Azure AD Application Proxy. You need to ensure that Appl appears in the My Apps portal for all the users.

Solution: You create an offer for App1 and publish the offer to Azure Marketplace.

- A. Yes
- B. No

Answer: A

NEW QUESTION 82

- (Exam Topic 2)

: 292 HOTSPOT

From Azure Cosmos DB, you create the containers shown in the following table.

Container ID	Partition key	Unique key
Container1	/category	None
Container2	/id	/importance

You add the following item to Container1.

```
{
  "id": "1",
  "category": "personal",
  "name": "Name1",
  "description": "Description1"
}
```

You plan to add items to Azure Cosmos DB as shown in the following table.

Name	Content
Item1	{ "id": "1", "category": "personal", "name": "Name1", "description": "Description1" }
Item2	{ "category": "business", "name": "Name2", "description": "Description2", "importance": "High" }
Item3	{ "id": "3", "name": "Name3", "description": "Description3" }
Item4	{ "id": "4", "importance": "Low" }

You need to identify which items can be added successfully to Container1 and Container2.
What should you identify for each container? To answer, select the appropriate options in the answer area.
NOTE: Each correct selection is worth one point.

Container1:

▼

Item2 only

Item1 and Item2 only

Item3 and Item4 only

Item2, Item3, and Item4 only

Item1, Item2, Item3, and Item4

Container2:

▼

Item4 only

Item2 and Item4 only

Item1, Item3, and Item4 only

Item1, Item2, Item3, and Item4

- A. Mastered
- B. Not Mastered

Answer: A

Explanation:

Container1:

▼

Item2 only

Item1 and Item2 only

Item3 and Item4 only

Item2, Item3, and Item4 only

Item1, Item2, Item3, and Item4

Container2:

▼

Item4 only

Item2 and Item4 only

Item1, Item3, and Item4 only

Item1, Item2, Item3, and Item4

NEW QUESTION 87

- (Exam Topic 2)

You have an on-premises virtual machine named VM1 configured as shown in the following exhibit.

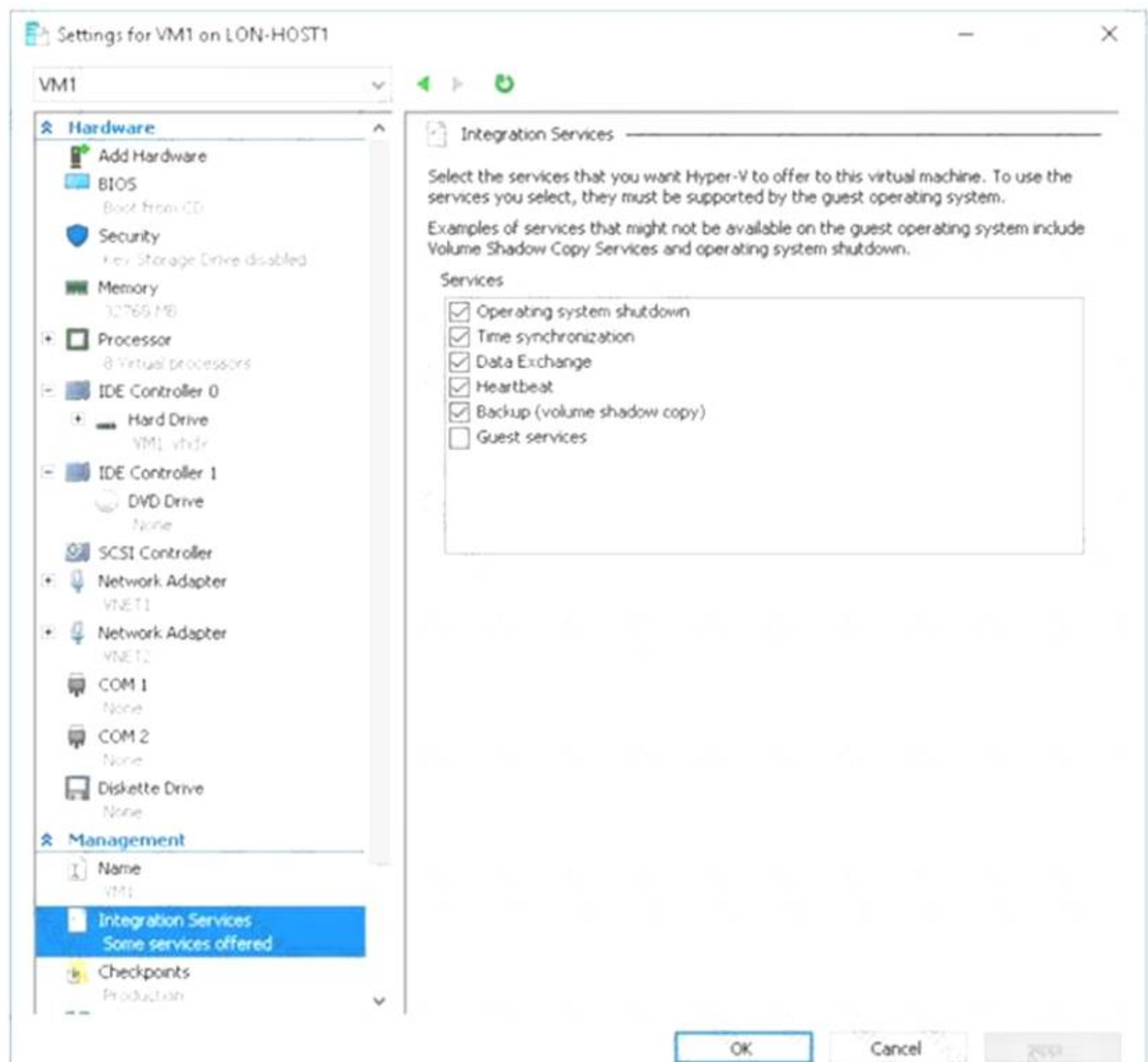

VM is started.
You need to create a new virtual machine image in Azure from VM1.
Which three actions should you perform before you create the new image? Each correct answer presents part of the solution.
NOTE: Each correct selection is worth one point.

- A. Remove the Backup (volume shadow copy) integration service
- B. Generalize VM1
- C. Run Add-AzureRmVhd and specify a blob service container as the destination
- D. Run Add-AzureRmVhd and specify a file share as the destination
- E. Reduce the amount of memory to 16 GB
- F. Convert the disk type to VHD

Answer: BCF

NEW QUESTION 92

- (Exam Topic 2)
You have a hierarchy of management groups and Azure subscriptions as shown in the following table.

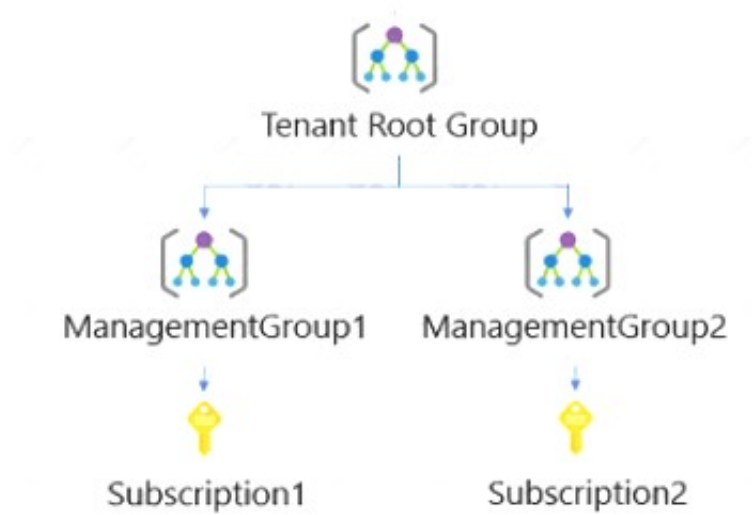

You create the Azure resources shown in the following table.

Name	Type	Created in
RG1	Resource group	Subscription1
RG2	Resource group	Subscription2
VM2	Virtual machine	RG2

You assign roles to users as shown in the following table.

User name	Role	On resource
User1	Contributor	ManagementGroup1
User2	Contributor	ManagementGroup2
User3	Reader	Tenant Root Group

For each of the following statements, select Yes if the statement is true. Otherwise, select No. NOTE: Each correct selection is worth one point

Statements	Yes	No
You can remove User1 from the Contributor role for RG1.	<input type="radio"/>	<input type="radio"/>
User2 can delete VM2.	<input type="radio"/>	<input type="radio"/>
You can add User3 as a Contributor for RG1.	<input type="radio"/>	<input type="radio"/>

- A. Mastered
- B. Not Mastered

Answer: A

Explanation:

Statements	Yes	No
You can remove User1 from the Contributor role for RG1.	<input checked="" type="radio"/>	<input type="radio"/>
User2 can delete VM2.	<input checked="" type="radio"/>	<input type="radio"/>
You can add User3 as a Contributor for RG1.	<input checked="" type="radio"/>	<input type="radio"/>

NEW QUESTION 96

- (Exam Topic 2)

Note: This question is part of series of questions that present the same scenario. Each question in the series contains a unique solution that might meet the stated goals. Some question sets might have more than one correct solution, while others might not have a correct solution.

After you answer a question in this section, you will NOT be able to return to it. As a result, these questions will not appear in the review screen.

You have a server named Server1 that runs Windows Server 2019. Server1 is a container host. You are creating a Dockerfile to build a container image.

You need to add a file named File1.txt from Server1 to a folder named C:\Folder1 in the container image. Solution: You add the following line to the Dockerfile.

COPY File1.txt C:/Folder1/

You then build the container image. Does this meet the goal?

- A. Yes
- B. No

Answer: B

Explanation:

Copy is the correct command to copy a file to the container image but the root directory is specified as '/' and not as 'C:/'.

References:

https://docs.docker.com/develop/develop-images/dockerfile_best-practices/#add-or-copy https://docs.docker.com/engine/reference/builder/

NEW QUESTION 97

- (Exam Topic 2)

You create a container image named Image1 on a developer workstation.

You plan to create an Azure Web App for Containers named WebAppContainer that will use Image1. You need to upload Image1 to Azure. The solution must ensure that WebAppContainer can use Image1. To which storage type should you upload Image1?

- A. Azure Container Registry
- B. an Azure Storage account that contains a blob container
- C. an Azure Storage account that contains a file share
- D. Azure Container Instances

Answer: A

Explanation:

Configure registry credentials in web app.

App Service needs information about your registry and image to pull the private image. In the Azure portal, go to Container settings from the web app and update the Image source, Registry and save.

References:

<https://docs.microsoft.com/en-us/azure/devops/pipelines/targets/webapp-on-container-linux>

NEW QUESTION 99

- (Exam Topic 2)

Your company hosts multiple websites by using Azure virtual machine scale sets (VMSS) that run Internet Information Server (IIS).

All network communications must be secured by using end to end Secure Socket Layer (SSL) encryption. User sessions must be routed to the same server by using cookie-based session affinity.

The image shown depicts the network traffic flow for the websites to the VMSS.

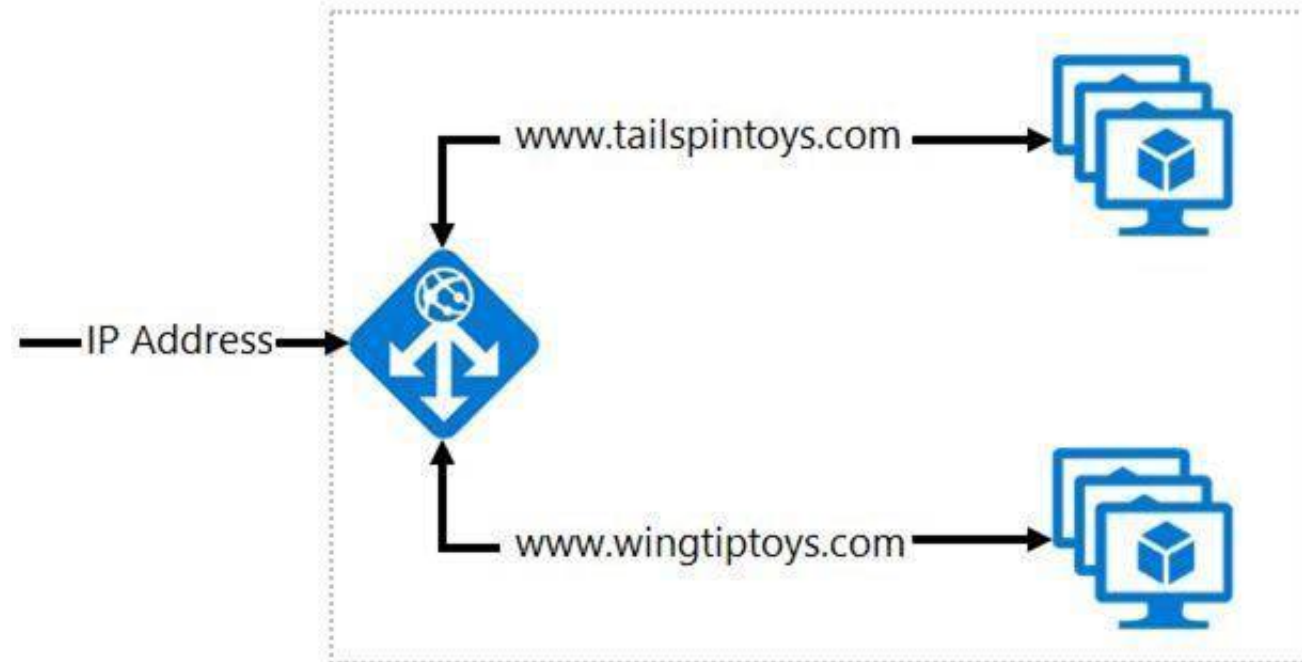

Use the drop-down menus to select the answer choice that answers each question.

NOTE: Each correct selection is worth one point.

Which Azure solution should you create to route the web application traffic to the VMSS?

	▼
Azure VPN Gateway	
Azure Application Gateway	
Azure ExpressRoute	
Azure Network Watcher	

What should you configure to make sure web traffic arrives at the appropriate server in the VMSS?

	▼
Routing rules and backend listeners	
CNAME and A records	
Routing method and DNS time to live (TTL)	
Path-based redirection and WebSockets	

- A. Mastered
- B. Not Mastered

Answer: A

Explanation:

Box 1: Azure Application Gateway

You can create an application gateway with URL path-based redirection using Azure PowerShell. Box 2: Path-based redirection and Websockets

Reference:

<https://docs.microsoft.com/bs-latn-ba/azure//application-gateway/tutorial-url-redirect-powershell>

NEW QUESTION 103

- (Exam Topic 2)

You have an Azure Kubernetes Service (AKS) cluster named Clus1 in a resource group named RG1. An administrator plans to manage Clus1 from an Azure AD-joined device.

You need to ensure that the administrator can deploy the YAML application manifest file for a container application.

You install the Azure CLI on the device. Which command should you run next?

- A. kubectl get nodes
- B. az aks install-cli
- C. kubectl apply -f app1.yaml
- D. az aks get-credentials --resource-group RG1 --name Clus1

Answer: C

Explanation:

kubectl apply -f appl.yaml applies a configuration change to a resource from a file or stdin. References:
<https://kubernetes.io/docs/reference/kubectl/overview/> <https://docs.microsoft.com/en-us/cli/azure/aks>

NEW QUESTION 108

- (Exam Topic 2)

Note: This question is part of a series of questions that present the same scenario. Each question in the series contains a unique solution that might meet the stated goals. Some question sets might have more than one correct solution, while others might not have a correct solution.

After you answer a question in this section, you will NOT be able to return to it As a result, these questions will not appear in the review screen.

You have an Azure Active Directory {Azure AD} tenant named contoso.com.

A user named Admin1 attempts to create an access review from the Azure Active Directory admin center and discovers that the Access reviews settings are unavailable. Admin 1 discovers that all the other Identity Governance settings are available.

Admin1 is assigned The User administrator, Compliance administrator, and Security administrator roles. You need to ensure that Admin1 can create access reviews in contoso.com. .

Solution: You assign the Global administrator role to Admin1. Does this meet the goal?

- A. Yes
- B. No

Answer: B

Explanation:

Instead use Azure AD Privileged Identity Management.

Note: PIM essentially helps you manage the who, what, when, where, and why for resources that you care about. Key features of PIM include:

- Conduct access reviews to ensure users still need roles References:
<https://docs.microsoft.com/en-us/azure/active-directory/privileged-identity-management/pim-configure>

NEW QUESTION 111

- (Exam Topic 2)

You have a web server app named App1 that is hosted in three Azure regions. You plan to use Azure Traffic Manager to distribute traffic optimally for App1.

You need to enable Real User Measurements to monitor the network latency data for App1. What should you do? To answer, select the appropriate options in the answer area.

NOTE: Each correct selection is worth one point.

From the Traffic Manager profile:

	▼
Select Generate key.	
Enable Traffic view.	
Configure the Diagnostics settings.	
Add a custom header.	

From App1:

	▼
Embed the Traffic Manager JavaScript code snippet.	
Embed the Azure Application Insights JavaScript code snippet.	
Configure the Diagnostics settings.	
Configure the Application settings.	

- A. Mastered
- B. Not Mastered

Answer: A

Explanation:

Box 1: Select Generate key

You can configure your web pages to send Real User Measurements to Traffic Manager by obtaining a Real User Measurements (RUM) key and embedding the generated code to web page.

Obtain a Real User Measurements key

The measurements you take and send to Traffic Manager from your client application are identified by the service using a unique string, called the Real User Measurements (RUM) Key. You can get a RUM key using the Azure portal, a REST API, or by using the PowerShell or Azure CLI.

To obtain the RUM Key using Azure portal:

- From a browser, sign in to the Azure portal. If you don't already have an account, you can sign up for a free one-month trial.
- In the portal's search bar, search for the Traffic Manager profile name that you want to modify, and then click the Traffic Manager profile in the results that the displayed.
- In the Traffic Manager profile blade, click Real User Measurements under Settings.
- Click Generate Key to create a new RUM Key.

Box 2: Embed the Traffic Manager JavaScript code snippet. Embed the code to an HTML web page

After you have obtained the RUM key, the next step is to embed this copied JavaScript into an HTML page that your end users visit.

This example shows how to update an HTML page to add this script. You can use this guidance to adapt it to your HTML source management workflow.

- Open the HTML page in a text editor

> Paste the JavaScript code you had copied in the earlier step to the BODY section of the HTML (the copied code is on line 8 & 9, see figure 3).

```
1 <HTML>
2 <HEAD>
3 <TITLE>Webpage powered by Azure</TITLE>
4 </HEAD>
5 <BODY BGCOLOR="FFFFFF">
6 <H1>Welcome</H1>
7 <P> <B>Hello!</B>
8 <script src="//www.atmrum.net/rum.js"></script>
9 <script>rum.start("0123456789abcdef0123456789abcdff");</script>
10 </BODY>
11 </HTML>
```

Reference:

<https://docs.microsoft.com/en-us/azure/traffic-manager/traffic-manager-create-rum-web-pages>

NEW QUESTION 116

- (Exam Topic 2)

You have two Azure SQL Database managed instances in different Azure regions. You plan to configure the managed instances in an instance failover group. What should you configure before you can add the managed instances to the instance failover group?

- A. Azure Private Link that has endpoints on two virtual networks
- B. an internal Azure Load Balancer instance that has managed instance endpoints in a backend pool
- C. an Azure Application Gateway that has managed instance endpoints in a backend pool
- D. a Site-to-Site VPN between the virtual networks that contain the instances

Answer: D

Explanation:

For two managed instances to participate in a failover group, there must be either ExpressRoute or a gateway configured between the virtual networks of the two managed instances to allow network communication.

You create the two VPN gateways and connect them.

> Create a bidirectional connection between the two gateways of the two virtual networks.

Reference:

<https://docs.microsoft.com/en-us/azure/azure-sql/managed-instance/failover-group-add-instance-tutorial?tabs=az>

NEW QUESTION 119

- (Exam Topic 2)

You are developing an Azure Web App. You configure TLS mutual authentication for the web app.

You need to validate the client certificate in the web app. To answer, select the appropriate options in the answer area.

Property	Value
Client certificate location	<div> <div></div> <div> HTTP request header Client cookie HTTP message body URL query string </div> </div>
Encoding type	<div> <div></div> <div> HTML URL Unicode Base64 </div> </div>

- A. Mastered
- B. Not Mastered

Answer: A

Explanation:

Property	Value
Client certificate location	<div><div></div><div>HTTP request header</div><div>Client cookie</div><div>HTTP message body</div><div>URL query string</div></div>
Encoding type	<div><div></div><div>HTML</div><div>URL</div><div>Unicode</div><div>Base64</div></div>

NEW QUESTION 121

- (Exam Topic 2)

You have an Azure subscription that contains the resources shown in the following table.

Name	Type	Region	Resource group
RG1	Resource group	Central US	<i>Not applicable</i>
RG2	Resource group	West US	<i>Not applicable</i>
VM1	Virtual machine	East US	RG2
VNET1	Virtual network	East US	RG1

In RG2, you need to create a new virtual machine named VM2 that will connect to VNET1. VM2 will use a network interface named VM2_Interface. In which region should you create VM2 and VM2_Interface? To answer, drag the appropriate regions to the correct targets. Each region may be used once, more than once, or not at all. You may need to drag the split bar between panes or scroll to view content.
NOTE: Each correct selection is worth one point.

Regions	Answer Area
<div>Central US</div>	VM2: <div></div>
<div>East US</div>	VM2_Interface: <div></div>
<div>West US</div>	

- A. Mastered
- B. Not Mastered

Answer: A

Explanation:

VM2: West US
In RG2, which is in West US, you need to create a new virtual machine named VM2. VM2_interface: East US
VM2 will use a network interface named VM2_Interface to connect to VNET1, which is in East US. References:
<https://docs.microsoft.com/en-us/azure/virtual-network/associate-public-ip-address-vm>

NEW QUESTION 126

- (Exam Topic 2)

You have an Azure subscription that contains the resources shown in the following table.

Name	Type	Address space
VNET1	Virtual network	10.1.1.0/24
Subnet1	Subnet	10.1.1.0/24
VM1	Virtual machine	<i>Not applicable</i>

Subnet1 is on VNET1. VM1 connects to Subnet1.

You plan to create a virtual network gateway on VNET1.

You need to prepare the environment for the planned virtual network gateway.

What are two ways to achieve this goal? Each correct answer presents a complete solution. NOTE: Each correct selection is worth one point.

- A. Create a subnet named GatewaySubnet on VNET1.
- B. Delete Subnet1.
- C. Modify the address space used by Subnet1.
- D. Modify the address space used by VNET1
- E. Create a local network gateway.

Answer: AD

NEW QUESTION 128

.....

THANKS FOR TRYING THE DEMO OF OUR PRODUCT

Visit Our Site to Purchase the Full Set of Actual AZ-303 Exam Questions With Answers.

We Also Provide Practice Exam Software That Simulates Real Exam Environment And Has Many Self-Assessment Features. Order the AZ-303 Product From:

<https://www.2passeasy.com/dumps/AZ-303/>

Money Back Guarantee

AZ-303 Practice Exam Features:

- * AZ-303 Questions and Answers Updated Frequently
- * AZ-303 Practice Questions Verified by Expert Senior Certified Staff
- * AZ-303 Most Realistic Questions that Guarantee you a Pass on Your FirstTry
- * AZ-303 Practice Test Questions in Multiple Choice Formats and Updatesfor 1 Year