

AZ-303 Dumps

Microsoft Azure Architect Technologies (beta)

<https://www.certleader.com/AZ-303-dumps.html>





NEW QUESTION 1

- (Exam Topic 1)

You need to configure the Device settings to meet the technical requirements and the user requirements. Which two settings should you modify? To answer, select the appropriate settings in the answer area.

Answer Area

 Save  Discard

Users may join devices to Azure AD ⓘ

All Selected None

Selected

No member selected

Additional local administrators on Azure AD joined devices ⓘ

Selected None

Selected

No member selected

Users may register their devices with Azure AD ⓘ

All None

Require Multi-Factor Auth to join devices ⓘ

Yes No

Maximum number of devices per user ⓘ

50

Users may sync settings and app data across devices ⓘ

All Selected None

Selected

No member selected

- A. Mastered
- B. Not Mastered

Answer: A

Explanation:

Box 1: Selected

NEW QUESTION 2

- (Exam Topic 1)

You are planning the move of App1 to Azure. You create a network security group (NSG).

You need to recommend a solution to provide users with access to App1. What should you recommend?

- A. Create an outgoing security rule for port 443 from the Internet to the web servers.
- B. Associate the NSG to all the subnets.
- C. Create an incoming security rule for port 443 from the Internet to the web servers.
- D. Associate the NSG to all the subnets.
- E. Create an incoming security rule for port 443 from the Internet to the database tier.
- F. Associate the NSG to the subnet that contains the web servers.
- G. Create an outgoing security rule for port 443 from the Internet to the database tier.
- H. Associate the NSG to the subnet that contains the web servers.

Answer: C

Explanation:

As App1 is public-facing we need an incoming security rule, related to the access of the web servers. Scenario: You have a public-facing application named App1. App1 is comprised of the following three tiers: a SQL database, a web front end, and a processing middle tier. Each tier is comprised of five virtual machines. Users access the web front end by using HTTPS only.

NEW QUESTION 3

- (Exam Topic 1)

You need to recommend an identity solution that meets the technical requirements.

What should you recommend?

- A. federated single-on (SSO) and Active Directory Federation Services (AD FS)

- B. password hash synchronization and single sign-on (SSO)
- C. cloud-only user accounts
- D. Pass-through Authentication and single sign-on (SSO)

Answer: D

Explanation:

Active Directory Federation Services is a feature and web service in the Windows Server Operating System that allows sharing of identity information outside a company's network.

Scenario: Technical Requirements include:

Prevent user passwords or hashes of passwords from being stored in Azure. References: <https://www.sherweb.com/blog/active-directory-federation-services/>

NEW QUESTION 4

- (Exam Topic 1)

You need to meet the user requirement for Admin1. What should you do?

- A. From the Subscriptions blade, select the subscription, and then modify the Properties.
- B. From the Subscriptions blade, select the subscription, and then modify the Access control (IAM) settings.
- C. From the Azure Active Directory blade, modify the Properties.
- D. From the Azure Active Directory blade, modify the Groups.

Answer: A

Explanation:

Change the Service administrator for an Azure subscription

- Sign in to Account Center as the Account administrator.
- Select a subscription.
- On the right side, select Edit subscription details.

Scenario: Designate a new user named Admin1 as the service administrator of the Azure subscription. References:

<https://docs.microsoft.com/en-us/azure/billing/billing-add-change-azure-subscription-administrator>

NEW QUESTION 5

- (Exam Topic 1)

You need to recommend a solution for App1. The solution must meet the technical requirements. What should you include in the recommendation? To answer, select the appropriate options in the answer area.

NOTE: Each correct selection is worth one point.

Number of virtual networks:

▼

1

2

3

Number of subnets per virtual network:

▼

1

2

3

- A. Mastered
- B. Not Mastered

Answer: A

Explanation:

Box 1: 3

One virtual network for every tier Box 2: 1

Only one subnet for each tier, to minimize the number of open ports.

Scenario: You have a public-facing application named App1. App1 is comprised of the following three tiers: ➤ A SQL database

- A web front end
- A processing middle tier

Each tier is comprised of five virtual machines. Users access the web front end by using HTTPS only. Technical requirements:

- Move all the virtual machines for App1 to Azure.
- Minimize the number of open ports between the App1 tiers.

NEW QUESTION 6

- (Exam Topic 2)

Your network contains an on-premises Active Directory domain named contoso.com. The domain contains the users shown in the following table.

Name	Member of
User1	Domain Admins
User2	Domain Users
User3	ADSyncAdmins
User4	Account Operators

You plan to install Azure AD Connect and enable SSO.

You need to specify which user to use to enable SSO. The solution must use the principle of least privilege. Which user should you specify?

- A. User4
- B. User1
- C. User3
- D. User2

Answer: C

NEW QUESTION 7

- (Exam Topic 2)

You have an Azure SQL database named Db1 that runs on an Azure SQL server named SQLserver1. You need to ensure that you can use the query editor on the Azure portal to query Db1.

What should you do?

- A. Modify the Advanced Data Security settings of Db1
- B. Configure the Firewalls and virtual networks settings for SQLserver1
- C. Copy the ADO.NET connection string of Db1 and paste the string to the query editor
- D. Approve private endpoint connections for SQLserver1

Answer: B

Explanation:

Reference:

<https://docs.microsoft.com/en-us/azure/sql-database/sql-database-connect-query-portal>

NEW QUESTION 8

- (Exam Topic 2)

You have an Azure key vault named KV1.

You need to ensure that applications can use KV1 to provision certificates automatically from an external certification authority (CA).

Which two actions should you perform? Each correct answer presents part of the solution.

NOTE: Each correct selection is worth one point.

- A. From KV1, create a certificate issuer resource.
- B. Obtain the CA account credentials.
- C. Obtain the root CA certificate.
- D. From KV1, create a certificate signing request (CSR).
- E. From KV1, create a private key,

Answer: CD

Explanation:

C: Obtain the root CA certificate (step 4 in the picture below)

D: From KV1, create a certificate signing request (CSR) (step 2 in the picture below) Note:

Creating a certificate with a CA not partnered with Key Vault

This method allows working with other CAs than Key Vault's partnered providers, meaning your organization can work with a CA of its choice.

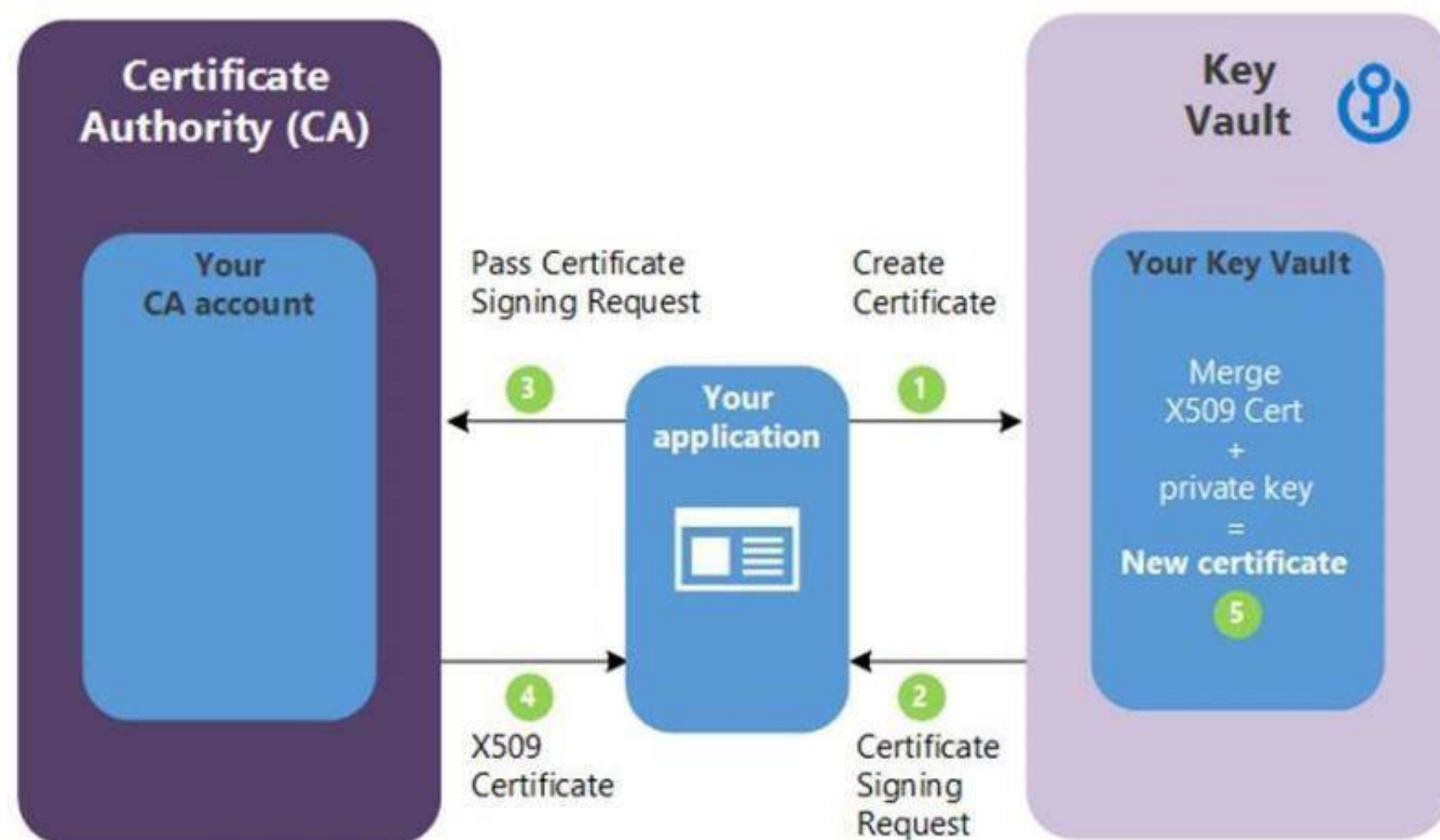

The following step descriptions correspond to the green lettered steps in the preceding diagram.

- In the diagram above, your application is creating a certificate, which internally begins by creating a key in your key vault.
- Key Vault returns to your application a Certificate Signing Request (CSR).
- Your application passes the CSR to your chosen CA.
- Your chosen CA responds with an X509 Certificate.
- Your application completes the new certificate creation with a merger of the X509 Certificate from your CA.

Reference:

<https://docs.microsoft.com/en-us/azure/key-vault/certificates/certificate-scenarios>

NEW QUESTION 9

- (Exam Topic 2)

You have an Azure subscription named Subscription1 that is used by several departments at your company. Subscription1 contains the resources in the following table.

Name	Type
Storage1	Storage account
RG1	Resource group
Container1	Blob container
Share1	File share

Another administrator deploys a virtual machine named VM1 and an Azure Storage account named Storage2 by using a single Azure Resource Manager template. You need to view the template used for the deployment.

From which blade can you view the template that was used for the deployment?

- A. Container1
- B. VM1
- C. Storage2
- D. RG1

Answer: D

NEW QUESTION 10

- (Exam Topic 2)

You create a virtual machine scale set named Scale1. Scale1 is configured as shown in the following exhibit. The subscription contains the Azure SQL databases shown in the following table.

INSTANCES

* Instance count ⓘ

4

* Instance size (View full pricing details) ⓘ

DS1_v2 (1 vCPU, 3.5 GB)

Deploy as low priority ⓘ

NoYes

Use managed disks ⓘ

NoYes

+ Show advanced settings

AUTOSCALE

Autoscale ⓘ

DisabledEnabled

* Minimum number of VMs ⓘ

2

* Maximum number of VMs ⓘ

10

Scale out

* CPU threshold (%) ⓘ

80

* Number of VMs to increase by ⓘ

2

Scale in

* CPU threshold (%) ⓘ

30

* Number of VMs to decrease by ⓘ

4

Use the drop-down menus to select the answer choice that completes each statement based on the information presented in the graphic.
NOTE: Each correct selection is worth one point.

If Scale1 is utilized at 85 percent for six minutes, Scale1 will be running [answer choice].

2 virtual machines

4 virtual machines

6 virtual machines

8 virtual machines

10 virtual machines

If Scale1 is first utilized at 25 percent for six minutes, and then utilized at 50 percent for six minutes, Scale1 will be running [answer choice].

2 virtual machines

4 virtual machines

6 virtual machines

8 virtual machines

10 virtual machines

A. Mastered
B. Not Mastered

Answer: A

Explanation:

Box 1:
The Autoscale scale out rule increases the number of VMs by 2 if the CPU threshold is 80% or higher. The initial instance count is 4 and rises to 6 when the 2 extra instances of VMs are added.

Box 2:
The Autoscale scale in rule decreases the number of VMs by 4 if the CPU threshold is 30% or lower. The initial instance count is 4 and thus cannot be reduced to 0 as the minimum instances is set to 2. Instances are only added when the CPU threshold reaches 80%.

References:
<https://docs.microsoft.com/en-us/azure/azure-monitor/platform/autoscale-overview>
<https://docs.microsoft.com/en-us/azure/azure-monitor/platform/autoscale-best-practices> <https://docs.microsoft.com/en-us/azure/azure-monitor/platform/autoscale-common-scale-patterns>

NEW QUESTION 10

- (Exam Topic 2)
You create a new Azure subscription. You create a resource group named RG1. In RG1, you create the resources shown in the following table.

The Leader of IT Certification

visit - <https://www.certleader.com>

Name	Type
VNET1	Virtual network
VM1	Virtual machine
GWSN1	Gateway subnet
VPNGW1	Virtual network gateway

You need to configure an encrypted tunnel between your on-premises network and VNET1.
Which two additional resources should you create in Azure? Each correct answer presents part of the solution.

- A. a point-to-site configuration
- B. a local network gateway
- C. a VNet-to-VNet connection
- D. a VPN gateway
- E. a site-to-site connection

Answer: DE

Explanation:

A Site-to-Site VPN gateway connection is used to connect your on-premises network to an Azure virtual network over an IPsec/IKE (IKEv1 or IKEv2) VPN tunnel. This type of connection requires a VPN device, a local network gateway, located on-premises that has an externally facing public IP address assigned to it. Finally, create a Site-to-Site VPN connection between your virtual network gateway and your on-premises VPN device.

References:

<https://docs.microsoft.com/en-us/azure/vpn-gateway/vpn-gateway-howto-site-to-site-resource-manager-portal>

NEW QUESTION 12

- (Exam Topic 2)

You have a virtual network named VNet1 as shown in the exhibit.

Refresh
 Move
 Delete

Resource group (change) Production	Address space 10.2.0.0/16
Location West US	DNS servers Azure provided DNS service
Subscription (change) Production subscription	
Subscription ID 14d26092-8e42-4ea7-b770-9dcef70fb1ea	
Tags (change) Click here to add tags	

Connected devices

Search connected devices

Device	Type	Ip Address	Subnet
No results.			

No devices are connected to VNet1.
You plan to peer VNet1 to another virtual network named Vnet2 in the same region. VNet2 has an address space of 10.2.0.0/16.
You need to create the peering. What should you do first?

- A. Modify the address space of VNet1.
- B. Configure a service endpoint on VNet2
- C. Add a gateway subnet to VNet1.
- D. Create a subnet on VNet1 and VNet2.

Answer: A

Explanation:

The virtual networks you peer must have non-overlapping IP address spaces. References:

<https://docs.microsoft.com/en-us/azure/virtual-network/virtual-network-manage-peering#requirements-and-cons>

NEW QUESTION 15

- (Exam Topic 2)

You have an Azure subscription that contains the storage accounts shown in the following table.

Name	Contains
storagecontoso1	A blob service and a table service
storagecontoso2	A blob service and a file service
storagecontoso3	A queue service
storagecontoso4	A file service and a queue service
storagecontoso5	A table service

You enable Azure Advanced Threat Protection (ATP) for all the storage accounts. You need to identify which storage accounts will generate Azure ATP alerts. Which two storage accounts should you identify? Each correct answer presents part of the solution. NOTE: Each correct selection is worth one point.

- A. storagecontoso1
- B. storagecontoso2
- C. storagecontoso3
- D. storagecontoso4
- E. storaacontoso5

Answer: AB

Explanation:

Advanced threat protection for Azure Storage is currently available only for Blob Storage.

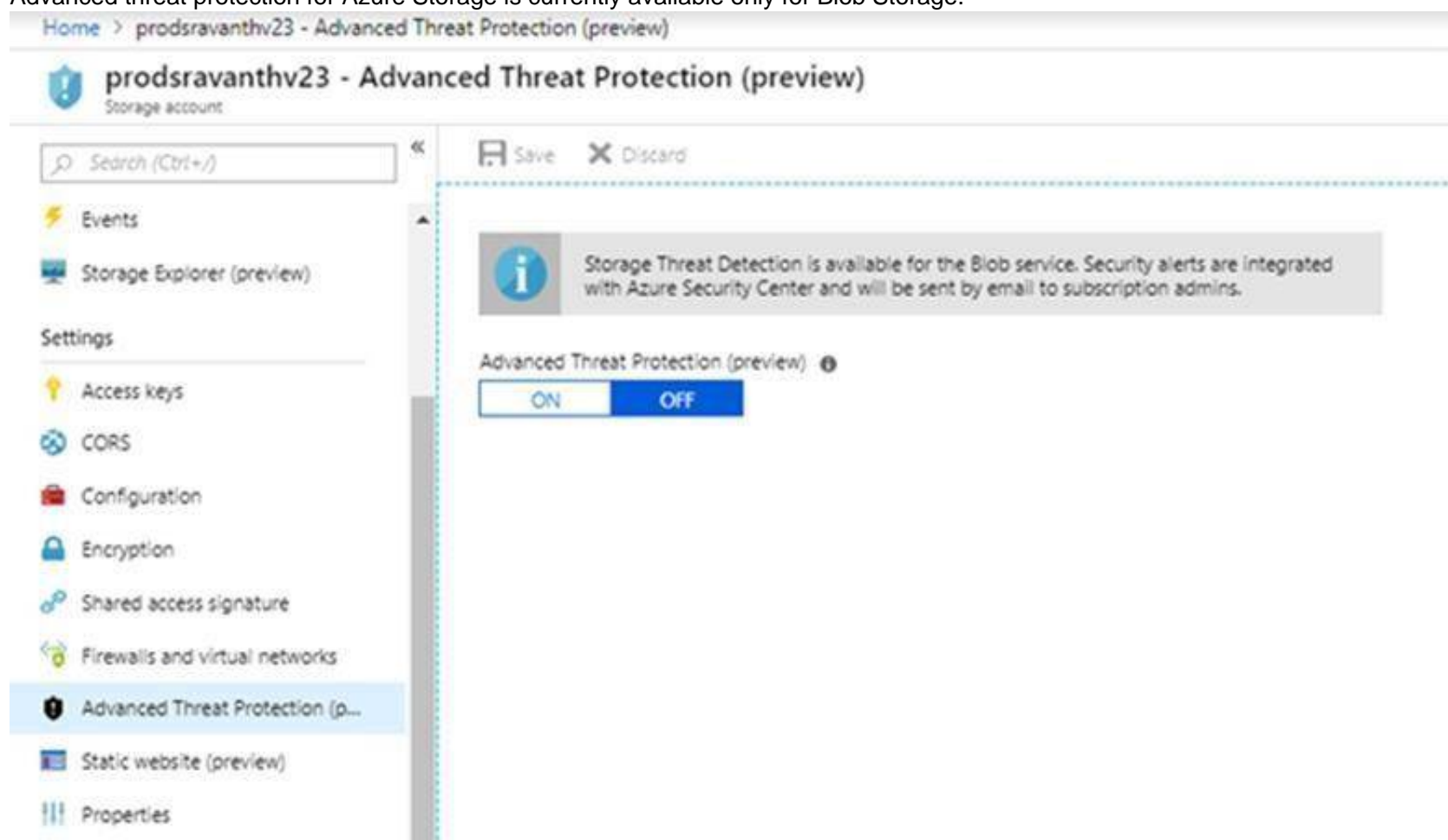

<https://docs.microsoft.com/en-us/azure/storage/common/storage-advanced-threat-protection?tabs=azure-portal>

NEW QUESTION 20

- (Exam Topic 2)

Your company has a virtualization environment that contains the virtualization hosts shown in the following table.

Name	Hypervisor	Guest
Server1	VMware	VM1, VM2, VM3
Server2	Hyper-V	VMA, VMB, VMC

The virtual machines are configured as shown in the following table.

Name	Generation	Memory	Operating system (OS)	OS disk	Data disk
VM1	Not applicable	4 GB	Windows Server 2016	200 GB	800 GB
VM2	Not applicable	12 GB	Red Hat Enterprise Linux 7.2	3 TB	200 GB
VM3	Not applicable	32 GB	Windows Server 2012 R2	200 GB	1 TB
VMA	1	8 GB	Windows Server 2012	100 GB	2 TB
VMB	1	16 GB	Red Hat Enterprise Linux 7.2	150 GB	3 TB
VMC	2	24 GB	Windows Server 2016	500 GB	6 TB

All the virtual machines use basic disks. VM1 is protected by using BitLocker Drive Encryption (BitLocker). You plan to migrate the virtual machines to Azure by using Azure Site Recovery.

You need to identify which virtual machines can be migrated.

Which virtual machines should you identify for each server? To answer, select the appropriate options in the answer area.
NOTE: Each correct selection is worth one point.

The virtual machines that can be migrated from Server1.

VM1 only
VM2 only
VM3 only
VM1 and VM2 only
VM1 and VM3 only
VM1, VM2, and VM3

The virtual machines that can be migrated from Server2.

VMA only
VMB only
VMC only
VMA and VMB only
VMA and VMC only
VMA, VMB, and VMC

- A. Mastered
- B. Not Mastered

Answer: A

Explanation:

The virtual machines that can be migrated from Server1.

VM1 only
VM2 only
VM3 only
VM1 and VM2 only
VM1 and VM3 only
VM1, VM2, and VM3

The virtual machines that can be migrated from Server2.

VMA only
VMB only
VMC only
VMA and VMB only
VMA and VMC only
VMA, VMB, and VMC

NEW QUESTION 21

- (Exam Topic 2)

An administrator plans to create a function app in Azure that will have the following settings:

- Runtime stack: .NET Core
- Operating System: Linux
- Plan type: Consumption
- Enable Application Insights: Yes

You need to ensure that you can back up the function app.

Which settings should you recommend changing before creating the function app? D18912E1457D5D1DDCBD40AB3BF70D5D

- A. Runtime stack
- B. Enable Application Insights
- C. Operating System
- D. Plan type

Answer: D

Explanation:

The Backup and Restore feature requires the App Service plan to be in the Standard, Premium or Isolated tier. Reference:
<https://docs.microsoft.com/en-us/azure/app-service/manage-backup#requirements-and-restrictions>

NEW QUESTION 22

- (Exam Topic 2)

You have an Azure subscription that contains 10 virtual machines on a virtual network.

You need to create a graph visualization to display the traffic flow between the virtual machines. What should you do from Azure Monitor?

- A. From Activity log, use quick insights.
- B. From Metrics, create a chart.
- C. From Logs, create a new query.
- D. From Workbooks, create a workbook.

Answer: C

Explanation:

Navigate to Azure Monitor and select Logs to begin querying the data Reference:

<https://azure.microsoft.com/en-us/blog/analysis-of-network-connection-data-with-azure-monitor-for-virtual-mac>

NEW QUESTION 23

- (Exam Topic 2)

You are implementing authentication for applications in your company. You plan to implement self-service password reset (SSPR) and multifactor authentication (MFA) in Azure Active Directory (Azure AD).

You need to select authentication mechanisms that can be used for both MFA and SSPR.

Which two authentication methods should you use? Each correct answer presents a complete solution. NOTE: Each correct selection is worth one point.

- A. Short Message Service (SMS) messages
- B. Authentication app
- C. Email addresses
- D. Security questions
- E. App passwords

Answer: AB

Explanation:

References:

<https://docs.microsoft.com/en-us/azure/active-directory/authentication/concept-authentication-methods>

NEW QUESTION 27

- (Exam Topic 2)

You plan to create an Azure Storage account named storage1 that will store blobs and be accessed by Azure Databricks.

You need to ensure that you can set permissions for individual blobs by using Azure Active Directory (Azure AD) authentication.

Which Advanced setting should you enable for storage1?

- A. Hierarchical namespace
- B. Large file shares
- C. Blob soft delete
- D. NFSv3

Answer: C

NEW QUESTION 31

- (Exam Topic 2)

You have an Azure Active Directory (Azure AD) tenant linked to an Azure subscription. The tenant contains a group named Admins.

You need to prevent users, except for the members of Admins, from using the Azure portal and Azure PowerShell to access the subscription.

What should you do?

- A. From Azure AD, configure the User settings.
- B. From the Azure subscription, assign an Azure policy.
- C. From Azure AD, create a conditional access policy.
- D. From the Azure subscription, configure Access control (IAM).

Answer: D

NEW QUESTION 33

- (Exam Topic 2)

You plan to deploy an Azure virtual machine named VM1 by using an Azure Resource Manager template. You need to complete the template.

What should you include in the template? To answer, select the appropriate options in the answer area.

NOTE: Each correct selection is worth one point.

```
{
  "type": "Microsoft.Compute/virtualMachines",
  "apiVersion": "2018-10-01",
  "name": "VM1",
  "location": "[parameters('location')]",
  "dependsOn": [
    "[resourceId('Microsoft.Storage/storageAccounts/', variables('Name3'))]",
    "[resourceId(
```

Microsoft.Network/publicIPAddresses/
Microsoft.Network/virtualNetworks/
Microsoft.Network/networkInterfaces/
Microsoft.Network/virtualNetworks/subnets
Microsoft.Storage/storageAccounts/

```
],
  "type": "Microsoft.Network/networkInterfaces",
  "apiVersion": "2018-11-01",
  "name": "NIC1",
  "location": "[parameters('location')]",
  "dependsOn": [
    "[resourceId('Microsoft.Network/publicIPAddresses/', variables('Name1'))]",
    "[resourceId(
```

Microsoft.Network/publicIPAddresses/
Microsoft.Network/virtualNetworks/
Microsoft.Network/networkInterfaces/
Microsoft.Network/virtualNetworks/subnets
Microsoft.Storage/storageAccounts/

- A. Mastered
B. Not Mastered

Answer: A

Explanation:

Within your template, the dependsOn element enables you to define one resource as a dependent on one or more resources. Its value can be a comma-separated list of resource names.

Box 1: 'Microsoft.Network/networkInterfaces'

This resource is a virtual machine. It depends on two other resources: Microsoft.Storage/storageAccounts Microsoft.Network/networkInterfaces

Box 2: 'Microsoft.Network/virtualNetworks'

The dependsOn element enables you to define one resource as a dependent on one or more resources. The resource depends on two other resources:

Microsoft.Network/publicIPAddresses Microsoft.Network/virtualNetworks

```
"resources": [
  {
  },
  {
  },
  {
  },
  {
  },
  {
    "type": "Microsoft.Network/networkInterfaces",
    "name": "[variables('nicName')]",
    "location": "[parameters('location')]",
    "apiVersion": "2018-08-01",
    "dependsOn": [
      "[resourceId('Microsoft.Network/publicIPAddresses/', variables('publicIPAddressName'))]",
      "[resourceId('Microsoft.Network/virtualNetworks/', variables('virtualNetworkName'))]"
    ],
    "properties": {
      "ipConfigurations": [
        {
          "name": "ipconfig1",
          "properties": {
            "privateIPAllocationMethod": "Dynamic",
            "publicIPAddress": {
              "id": "[resourceId('Microsoft.Network/publicIPAddresses', variables('publicIPAddressName'))]"
            },
            "subnet": {
              "id": "[variables('subnetRef')]"
            }
          }
        }
      ]
    }
  }
],
}
```

References:

<https://docs.microsoft.com/en-us/azure/azure-resource-manager/resource-manager-tutorial-create-templates-with>

NEW QUESTION 38

- (Exam Topic 2)

You have three Azure SQL Database servers shown in the following table.

Name	Resource group	Location
sqlserver1	RG1	West US
sqlserver2	RG1	West US
sqlserver3	RG2	West US
sqlserver4	RG1	West Europe
sqlserver5	RG2	West Europe

You plan to specify sqlserver1 as the primary server in a failover group. Which servers can be used as a secondary server?

- A. sqlserver4 and sqlserver5 only
- B. sqlserver2 and sqlserver3 only
- C. sqlserver1 and sqlserver3 only
- D. sqlserver2 and sqlserver4 only

Answer: D

Explanation:

The Resource Group must be the same.

The secondary server can have another location.

The secondary server cannot be the same as the primary server. Reference:

<https://docs.microsoft.com/en-us/azure/azure-sql/database/auto-failover-group-configure>

NEW QUESTION 42

- (Exam Topic 2)

You create an Azure virtual machine named VM1 in a resource group named RG1. You discover that VM1 performs slower than expected.

You need to capture a network trace on VM1. What should you do?

- A. From Diagnostic settings for VM1, configure the performance counters to include network counters.
- B. From the VM1 blade, configure Connection troubleshoot.
- C. From the VM1 blade, install performance diagnostics and run advanced performance analysis
- D. From Diagnostic settings for VM1, configure the log level of the diagnostic agent.

Answer: C

Explanation:

The performance diagnostics tool helps you troubleshoot performance issues that can affect a Windows or Linux virtual machine (VM). Supported troubleshooting

scenarios include quick checks on known issues and best practices, and complex problems that involve slow VM performance or high usage of CPU, disk space, or memory.

Advanced performance analysis, included in the performance diagnostics tool, includes all checks in the performance analysis, and collects one or more of the traces, as listed in the following sections. Use this scenario to troubleshoot complex issues that require additional traces. Running this scenario for longer periods will increase the overall size of diagnostics output, depending on the size of the VM and the trace options that are selected.

References:

<https://docs.microsoft.com/en-us/azure/virtual-machines/troubleshooting/performance-diagnostics>

NEW QUESTION 47

- (Exam Topic 2)

Note: This question is part of series of questions that present the same scenario. Each question in the series contains a unique solution that might meet the stated goals. Some question sets might have more than one correct solution, while others might not have a correct solution.

After you answer a question in this section, you will NOT be able to return to it. As a result, these questions will not appear in the review screen.

You have an Azure Active Directory (Azure AD) tenant named contoso.com.

A user named Admin1 attempts to create an access review from the Azure Active Directory admin center and discovers that the Access reviews settings are unavailable. Admin1 discovers that all the other Identity Governance settings are available.

Admin1 is assigned the User administrator, Compliance administrator, and Security administrator roles. You need to ensure that Admin1 can create access reviews in contoso.com.

Solution: You assign the Service administrator role to Admin1. Does this meet the goal?

- A. Yes
- B. No

Answer: B

Explanation:

Instead use Azure AD Privileged Identity Management.

Note: PIM essentially helps you manage the who, what, when, where, and why for resources that you care about. Key features of PIM include:

- Conduct access reviews to ensure users still need roles
- References:

<https://docs.microsoft.com/en-us/azure/active-directory/privileged-identity-management/pim-configure>

NEW QUESTION 52

- (Exam Topic 2)

You have an Azure subscription that contains an Azure Log Analytics workspace. You have a resource group that contains 100 virtual machines. The virtual machines run Linux. You need to collect events from the virtual machines to the Log Analytics workspace. Which type of data source should you configure in the workspace?

- A. Syslog
- B. Linux performance counters
- C. custom fields

Answer: A

Explanation:

<https://docs.microsoft.com/en-us/azure/azure-monitor/learn/quick-collect-azurevm>

Syslog is an event logging protocol that is common to Linux. Applications will send messages that may be stored on the local machine or delivered to a Syslog collector. When the Log Analytics agent for Linux is installed, it configures the local Syslog daemon to forward messages to the agent. The agent then sends the message to Azure Monitor where a corresponding record is created.

Reference:

<https://docs.microsoft.com/en-us/azure/azure-monitor/platform/data-sources-custom-logs>

NEW QUESTION 53

- (Exam Topic 2)

You have an Azure subscription named Subscription1 that contains an Azure virtual network named VNet1. VNet1 connects to your on-premises network by using Azure ExpressRoute.

You need to connect VNet1 to the on-premises network by using a site-to-site VPN. The solution must minimize cost.

Which three actions should you perform? Each correct answer presents part of the solution.

NOTE: Each correct selection is worth one point.

- A. Create a VPN gateway that uses the VpnGw1 SKU.
- B. Create a connection.
- C. Create a local site VPN gateway.
- D. Create a gateway subnet.
- E. Create a VPN gateway that uses the Basic SKU.

Answer: ABC

Explanation:

References:

<https://docs.microsoft.com/en-za/archive/blogs/canitpro/step-by-step-configuring-a-site-to-site-vpn-gateway-bet>

NEW QUESTION 56

- (Exam Topic 2)

Note: This question is part of a series of questions that present the same scenario. Each question in the series contains a unique solution that might meet the stated goals. Some question sets might have more than one correct solution, while others might not have a correct solution.

After you answer a question in this section, you will NOT be able to return to it. As a result, these questions will not appear in the review screen.

Your company is deploying an on-premises application named Appl. Users will access App1 by using a URL of <https://app1.contoso.com>. You register App1 in Azure Active Directory (Azure AD) and publish Appl by using the Azure AD Application Proxy. You need to ensure that Appl appears in the My Apps portal for all

the users.

Solution: You create an offer for App1 and publish the offer to Azure Marketplace.

- A. Yes
- B. No

Answer: A

NEW QUESTION 58

- (Exam Topic 2)

You have an on-premises virtual machine named VM1 configured as shown in the following exhibit.

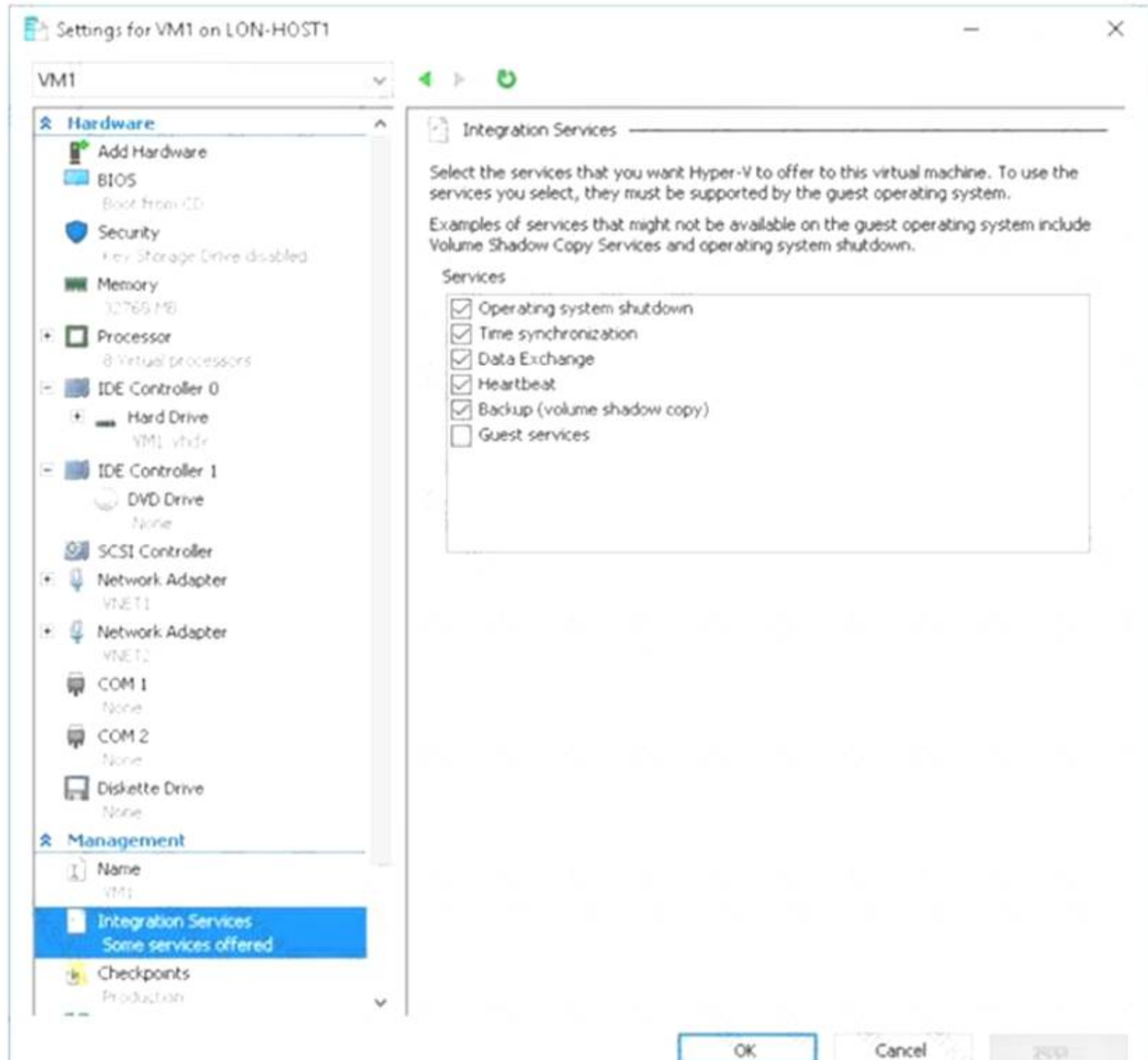

VM is started.

You need to create a new virtual machine image in Azure from VM1.

Which three actions should you perform before you create the new image? Each correct answer presents part of the solution.

NOTE: Each correct selection is worth one point.

- A. Remove the Backup (volume shadow copy) integration service
- B. Generalize VM1
- C. Run Add-AzureRmVhd and specify a blob service container as the destination
- D. Run Add-AzureRmVhd and specify a file share as the destination
- E. Reduce the amount of memory to 16 GB
- F. Convert the disk type to VHD

Answer: BCF

NEW QUESTION 60

- (Exam Topic 2)

You have an Azure virtual machine named VM1 and an Azure Active Directory (Azure AD) tenant named adatum.com.

D18912E1457D5D1DDCBD40AB3BF70D5D

VM1 has the following settings:

- > IP address: 10.10.0.10
- > System-assigned managed identity: On

You need to create a script that will run from within VM1 to retrieve the authentication token of VM1. Which address should you use in the script?

- A. vm1.adatum.com.onmicrosoft.com
- B. 169.254.169.254
- C. 10.10.0.10
- D. vm1.adatum.com

Answer: B

Explanation:

Your code that's

running on the VM can request a token from the Azure Instance Metadata Service identity endpoint, accessible only from within the VM:

<http://169.254.169.254/metadata/identity/oauth2/token>

Reference:

<https://docs.microsoft.com/en-us/azure/active-directory/managed-identities-azure-resources/overview>

NEW QUESTION 65

- (Exam Topic 2)

You create a container image named Image1 on a developer workstation.

You plan to create an Azure Web App for Containers named WebAppContainer that will use Image1. You need to upload Image1 to Azure. The solution must ensure that WebAppContainer can use Image1. To which storage type should you upload Image1?

- A. Azure Container Registry
- B. an Azure Storage account that contains a blob container
- C. an Azure Storage account that contains a file share
- D. Azure Container Instances

Answer: A

Explanation:

Configure registry credentials in web app.

App Service needs information about your registry and image to pull the private image. In the Azure portal, go to Container settings from the web app and update the Image source, Registry and save.

References:

<https://docs.microsoft.com/en-us/azure/devops/pipelines/targets/webapp-on-container-linux>

NEW QUESTION 69

- (Exam Topic 2)

Your company has an Azure subscription.

You enable multi-factor authentication (MFA) for all users.

The company's help desk reports an increase in calls from users who receive MFA requests while they work from the company's main office.

You need to prevent the users from receiving MFA requests when they sign in from the main office. What should you do?

- A. From Azure Active Directory (Azure AD), configure organizational relationships.
- B. From the MFA service settings, create a trusted IP range.
- C. From Conditional access in Azure Active Directory (Azure AD), create a custom control.
- D. From Conditional access in Azure Active Directory (Azure AD), create a named location.

Answer: B

Explanation:

The first thing you may want to do, before enabling Multi-Factor Authentication for any users, is to consider configuring some of the available settings. One of the most important features is a trusted IPs list. This will allow you to whitelist a range of IPs for your network. This way, when users are in the office, they will not get prompted with MFA, and when they take their devices elsewhere, they will. Here's how to do it:

Log in to your Azure Portal.

Navigate to Azure AD > Conditional Access > Named locations. From the top toolbar select Configure MFA trusted IPs. References:

<https://www.kraftkennedy.com/implementing-azure-multi-factor-authentication/>

NEW QUESTION 72

- (Exam Topic 2)

You have the virtual machines shown in the following table.

Name	Operating system	Connected to
VM1	Red Hat Enterprise Linux 7.7	VNET1
VM2	Windows Server 2019	VNET2
VM3	Windows Server 2019	VNET3

You deploy an Azure bastion named Bastion1 to VNET1.

To which virtual machines can you connect by using Bastion1?

- A. VM1 only
- B. VM1 and VM2 only
- C. VM2 and VM3 only
- D. VM1, VM2, and VM3

Answer: C

NEW QUESTION 76

- (Exam Topic 2)

You have an Azure Kubernetes Service (AKS) cluster named Clus1 in a resource group named RG1. An administrator plans to manage Clus1 from an Azure AD-joined device.

You need to ensure that the administrator can deploy the YAML application manifest file for a container application.

You install the Azure CLI on the device. Which command should you run next?

- A. kubectl get nodes
- B. az aks install-cli
- C. kubectl apply -f app1.yaml
- D. az aks get-credentials --resource-group RG1 --name Clus1

Answer: C

Explanation:

kubectl apply -f appl.yaml applies a configuration change to a resource from a file or stdin. References:

<https://kubernetes.io/docs/reference/kubectl/overview/> <https://docs.microsoft.com/en-us/cli/azure/aks>

NEW QUESTION 81

- (Exam Topic 2)

You create the following Azure role definition.

```
{
  "Name": "Role1",
  "Id": "80808080-8080-8080-8080-808080808080",
  "IsCustom": false,
  "Description": "",
  "Actions": [
    "Microsoft.Storage/*/read",
    "Microsoft.Network/*/read",
    "Microsoft.Compute/virtualMachines/start/action",
    "Microsoft.Compute/virtualMachines/restart/action",
    "Microsoft.Authorization/*/read"],
  "NotActions": [ ],
  "DataActions": [ ],
  "NotDataActions": [ ],
  "AssignableScopes": [ ]
}
```

You need to create Role1 by using the role definition.

Which two values should you modify before you create Role1? Each correct answer presents part of the solution.

NOTE: Each correct selection is worth one point.

- A. AssignableScopes
- B. Description
- C. DataActions
- D. IsCustom
- E. Id

Answer: AD

Explanation:

Part of example: "IsCustom": true,

"AssignableScopes": ["/subscriptions/{subscriptionId1}", "/subscriptions/{subscriptionId2}",

"/subscriptions/{subscriptionId3}"

The following shows what a custom role looks like as displayed in JSON format. This custom role can be used for monitoring and restarting virtual machines.

```
{
  "Name": "Virtual Machine Operator",
  "Id": "88888888-8888-8888-8888-888888888888",
  "IsCustom": true,
  "Description": "Can monitor and restart virtual machines.", "Actions": [
    "Microsoft.Storage/*/read", "Microsoft.Network/*/read", "Microsoft.Compute/*/read", "Microsoft.Compute/virtualMachines/start/action",
    "Microsoft.Compute/virtualMachines/restart/action", "Microsoft.Authorization/*/read", "Microsoft.ResourceHealth/availabilityStatuses/read",
    "Microsoft.Resources/subscriptions/resourceGroups/read", "Microsoft.Insights/alertRules/*", "Microsoft.Insights/diagnosticSettings/*", "Microsoft.Support/*"
  ],
  "NotActions": [],
  "DataActions": [], "NotDataActions": [], "AssignableScopes": [ "/subscriptions/{subscriptionId1}",
    "/subscriptions/{subscriptionId2}", "/subscriptions/{subscriptionId3}"
  ]
}
```

Reference:

<https://docs.microsoft.com/en-us/azure/role-based-access-control/custom-roles>

NEW QUESTION 82

- (Exam Topic 2)

You have a web server app named App1 that is hosted in three Azure regions. You plan to use Azure Traffic Manager to distribute traffic optimally for App1.

You need to enable Real User Measurements to monitor the network latency data for App1. What should you do? To answer, select the appropriate options in the answer area.

NOTE: Each correct selection is worth one point.

From the Traffic Manager profile:

▼

Select Generate key.

Enable Traffic view.

Configure the Diagnostics settings.

Add a custom header.

From App1:

▼

Embed the Traffic Manager JavaScript code snippet.

Embed the Azure Application Insights JavaScript code snippet.

Configure the Diagnostics settings.

Configure the Application settings.

- A. Mastered
B. Not Mastered

Answer: A

Explanation:

Box 1: Select Generate key

You can configure your web pages to send Real User Measurements to Traffic Manager by obtaining a Real User Measurements (RUM) key and embedding the generated code to web page.

Obtain a Real User Measurements key

The measurements you take and send to Traffic Manager from your client application are identified by the service using a unique string, called the Real User Measurements (RUM) Key. You can get a RUM key using the Azure portal, a REST API, or by using the PowerShell or Azure CLI.

To obtain the RUM Key using Azure portal:

- From a browser, sign in to the Azure portal. If you don't already have an account, you can sign up for a free one-month trial.
- In the portal's search bar, search for the Traffic Manager profile name that you want to modify, and then click the Traffic Manager profile in the results that the displayed.
- In the Traffic Manager profile blade, click Real User Measurements under Settings.
- Click Generate Key to create a new RUM Key.

Box 2: Embed the Traffic Manager JavaScript code snippet. Embed the code to an HTML web page

After you have obtained the RUM key, the next step is to embed this copied JavaScript into an HTML page that your end users visit.

This example shows how to update an HTML page to add this script. You can use this guidance to adapt it to your HTML source management workflow.

- Open the HTML page in a text editor
- Paste the JavaScript code you had copied in the earlier step to the BODY section of the HTML (the copied code is on line 8 & 9, see figure 3).

```

1 <HTML>
2 <HEAD>
3 <TITLE>Webpage powered by Azure</TITLE>
4 </HEAD>
5 <BODY BGCOLOR="FFFFFF">
6 <H1>Welcome</H1>
7 <P> <B>Hello!</B>
8 <script src="//www.atmrum.net/rum.js"></script>
9 <script>rum.start("0123456789abcdef0123456789abcdff");</script>
10 </BODY>
11 </HTML>

```

Reference:

<https://docs.microsoft.com/en-us/azure/traffic-manager/traffic-manager-create-rum-web-pages>

NEW QUESTION 87

- (Exam Topic 2)

You have an Azure Active Directory (Azure AD) tenant that contains the user groups shown in the following table.

Name	Role	Member of
User1	Global administrator	None
User2	User administrator	Group1
User3	Password administrator	Group1
User4	None	Group1

You enable self-service password reset (SSPR) for Group1.

You configure the Notifications settings as shown in the following exhibit.

 Save  Discard

Notify users on password resets? ⓘ

Yes No

Notify all admins when other admins reset their password? ⓘ

Yes No

For each of the following statements, select Yes if the statement is true. Otherwise, select No.

Statements	Yes	No
User1 gets a notification when User3 resets her password by using SSPR.	<input type="radio"/>	<input type="radio"/>
User3 gets a notification when User3 resets her password by using SSPR.	<input type="radio"/>	<input type="radio"/>
User1 gets a notification when User2 resets the password of User4.	<input type="radio"/>	<input type="radio"/>

- A. Mastered
B. Not Mastered

Answer: A

Explanation:

Box 1: Yes

Notify all admins when other admins reset their passwords: Yes. Box 2: No

Notify users on password resets: No. Box 3: No

➤ Notify users on password resets

If this option is set to Yes, then users resetting their password receive an email notifying them that their password has been changed. The email is sent via the SSPR portal to their primary and alternate email addresses that are on file in Azure AD. No one else is notified of the reset event.

➤ Notify all admins when other admins reset their passwords

If this option is set to Yes, then all administrators receive an email to their primary email address on file in Azure AD. The email notifies them that another administrator has changed their password by using SSPR.

Example: There are four administrators in an environment. Administrator A resets their password by using SSPR. Administrators B, C, and D receive an email alerting them of the password reset.

Reference:

<https://docs.microsoft.com/en-us/azure/active-directory/authentication/concept-sspr-howitworks> <https://docs.microsoft.com/en-us/azure/active-directory/authentication/tutorial-enable-sspr>

NEW QUESTION 89

- (Exam Topic 2)

The developers at your company request that you create databases in Azure Cosmos DB as shown in the following table.

Name	Requirement
CosmosDB1	<ul style="list-style-type: none"> Provides a throughput of 1,200 RU/s Has multiple write regions Uses the Core (SQL) API
CosmosDB2	<ul style="list-style-type: none"> Provides a throughput of 800 RU/s Uses the MongoDB API
CosmosDB3	<ul style="list-style-type: none"> Provides a throughput of 1,200 RU/s Has only one write region Uses the Core (SQL) API
CosmosDB4	<ul style="list-style-type: none"> Provides a throughput of 2,000 RU/s Uses the MongoDB API

You need to create the Azure Cosmos DB databases to meet the developer request. The solution must minimize costs.

What are two possible ways to achieve the goal? Each correct answer presents a complete solution.

NOTE: Each correct selection is worth one point.

- A. Create three Azure Cosmos DB accounts, one for the databases that use the Core (SQL) API, one for CosmosDB2, and one for CosmosDB4.
B. Create two Azure Cosmos DB accounts, one for CosmosDB2 and CosmosDB4 and one for CosmosDB1 and CosmosDB3.
C. Create one Azure Cosmos DB account for each database.

D. Create three Azure Cosmos DB accounts, one for the databases that use the MongoDB API, one for CosmosDB1, and one for CosmosDB3.

Answer: BD

Explanation:

Note:

Microsoft recommends using the same API for all access to the data in a given account.

One throughput provisioned container per subscription for SQL, Gremlin API, and Table accounts. Up to three throughput provisioned collections per subscription for MongoDB accounts.

The throughput provisioned on an Azure Cosmos container is exclusively reserved for that container. The container receives the provisioned throughput all the time.

Reference:

<https://docs.microsoft.com/en-us/azure/cosmos-db/set-throughput#set-throughput-on-a-container>

NEW QUESTION 90

- (Exam Topic 2)

You have an Azure subscription that contains the resources shown in the following table.

Name	Type	Address space
VNET1	Virtual network	10.1.1.0/24
Subnet1	Subnet	10.1.1.0/24
VM1	Virtual machine	<i>Not applicable</i>

Subnet1 is on VNET1. VM1 connects to Subnet1.

You plan to create a virtual network gateway on VNET1.

You need to prepare the environment for the planned virtual network gateway.

What are two ways to achieve this goal? Each correct answer presents a complete solution. NOTE: Each correct selection is worth one point.

- A. Create a subnet named GatewaySubnet on VNET1.
- B. Delete Subnet1.
- C. Modify the address space used by Subnet1.
- D. Modify the address space used by VNET1
- E. Create a local network gateway.

Answer: AD

NEW QUESTION 94

- (Exam Topic 2)

Note: This question is part of series of questions that present the same scenario. Each question in the series contains a unique solution that might meet the stated goals. Some question sets might have more than one correct solution, while others might not have a correct solution.

After you answer a question in this section, you will NOT be able to return to it. As a result, these questions will not appear in the review screen.

You have a server named Server1 that runs Windows Server 2019. Server1 is a container host. You are creating a Dockerfile to build a container image.

You need to add a file named File1.txt from Server1 to a folder named C:\Folder1 in the container image. Solution: You add the following line to the Dockerfile.

Copy-Item File1.txt C:\Folder1\File1.txt You then build the container image. Does this meet the goal?

- A. Yes
- B. No

Answer: B

Explanation:

Copy-Item is not supported. Copy is the correct command to copy a file to the container image. References:

https://docs.docker.com/develop/develop-images/dockerfile_best-practices/#add-or-copy <https://docs.docker.com/engine/reference/builder/>

NEW QUESTION 95

.....

Thank You for Trying Our Product

* 100% Pass or Money Back

All our products come with a 90-day Money Back Guarantee.

* One year free update

You can enjoy free update one year. 24x7 online support.

* Trusted by Millions

We currently serve more than 30,000,000 customers.

* Shop Securely

All transactions are protected by VeriSign!

100% Pass Your AZ-303 Exam with Our Prep Materials Via below:

<https://www.certleader.com/AZ-303-dumps.html>