



VEEAM

Exam Questions VMCE_v12

Veeam Certified Engineer v12

About ExamBible

[Your Partner of IT Exam](#)

Found in 1998

ExamBible is a company specialized on providing high quality IT exam practice study materials, especially Cisco CCNA, CCDA, CCNP, CCIE, Checkpoint CCSE, CompTIA A+, Network+ certification practice exams and so on. We guarantee that the candidates will not only pass any IT exam at the first attempt but also get profound understanding about the certificates they have got. There are so many alike companies in this industry, however, ExamBible has its unique advantages that other companies could not achieve.

Our Advances

* 99.9% Uptime

All examinations will be up to date.

* 24/7 Quality Support

We will provide service round the clock.

* 100% Pass Rate

Our guarantee that you will pass the exam.

* Unique Gurantee

If you do not pass the exam at the first time, we will not only arrange FULL REFUND for you, but also provide you another exam of your claim, ABSOLUTELY FREE!

NEW QUESTION 1

An administrator needs to configure a backup job that dynamically adds new VMware hosted SQL servers. How can this be accomplished?

- A. Create a job based on vSphere tags.
- B. Enable application aware processing.
- C. Create a CSV file that is scanned before the backup job starts.
- D. Create a dynamic backup job in Enterprise Manager.

Answer: A

Explanation:

Creating a backup job based on vSphere tags allows for dynamic addition of new VMware hosted SQL servers. When new VMs are tagged appropriately in vSphere, they are automatically included in the backup job, ensuring all relevant SQL servers are backed up without manual intervention. References: Veeam Backup & Replication User Guide, Veeam Dynamic Backup Job Configuration Guide

NEW QUESTION 2

A corporation needs to give their MS SQL DBAs a way to restore their MS SQL databases.

Which action would allow the corporation to grant this access without giving access to other operations?

- A. Deny access to restore VMs in Enterprise Manager
- B. Give the DBA group Restore Operator access to the backup server
- C. Give the DBA group Restore Operator access to MS SQL DBs in Enterprise Manager
- D. Delegate application item recoveries to the DBA Group

Answer: C

Explanation:

To grant MS SQL DBAs the ability to restore their databases without giving access to other operations, the appropriate action is to give the DBA group Restore Operator access specifically to MS SQL databases within Veeam Enterprise Manager. This role-based access control allows DBAs to perform the needed restores while restricting access to other functionality. References:

? Veeam Backup & Replication User Guide: Role-Based Access Control

? Veeam Enterprise Manager Guide: Delegating Restore Operations

NEW QUESTION 3

In Veeam Enterprise Manager, what granular restoration permission can be set for the Restore Operator role?

- A. SharePoint items
- B. Active Directory items
- C. OneDrive items
- D. File items

Answer: D

Explanation:

In Veeam Enterprise Manager, granular restoration permissions can be set for the Restore Operator role, including the restoration of file items. This role allows designated users to perform file-level restores, ensuring that they can recover individual files without having full administrative privileges over the backup infrastructure. References:

? Veeam Enterprise Manager Guide: Roles and Permissions

? Veeam Help Center: Configuring Granular Restore Permissions

NEW QUESTION 4

What does Veeam's Secure Restore functionality ensure during restores?

- A. Proper rights/permissions on files and folders
- B. Custom ports for in-flight data
- C. 256-bit AES encryption of in-flight data
- D. Anti-virus scanning

Answer: D

Explanation:

Veeam's Secure Restore functionality is designed to provide an additional layer of security during the restore process, particularly to ensure that restored data is free from malware. The correct answer is D: Anti-virus scanning. Secure Restore integrates with antivirus software to scan the data being restored for malware, viruses, or other threats before it is brought back into the production environment. This capability is crucial in today's landscape, where data integrity and security are paramount, especially considering the increasing sophistication of cyber threats. By ensuring that restored data is scanned for threats, Veeam helps maintain the integrity and security of the IT environment, aligning with best practices for data protection and disaster recovery.

NEW QUESTION 5

What describes an RPO?

- A. To confirm at what point a backup should be migrated to Object Storage
- B. To clarify how many restore points need to be recovered at the same time
- C. To determine the maximum length of time a workload or application can be down
- D. To confirm the data loss tolerance of a Business Unit or Organization

Answer: D

Explanation:

Recovery Point Objective (RPO) refers to the maximum acceptable amount of data loss measured in time. It is essentially the age of the files that must be recovered from backup storage for normal operations to resume after a failure or disaster. In other words, it defines the data loss tolerance of a business unit or organization. If an RPO is set to one hour, the system must back up at least every hour to meet the RPO. References:

? Veeam Documentation: Recovery Point Objective (RPO)

? Veeam Backup & Replication User Guide: RPO and Recovery Time Objective (RTO) Definitions

NEW QUESTION 6

The administrator of a VMware environment backed up by Veeam Backup & Replication has a critical server with corruption on one of its three data drives. What is the fastest way to bring this drive back online with the least disruption to business?

- A. Instant Disk Recovery
- B. Staged restore
- C. Instant VM Recovery
- D. Entire VM restore

Answer: A

Explanation:

The fastest way to bring a corrupted data drive back online with the least disruption in a VMware environment is through Instant Disk Recovery. This feature allows the administrator to quickly restore the specific affected disk from a backup, minimizing downtime and impact on business operations. References: Veeam Backup & Replication User Guide, Veeam Instant Disk Recovery Guide

NEW QUESTION 7

What can Veeam service providers deploy in Service Provider Console 7.0?

- A. Enterprise plugins
- B. Veeam Backup for Microsoft 365
- C. Veeam Backup & Replication
- D. Veeam One

Answer: B

Explanation:

In the Service Provider Console 7.0, Veeam service providers can deploy Veeam Backup for Microsoft 365. This allows them to offer Microsoft 365 backup and recovery services to their customers, managing the protection of Microsoft 365 data including Exchange Online, SharePoint Online, OneDrive for Business, and Microsoft Teams data. References:

? Veeam Service Provider Console Documentation: Backup for Microsoft 365

? Veeam Cloud & Service Provider Program Guide

NEW QUESTION 8

In the war against ransomware, a company decided to implement tape backup. The infrastructure contains VMware VMs and physical Windows servers. What is the most efficient approach to getting all servers onto tape?

- A. Create file to tape jobs and write directly to tape.
- B. Create backup jobs, then create file to tape jobs.
- C. Create backup to tape jobs and write directly to tape.
- D. Create backup jobs, then create backup to tape jobs.

Answer: D

Explanation:

The most efficient approach to getting all servers onto tape, considering there are both VMware VMs and physical Windows servers in the infrastructure, is to first create backup jobs that target both the VMs and the physical servers. After these backups are stored on a disk-based repository, you can then create backup to tape jobs. This method leverages Veeam's ability to handle both types of environments and ensures that all data is efficiently backed up to tape for offsite storage and ransomware protection. References:

? Veeam Backup & Replication User Guide: Tape Device Support

? Veeam Best Practices: Configuring Tape Jobs

NEW QUESTION 9

What can Veeam Service Providers deploy in the Veeam Service Provider Console v7.0?

- A. Enterprise plugins
- B. Veeam backup agents
- C. Veeam Backup for Microsoft 365
- D. Veeam One

Answer: C

Explanation:

In the Veeam Service Provider Console v7.0, Veeam Service Providers can deploy C: Veeam Backup for Microsoft 365. This deployment option is designed to extend the capabilities of Veeam Service Providers, allowing them to offer managed backup services for Microsoft 365 environments, including Exchange Online, SharePoint Online, OneDrive for Business, and Microsoft Teams. Veeam Backup for Microsoft 365 is a comprehensive solution that provides secure backup of Microsoft 365 data, ensuring its availability and recoverability in the event of accidental deletion, security threats, or retention policy gaps. By integrating this solution into the Veeam Service Provider Console, service providers can manage and monitor Microsoft 365 backups across multiple tenants, enhancing their service offerings and providing added value to their customers.

NEW QUESTION 10

There is a company-wide mandate to migrate operations off corporate datacenters and over to AWS, Azure, and GCE. The Veeam engineer has backups of VMware, Hyper-V, and Nutanix VMs stored in on-premises repositories. The performance of a test restore was not satisfactory. Which solution should the engineer deploy?

- A. Caching servers on premises and in the cloud
- B. Veeam Wan Accelerators on premises and in the cloud
- C. Upgraded bandwidth to the Internet
- D. Helper appliance in the cloud

Answer: B

Explanation:

To improve the performance of test restores from on-premises repositories to cloud environments (AWS, Azure, and GCE), deploying Veeam WAN Accelerators on premises and in the cloud is recommended. WAN Accelerators optimize data transfer over the network, reducing the amount of data that needs to be transferred and thereby improving restore performance. References: Veeam Backup & Replication User Guide, Veeam WAN Accelerator Guide

NEW QUESTION 10

A company wants to ensure that, during a replication failover, database servers boot before the application servers. How can this be accomplished?

- A. Create a failover plan
- B. Create a disaster recovery template
- C. Create a replica mapping
- D. Create a planned failover

Answer: A

Explanation:

Veeam Backup & Replication allows you to set up failover plans to control the order in which VMs are started during a failover. By creating a failover plan, you can specify that the database servers boot before the application servers. This is achieved by setting up VM dependencies within the failover plan, ensuring that the database servers (which are critical for the application servers to function) are operational before the application servers start. Creating a disaster recovery template (B), creating a replica mapping (C), or initiating a planned failover (D) does not directly address the boot order of the servers during failover.

NEW QUESTION 13

A physical Windows server protected by a centrally managed Veeam agent is physically damaged. A Hyper-V infrastructure is available, and the physical server is eligible for virtualization.

Which recovery step provides the lowest possible RTO?

- A. Use Instant VM Recovery to Hyper-V.
- B. Use Instant Disk Recovery to Hyper-V.
- C. Use Bare Metal Restore to Hyper-VVMs.
- D. Use Export Disk Content as Virtual Disk to create a new VM.

Answer: A

Explanation:

Instant VM Recovery is a feature in Veeam that allows you to start a virtual machine directly from a backup file without waiting for the full restore. Using Instant VM Recovery to Hyper-V is the best option for achieving the lowest possible Recovery Time Objective (RTO) because it allows the damaged physical server's backup to be run as a VM in the Hyper-V environment almost immediately. The Veeam Agent for Microsoft Windows supports Instant Recovery to a Hyper-V VM, which will enable you to restore service quickly while you can plan for a more permanent recovery solution.

NEW QUESTION 16

A Windows Server using the ReFS filesystem has been used as a standalone Veeam repository for several years and is due for replacement. A new Windows server using the ReFS filesystem has been created to replace the old server, with twice the capacity. Backup files need to be transferred to the new server with no disruptions to the existing backup chains.

The Veeam engineer has begun to move backup files to the new repository but is now getting alerts that it is running out of space.

How could the engineer have avoided this issue?

- A. Use a Backup Copy Job
- B. Use the "Copy backup..." function
- C. Use the "Move backup..." function
- D. Use Robocopy with the /compress switch

Answer: C

Explanation:

To avoid running out of space when moving backups to a new repository, the "Move backup..." function in Veeam Backup & Replication should be used. This function allows you to relocate backup files to a new repository without duplicating data, which can save space. Unlike a simple copy action, the move function ensures that the backup chain remains intact and does not require additional space for a copy of the backups during the transfer. When the move is initiated, Veeam will also automatically update the configuration to point to the new backup location, thus preventing any disruptions in the backup chain.

NEW QUESTION 17

Hourly backup jobs are configured to local repositories. Daily backups must be sent from Site B to the repository on Site A. The connection between the two sites does not allow a direct backup to complete within the backup window. Impact on the source VMs at Site B should be minimized. Which type of job and Veeam components should be used to provide the necessary protection?

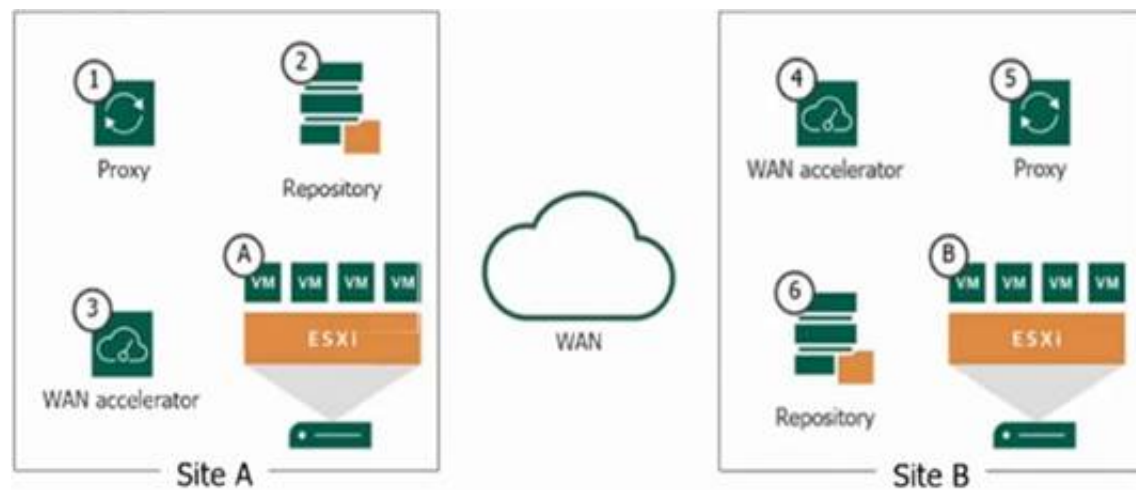

- A. A backup copy job and components 6 ? 4 ? 3 ? 2
 B. A backup job and components 5 ? 4 ? 3 ? 2
 C. A backup job and components 5 ? 2
 D. A backup copy job and components 6?5?4?3?1 ? 2

Answer: A

Explanation:

For the given scenario where daily backups need to be sent from Site B to a repository at Site A and the connection between the two sites is limited, thus impacting the ability to complete direct backups within the backup window, a Backup Copy Job would be appropriate. A Backup Copy Job is a feature in Veeam Backup & Replication that allows you to create several instances of the same backup files across different locations (repositories).

In the image provided, the components involved in the Backup Copy Job from Site B to Site A would be:

? 6 (Repository at Site B): This is the source repository where the hourly backup jobs are stored.

? 4 and 3 (WAN Accelerators at both sites): These components optimize data transfer over the WAN.

? 2 (Repository at Site A): This is the target repository where the backup copies will be stored.

This setup would minimize impact on the source VMs at Site B since the Backup Copy Job works with backup data rather than directly with the production VMs, thus reducing the load on those VMs during the process.

NEW QUESTION 19

An engineer needs to back up their VMware VMs running on a Nimble Array. The engineer has checked “Enable backup from storage snapshots” when creating the job. When the backup runs, snapshots are not triggered on the Nimble Array.

Which additional step must be performed?

- A. The Nimble Array needs to be rebooted to allow for Backup from Storage Snapshots.
 B. The Nimble Array needs to be added to Storage Infrastructure.
 C. The backup repository is not configured to accept snapshots
 D. VMware Tools need to be updated

Answer: B

Explanation:

To enable backup from storage snapshots with a Nimble Array, it is necessary to add the storage system to the Veeam Backup & Replication console's Storage Infrastructure. This allows Veeam to interact with the Nimble Array and orchestrate the creation of storage snapshots, which can then be used for backups. Simply enabling the backup from storage snapshots option in the job is not enough; the array itself must be integrated into the Veeam infrastructure. References:

? Veeam Backup & Replication User Guide: Integration with Storage Systems

? Veeam Best Practices: Nimble Storage Snapshot Integration

NEW QUESTION 23

An administrator is asked to change a backup copy job from periodic mode to immediate mode. How can this be accomplished?

- A. Modify the job settings on the proxy performing the copy job.
 B. Enable immediate mode on the repository.
 C. Edit the original job and select immediate copy mode from the job settings.
 D. Create a new copy job and delete the original job.

Answer: C

Explanation:

To change a backup copy job from periodic mode to immediate mode, an administrator can edit the original backup copy job and select the immediate copy mode from within the job settings. This change ensures that backup copy jobs are started immediately after the source backup job completes, rather than waiting for a defined copy interval. References:

? Veeam Backup & Replication User Guide: Backup Copy Job

? Veeam Help Center: Backup Copy Job Modes

NEW QUESTION 24

A company's infrastructure consists of multiple Hyper-V servers that store VMs on local storage. Which proxy should be used to back up these VMs?

- A. VM proxy
 B. Guest interaction proxy
 C. File proxy
 D. On-host backup proxy

Answer: D

Explanation:

For Hyper-V environments where VMs are stored on local storage, the On- host backup proxy should be used. This type of proxy processes jobs directly on the host where the Hyper-V role is enabled, allowing it to interact directly with the local VM storage. It is suitable for infrastructures with multiple Hyper-V servers storing VMs locally. References:

? Veeam Backup & Replication User Guide: Hyper-V On-Host Proxy

? Veeam Best Practices: Hyper-V Backup Proxies

NEW QUESTION 29

A Microsoft SQL server is running in a VMware VM. The VM is very sensitive to snapshots, and can only be snapshotted once per day at 3 AM. However, the RPO for the databases running inside the VM is 1 hour.

Which two Application-Aware Processing Settings should be selected in the backup job so that the 1 hour RPO for the databases is met? (Choose two.)

- A. SQL Tab: Choose how this job should process Microsoft SQL Server Transaction Logs: Back up logs periodically
- B. SQL Tab: Choose how this job should process Microsoft SQL Server Transaction Logs: Do not truncate logs
- C. General Tab: VSS Settings: Perform copy only
- D. SQL Tab: Choose how this job should process Microsoft SQL Server Transaction Logs: Truncate Logs
- E. General Tab: VSS Settings: Process transaction logs with this job

Answer: AE

Explanation:

To meet the 1-hour RPO for the databases within the VM, while only being able to snapshot the VM once per day, the best strategy is to enable regular transaction log backups (option A) and process transaction logs with the job (option E). This setup allows the system to capture changes in the SQL Server transaction logs at intervals less than the RPO requirement, without needing to snapshot the entire VM more frequently. References: Veeam Backup & Replication Documentation, Veeam Backup & Replication Best Practices Guide

NEW QUESTION 33

Veeam Backup & Replication is currently configured to keep backups for 14 days on a NAS repository. An engineer needs to enable GFS with 12 monthly and 5 yearly full backups to extend the retention for archival purposes but does not have enough space on the repository to store them.

After adding the repository to Scale-Out-Backup Repository (SOBR) as Performance Tier, which option should the engineer choose to solve this issue?

- A. Add an Object Storage as Capacity tier and set the policy to copy backups to object storage as soon as they are created
- B. Add another NAS repository as Capacity tier and set the policy to move backups older than 14 days
- C. Add an Object Storage as Archive tier and set the policy to move all GFS backups
- D. Add an Object Storage as Capacity tier and set the policy to move backups older than 14 days

Answer: D

Explanation:

To solve the space issue while enabling GFS retention, the engineer should add an Object Storage as a Capacity tier to the Scale-Out Backup Repository (SOBR) and set the policy to move backups that are older than 14 days. This approach allows for efficient use of local NAS storage for short-term retention and leverages object storage for long-term archival purposes. References: Veeam Backup & Replication User Guide, Veeam SOBR Configuration Guide

NEW QUESTION 37

A Veeam administrator wants to diagnose known issues in the configuration and performance of backup infrastructure without involving Veeam Technical Support. What feature of Veeam One should the administrator use?

- A. Intelligent Diagnostics
- B. Log Shipping Servers
- C. Business View
- D. Best Practices Analyzer

Answer: A

Explanation:

For diagnosing known issues in the configuration and performance of the backup infrastructure without the direct involvement of Veeam Technical Support, the administrator should utilize A: Intelligent Diagnostics in Veeam One. Intelligent Diagnostics is a feature designed to proactively detect known issues within the Veeam backup infrastructure by analyzing the system's event logs, performance data, and configurations. It uses predefined patterns and rules derived from common issues identified by Veeam Support to provide early warnings and suggest corrective actions. This self-service approach enables administrators to address potential problems before they impact operations, enhancing the reliability and efficiency of the backup infrastructure.

NEW QUESTION 41

A Scale-out Backup Repository with one local extent has been configured as follows.

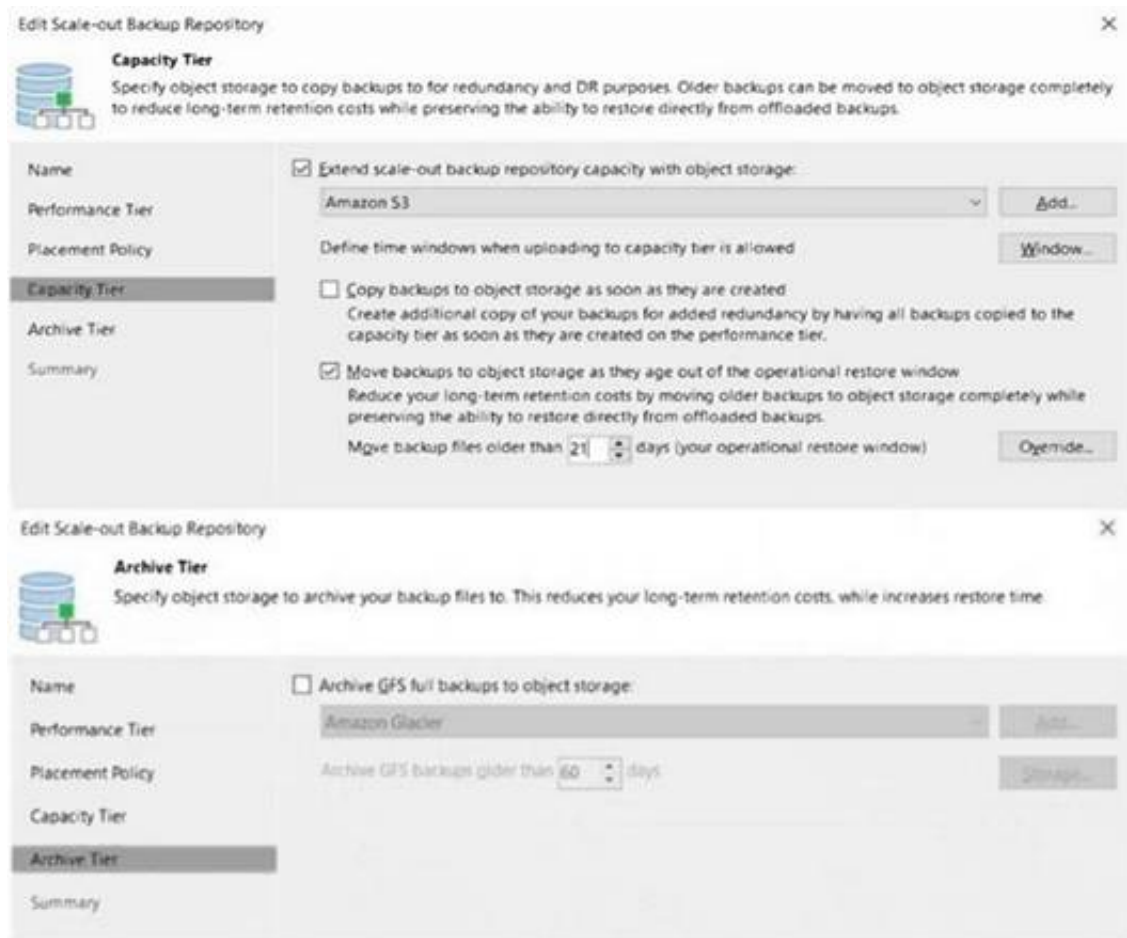

A daily VMware backup job retention is 31 days, keeping weekly GFS full backups for 14 weeks. It is Mar, 20. A file from a backup that occurred the week of Jan, 1 must be recovered. Where is the data?

- A. The performance tier
- B. The data is no longer in the Scale-out Backup Repository
- C. The capacity tier
- D. The archive tier

Answer: C

Explanation:

Based on the configuration shown in the image, backups older than 21 days are moved to the capacity tier. Since the VMware backup job retention is set for 31 days and keeps weekly GFS full backups for 14 weeks, the backup from the week of January 1st is older than 21 days but within the 14-week GFS retention policy. Therefore, as of March 20, the backup data you need to recover would be in the capacity tier, not on the local performance tier, because it has been offloaded to the object storage configured as the capacity tier to reduce long-term retention costs.

References: Veeam Backup & Replication Documentation, Scale-Out Backup Repository Configuration Guide

NEW QUESTION 44

What should be implemented when backing up NAS file shares to ensure there is more than one copy of the data?

- A. Archive repository
- B. Secondary copy
- C. Backup repository
- D. Cache repository

Answer: B

Explanation:

When backing up NAS file shares, it's essential to ensure that more than one copy of the data exists to adhere to best practices for data protection, often referred to as the 3-2-1 Rule (3 total copies of your data, 2 of which are local but on different devices, and at least 1 copy offsite). Implementing a secondary copy of the data provides this additional layer of redundancy. In Veeam, this can be achieved by creating backup copy jobs, which ensure that there is a secondary copy of the data, possibly stored in a different location. This is not to be confused with the simple use of backup repositories, which are storage locations for primary backups, or with cache/archive repositories which serve different purposes in the backup process.

NEW QUESTION 49

In the war against ransomware, a company decided to implement tape backup. The infrastructure contains Hyper-V VMs. What is the correct approach to getting all servers onto tape?

- A. Create media pools, then create file to tape jobs.
- B. Create media sets, then create backup to tape jobs.
- C. Create media sets, then create file to tape jobs.
- D. Create media pools, then create backup to tape jobs.

Answer: D

Explanation:

The correct approach for backing up Hyper-V VMs to tape in a ransomware protection strategy is to create media pools first and then configure backup to tape jobs. This method ensures organized and efficient tape management while securing VM backups on tape media. References: Veeam Backup & Replication User Guide, Veeam Tape Backup Configuration Guide

NEW QUESTION 53

An engineer has used a Linux Hardened Repository as the backup repository. The immutability period is set to 60 days.

The backup settings are: Retention Policy: 14 days

GFS Weekly full backup: 1 week GFS Monthly full backup: 6 months

If a full backup is created on 27th May 2023 with a monthly GFS flag, when will this restore point be automatically deleted?

- A. 2V June 2023
- B. 28th July 2023
- C. 28th November 2023
- D. 5th August 2023

Answer: C

Explanation:

The immutability period set on a Linux Hardened Repository prevents deletion of backup files for the duration of the immutability period. In this case, it is set to 60 days. However, the GFS (Grandfather-Father-Son) retention policy specifies that a monthly full backup is to be kept for 6 months. Since the full backup was created on 27th May 2023 and flagged as a monthly GFS backup, it will be retained for 6 months irrespective of the retention policy or the immutability setting.

Hence, the restore point will be automatically deleted after 6 months, which would be on the 28th of November 2023. References:

? Veeam Backup & Replication User Guide: GFS Retention Policy

? Veeam Help Center: Linux Hardened Repository Immutability

NEW QUESTION 54

An administrator needs to create a strategy in advance of a disaster to ensure that applications can be started in a specific order. How can this be accomplished?

- A. Attach XML file to existing job with the VM start order
- B. Application group
- C. Failover plan
- D. Veeam ONE migration script

Answer: C

Explanation:

To ensure that applications can be started in a specific order in advance of a disaster, an administrator should use a Failover Plan in Veeam Backup and Replication. This feature allows for the creation of a predefined sequence for starting up VMs, ensuring that applications are brought online in the correct order during a disaster recovery scenario. References: Veeam Backup & Replication User Guide, Veeam Failover Plan Configuration Guide

NEW QUESTION 57

A company is running nightly backups to satisfy their 24-hour RPO. There are two critical applications that cannot be offline more than 4 hours with no more than an hour of data loss.

How can this be accomplished?

- A. Linux hardened repository with immutability
- B. A local SOBR with AWS Object storage
- C. Backup copy jobs with hourly VM replication
- D. Enable Continuous Backup Replication

Answer: C

Explanation:

To meet the stringent Recovery Time Objective (RTO) of 4 hours and Recovery Point Objective (RPO) of 1 hour for the two critical applications, the most suitable approach is to use a combination of backup copy jobs and hourly VM replication, which corresponds to answer C. Backup copy jobs can ensure that backups are available offsite for disaster recovery purposes, while VM replication provides the ability to quickly failover to a replica VM in case of a primary VM failure, thereby minimizing downtime. Veeam's replication capabilities are designed to create exact copies of VMs at regular intervals, which can then be rapidly activated in case of a failure. This strategy ensures that the applications can be brought back online within the 4-hour RTO, with data loss not exceeding the 1-hour RPO, thus meeting the company's stringent data protection requirements for these critical applications.

NEW QUESTION 62

An engineer needs to be able to perform all functions without needing to access the backup server locally or over remote desktop.

What should the engineer do?

- A. Use SSH to connect to the Veeam Backup & Replication server.
- B. Install the required Veeam Explorers locally
- C. Install the Veeam console on the engineer's desktop.
- D. Use Enterprise Manager to connect to the Veeam Backup & Replication server.

Answer: C

Explanation:

To perform all functions without needing to access the backup server locally or over remote desktop, the engineer can install the Veeam console on their desktop. This allows the engineer to remotely manage and control the Veeam Backup & Replication infrastructure. The console provides full access to the backup server's capabilities from any machine within the network, making it unnecessary to log in directly to the server. References:

? Veeam Backup & Replication User Guide: Veeam Backup & Replication Console

? Veeam Help Center: Remote Management with Veeam Backup & Replication Console

NEW QUESTION 67

What is the primary benefit of configuring replica mapping?

- A. Compressed WAN traffic
- B. Deduplicated WAN traffic
- C. Reduced WAN traffic

D. Encrypted WAN traffic

Answer: C

Explanation:

The primary benefit of configuring replica mapping in Veeam Backup & Replication is C: Reduced WAN traffic. Replica mapping is a feature that allows an administrator to map an existing VM in the disaster recovery site to a replica job. This is particularly useful when the initial replication of a large VM has been performed by other means (such as shipping a hard drive with the VM data to the DR site) or if a replica VM already exists and needs to be re-synced with the source VM. By using replica mapping, Veeam can avoid transferring the entire VM over the WAN again and instead only synchronize the differences between the source VM and the existing replica. This significantly reduces the amount of data that needs to be transferred over the WAN, conserving bandwidth and speeding up the replication process. It's an efficient way to manage replicas, especially for large VMs or in environments with limited bandwidth.

NEW QUESTION 68

Veeam Backup and Replication is currently configured with backup jobs that are targeting a local Backup Repository on a Windows Server. The backups are now configured to run periodically every 6 hours. The engineer wants to create a secondary copy of the backups. However, due to bandwidth and compute restrictions, the copies must be created and transferred only once a day. Which option should the engineer choose to achieve this goal?

- A. Configure a Hardened Linux Repository, create a Backup Copy job with Periodic Copy (Pruning) mode to this repository and schedule it to run once a day
- B. Add the repository to a Scale-Out Backup repository, extend it with a Public Cloud Object Storage as Capacity tier in copy and move mode, and set the operational restorewindow to 7 days
- C. Find a Service Provider with Offsite Backup services, create a Backup Copy job with Immediate Copy (Mirroring) mode to the Service Provider repository
- D. [Add the repository to a Scale-Out Backup repository, extend it with a Public Cloud Object Storage as Capacity tier in copy mode

Answer: A

Explanation:

To achieve the goal of creating a secondary copy of the backups that is transferred only once a day, the engineer should configure a Hardened Linux Repository and create a Backup Copy job with Periodic Copy (Pruning) mode to this repository, scheduling it to run once a day. This setup respects the bandwidth and compute limitations while ensuring a daily copy of the backups. References: Veeam Backup & Replication User Guide, Veeam Backup Copy Job Configuration Guide

NEW QUESTION 71

The engineer needs to back up sensitive data located on VMware vSphere encrypted VMs. The company policy prioritizes data security over anything else. In the backup infrastructure, the engineer has configured:

One physical proxy configured on the DirectSAN Access transport mode, for fast data transfer speed and less load on the production network
Two physical proxies in NBDSSL
Encryption has been enabled on the backup job
Which action will allow the VM data to remain encrypted during the entire backup process?

- A. Configure Global Network Traffic Rules to encrypt the backup traffic.
- B. Configure the job to use the proxies with the NBDSSL transport mode.
- C. Configure the job to use the proxy with the DirectSAN Access transport mode.
- D. Upload a custom script that re-encrypts the VM data after the backup job.

Answer: B

Explanation:

To ensure that the VM data remains encrypted throughout the backup process, the job should be configured to use the proxies with the NBDSSL (Network Block Device SSL) transport mode. This mode encrypts data transferred over the network, adhering to the company policy that prioritizes data security. While DirectSAN Access is fast, it does not provide encryption of in-flight data. References:
? Veeam Backup & Replication User Guide: Transport Modes
? Veeam Best Practices: Securing Backup Traffic

NEW QUESTION 76

An engineer needs to make sure that a backup job includes both the virtual machine's disk files and the Microsoft SQL database transaction logs. Which backup feature in Veeam Backup and Replication should be used?

- A. Guest file system indexing
- B. Crash consistent mode
- C. App consistent mode
- D. Application-aware processing

Answer: D

Explanation:

To ensure that a backup job includes both the virtual machine's disk files and the Microsoft SQL database transaction logs, Application-aware processing should be used. This feature enables Veeam Backup & Replication to create transactionally consistent backups of VMs running VSS-aware applications like Microsoft SQL Server, ensuring that both the VM disks and the SQL transaction logs are properly backed up. References: Veeam Backup & Replication User Guide, Veeam Application-Aware Processing Guide

NEW QUESTION 77

For general data protection regulation (GDPR) compliance, Veeam can add a location tag to which component?

- A. vCenter servers
- B. WAN accelerators
- C. Guest interaction proxies
- D. Cloud gateways

Answer: A

Explanation:

Veeam Backup & Replication offers the capability to assign location tags to different components within the backup infrastructure, including vCenter servers. This feature is particularly useful for GDPR compliance, as it allows administrators to specify the physical location of the data processed and stored within vCenter servers, helping to ensure that data sovereignty and regulatory requirements are met. References:

? Veeam Backup & Replication User Guide: Location Tagging for GDPR Compliance

? Veeam Help Center: GDPR Compliance and Data Location Controls

NEW QUESTION 78

An environment is using Veeam Agent for Microsoft Windows and has Microsoft Exchange 2016 with regular database availability groups (DAGs) configured. What option is required to properly back up the databases?

- A. Standalone server
- B. Advanced Exchange Backup
- C. Exchange Processing
- D. Failover Cluster

Answer: D

Explanation:

The procedure of adding a Microsoft Exchange Database Availability Group (DAG) to a Veeam Agent backup job differs depending on the type of the DAG that you want to process: For a regular DAG, the backup job configuration procedure is the same as for any failover cluster. To process a regular DAG, you must configure a Veeam Agent backup job for a failover cluster https://helpcenter.veeam.com/docs/backup/agents/dag_hiw.html?ver=120

NEW QUESTION 81

For Veeam agent backup jobs, what feature is only available with Veeam Agent for Microsoft Windows?

- A. Application-aware processing of
- B. Backup from storage snapshots
- C. Volume backup
- D. File-level backup

Answer: A

Explanation:

Application-aware processing is a feature exclusive to Veeam Agent for Microsoft Windows. It allows for the creation of consistent backups of Windows-based applications and ensures that databases and applications like Microsoft Active Directory, SQL Server, Exchange, and SharePoint are quiesced and in a consistent state when being backed up. References:

? Veeam Agent for Microsoft Windows User Guide: Application-Aware Processing

? Veeam Help Center: Application-Aware Processing in Veeam Agent for Windows

NEW QUESTION 82

A backup administrator decided to move the Veeam Backup & Replication server and configuration database to new servers. Which configuration restore mode should be used?

- A. Restore
- B. Planned failover
- C. Failover plan
- D. Migrate

Answer: A

Explanation:

When moving the Veeam Backup & Replication server and its configuration database to new hardware or servers, the appropriate process to undertake is a configuration restore, denoted by option A: Restore. This process involves using the Veeam Backup & Replication Configuration Backup utility, which regularly backs up the configuration of the Veeam Backup & Replication server. In the event of a hardware migration or significant system change, this utility allows administrators to restore the server's configuration, including all settings, job configurations, and inventory, onto the new server setup. This ensures a seamless transition with minimal disruption to the backup operations and policies that were previously in place.

NEW QUESTION 87

Why is it recommended to install Veeam ONE before Veeam Backup & Replication?

- A. Veeam ONE stores the license file necessary for Veeam Backup & Replication.
- B. Veeam ONE can verify that the server meets the minimum requirements to install Veeam Backup & Replication.
- C. Veeam ONE is a prerequisite for Veeam Backup & Replication installation.
- D. Veeam ONE can potentially identify infrastructure issues prior to performing a backup.

Answer: D

Explanation:

It is recommended to install Veeam ONE before Veeam Backup & Replication because Veeam ONE can potentially identify infrastructure issues that might affect backup operations before they are performed. This proactive approach ensures that the environment is optimized for successful backup and replication tasks. References: Veeam Installation and Configuration Guide, Veeam ONE Deployment Best Practices

NEW QUESTION 89

What is a Recovery Point Objective (RPO) in regards to disaster recovery?

- A. The number of recovery points created during the backup process
- B. The acceptable data loss measured in time that can be tolerated
- C. The maximum amount of time it takes to restore a system
- D. The total cost associated with recovering a system

Answer: B

Explanation:

In the context of disaster recovery, the Recovery Point Objective (RPO) is best defined by option B: The acceptable data loss measured in time that can be tolerated. RPO is a critical metric in disaster recovery and business continuity planning that specifies the maximum amount of data (measured in time) that an organization can afford to lose in the event of a disaster or system failure. It effectively sets the limit for how frequently data backups or replications should occur. For instance, an RPO of 4 hours means that the organization must be able to recover data from no more than 4 hours prior to the disaster, implying that backup or replication operations should occur at least every 4 hours. Establishing an RPO is essential for developing an effective data protection strategy, as it guides the choice of backup methodologies and technologies to meet the organization's tolerance for data loss.

NEW QUESTION 90

.....

Relate Links

100% Pass Your VMCE_v12 Exam with Examible Prep Materials

https://www.examible.com/VMCE_v12-exam/

Contact us

We are proud of our high-quality customer service, which serves you around the clock 24/7.

Viste - <https://www.examible.com/>