

# VEEAM

## Exam Questions VMCE\_v12

Veeam Certified Engineer v12



**NEW QUESTION 1**

An administrator needs to configure a backup job that dynamically adds new VMware hosted SQL servers. How can this be accomplished?

- A. Create a job based on vSphere tags.
- B. Enable application aware processing.
- C. Create a CSV file that is scanned before the backup job starts.
- D. Create a dynamic backup job in Enterprise Manager.

**Answer:** A

**Explanation:**

Creating a backup job based on vSphere tags allows for dynamic addition of new VMware hosted SQL servers. When new VMs are tagged appropriately in vSphere, they are automatically included in the backup job, ensuring all relevant SQL servers are backed up without manual intervention. References: Veeam Backup & Replication User Guide, Veeam Dynamic Backup Job Configuration Guide

**NEW QUESTION 2**

What feature is only available with the Veeam Agent for Linux?

- A. File-level backup
- B. Application-aware processing of
- C. Backup from native snapshots
- D. Volume backup

**Answer:** C

**Explanation:**

The feature that is unique to Veeam Agent for Linux and not available in other Veeam Agent configurations is C: Backup from native snapshots. Veeam Agent for Linux includes the ability to leverage native snapshot capabilities of the Linux kernel, such as LVM (Logical Volume Manager) snapshots or Btrfs subvolume snapshots, to create consistent point-in-time copies of data. This capability allows for application-consistent backups even in complex Linux environments, ensuring that data is captured in a consistent state without the need for custom scripting or downtime. Native snapshot support in Veeam Agent for Linux enhances the flexibility and reliability of backups, particularly in environments where Linux-based applications and databases are critical to business operations.

**NEW QUESTION 3**

What does Veeam's Secure Restore functionality ensure during restores?

- A. Proper rights/permissions on files and folders
- B. Custom ports for in-flight data
- C. 256-bit AES encryption of in-flight data
- D. Anti-virus scanning

**Answer:** D

**Explanation:**

Veeam's Secure Restore functionality is designed to provide an additional layer of security during the restore process, particularly to ensure that restored data is free from malware. The correct answer is D: Anti-virus scanning. Secure Restore integrates with antivirus software to scan the data being restored for malware, viruses, or other threats before it is brought back into the production environment. This capability is crucial in today's landscape, where data integrity and security are paramount, especially considering the increasing sophistication of cyber threats. By ensuring that restored data is scanned for threats, Veeam helps maintain the integrity and security of the IT environment, aligning with best practices for data protection and disaster recovery.

**NEW QUESTION 4**

A company has an RPO set at 4 hours and values data protection and disaster recovery. A disaster occurs on June 12, 2023 at 10:00 AM. Which restore point gives the company the best RPO?

- A. June 12,2023,9:30 AM
- B. June 12,2023,5:00 AM
- C. June 12,2023, 1:00 PM
- D. June 12,2023,8:00 AM

**Answer:** A

**Explanation:**

Given the company has an RPO set at 4 hours, the restore point that gives the best RPO is the one closest to the time of the disaster without going over the disaster's timestamp. Since the disaster occurred on June 12, 2023, at 10:00 AM, the restore point at June 12, 2023, 9:30 AM would be the most recent one within the RPO threshold. This restore point minimizes data loss and provides the most current data before the disaster. References:

? Veeam Backup & Replication User Guide: Understanding RPO and RTO

? Veeam Best Practices: RPO and RTO Planning

**NEW QUESTION 5**

A request to protect some new domain controllers has been submitted in the ticketing system The engineer creates a backup job with the following steps:

- \* 1. Right-clicks on the Jobs navigation item on the left
- \* 2. Selects VMware vSphere from the menu
- \* 3. Enters a name for the job.
- \* 4. Selects workloads to protect.
- \* 5. Defines a job schedule.
- \* 6. Clicks the Finish button.

When testing restores, the engineer finds that the backups are crash-consistent. Which set of steps should the engineer use to avoid crash-consistent backups for the domain controllers?

- A. Launch the New Backup Job Wizar
- B. Enter a name for the io
- C. Select workloads to protec
- D. Choose a destinatio
- E. Enable the Application-Aware checkbox and configure setting
- F. Define a job schedul
- G. Click the Finish button.
- H. Launch the New Backup Job Wizar
- I. Enter a name and a descriptio
- J. Select a resource pool to protec
- K. Specify a backup repository with copy-mode enable
- L. Define a job schedul
- M. Click the Finish button.
- N. Launch the New Backup Job Wizard Enter a name for the job Specify a backup repositor
- O. Specify Guest Processing setting
- P. Define a job schedule Click the Finish button.
- Q. Launch the New Backup Job Wizard Enter a name or description for the jo
- R. Select the vSphere environment to protec
- S. Choose the Default Backup Repository Check the box labelled 'Run the job when I click Finish'. Specify Guest Processing setting
- T. Define a job schedule.

**Answer:** A

**Explanation:**

Application-aware processing is a feature in Veeam Backup & Replication that creates transactionally consistent backup images of VMs. For domain controllers, this feature ensures that backups are consistent with the applications running on the VM, like Active Directory services. To avoid crash-consistent backups and ensure application consistency, the engineer must enable the Application-Aware Processing option during the job configuration. References:

- ? Veeam Backup & Replication User Guide: Application-Aware Processing
- ? Veeam Best Practices: Protecting Active Directory Domain Controllers

**NEW QUESTION 6**

The configuration database is corrupted, and the backup administrator wants to recover the data. Which configuration restore mode should be used?

- A. Instant Recovery
- B. Restore
- C. Failover
- D. Migrate

**Answer:** B

**Explanation:**

In the event that the Veeam Backup & Replication configuration database is corrupted, the appropriate action to take is to perform a configuration restore. Veeam Backup & Replication allows you to back up and restore its configuration database. The Restore option should be used to recover the data from a configuration backup. This process will restore the configuration database from the backup file, which includes information about backup jobs, repository settings, and more. Instant Recovery, Failover, and Migrate are not appropriate options for recovering a corrupted configuration database. Instant Recovery is used to quickly restore a VM to a running state, Failover is used for High Availability in case a VM fails, and Migrate is used to move VMs from one host or storage to another.

**NEW QUESTION 7**

A backup administrator is called in to review a new Veeam deployment created by a coworker. The backup administrator takes the following notes:

- 12 backup jobs
- 1 SOBR configured with AWS S3 Performance Tier
- 1 Repository configured on Hardened Immutable Repository

The administrator also notes that six jobs are configured to use the SOBR and six jobs are configured to use the Hardened Immutable Repository. What should the backup administrator report to the other coworker regarding the 3-2-1 backup strategy?

- A. This will save costs with the Archive Tier in the SOBR.
- B. This needs the Hardened Immutable Repository added to the capacity tier.
- C. This only has 1 copy of the backup data.
- D. This meets the 3-2-1 best practices requirements.

**Answer:** C

**Explanation:**

The 3-2-1 backup strategy is a best practice that suggests having three total copies of your data, two of which are local but on different devices or media, and one copy offsite. In the described scenario, although there is an offsite component (SOBR with AWS S3 Performance Tier), and a local hardened immutable repository, there is no indication of a second local copy on a different device or media. This means that there is only one local copy of the backup data and one offsite copy. Therefore, the setup does not meet the 3-2-1 best practices requirement, which would involve having at least one more local copy on different media or device.

**NEW QUESTION 8**

What describes an RPO?

- A. To confirm at what point a backup should be migrated to Object Storage
- B. To clarify how many restore points need to be recovered at the same time
- C. To determine the maximum length of time a workload or application can be down
- D. To confirm the data loss tolerance of a Business Unit or Organization

**Answer:** D

**Explanation:**

Recovery Point Objective (RPO) refers to the maximum acceptable amount of data loss measured in time. It is essentially the age of the files that must be recovered from backup storage for normal operations to resume after a failure or disaster. In other words, it defines the data loss tolerance of a business unit or organization. If an RPO is set to one hour, the system must back up at least every hour to meet the RPO. References:

? Veeam Documentation: Recovery Point Objective (RPO)

? Veeam Backup & Replication User Guide: RPO and Recovery Time Objective (RTO) Definitions

#### NEW QUESTION 9

A Veeam administrator is creating a protection group that needs to back up all servers for the accounting department using Veeam Agent for Microsoft Windows. New accounting servers must be automatically added to the protection group. How is this accomplished?

- A. Create an Active Directory based protection group targeted at an Active Directory security group.
- B. Install a configuration file on each of the accounting servers that adds it to the protection group.
- C. Create a protection group and set it to automatically scan every three hours for new servers.
- D. Create a protection group that reads a CSV file listing the accounting servers.

**Answer:** A

#### Explanation:

To ensure that all servers for the accounting department are backed up and any new servers added to the department are automatically included in the protection group, the best approach is to use an Active Directory (AD) based protection group. Therefore, the correct answer is A: Create an Active Directory based protection group targeted at an Active Directory security group.

By leveraging an AD-based protection group, the Veeam administrator can specify an AD security group that encompasses all user accounts or computer accounts (in this case, servers) associated with the accounting department. As new servers are introduced and added to this AD security group, Veeam Backup & Replication will automatically detect these new members during its periodic rescan (which can be scheduled as per the administrator's preferences) and include them in the protection group. This method not only automates the inclusion of new servers into the backup routine but also simplifies the management of backup policies for dynamically changing environments such as the accounting department's server infrastructure.

#### NEW QUESTION 10

The administrator of a VMware environment backed up by Veeam Backup & Replication has a critical server that has crashed and will not reboot. They were able to bring it back online quickly using Instant VM Recovery so people could continue to work. What else is required to complete the recovery?

- A. Migrate to production
- B. Commit failover
- C. Commit tailback
- D. Merge delta file

**Answer:** A

#### Explanation:

After using Instant VM Recovery to bring a critical crashed server back online quickly, the final step required to complete the recovery process is A: Migrate to production. Instant VM Recovery allows a VM to run directly from the backup file in a temporary location, enabling rapid recovery and minimal downtime. However, because the VM is running in this provisional state, it's essential to migrate it back to the production environment to ensure long-term stability and performance. The "Migrate to production" operation involves moving the running VM from the backup storage to the production storage, typically involving a storage vMotion in VMware environments or a similar process in other hypervisors. This step ensures that the VM is fully restored to its original or a new production environment, solidifying the recovery and allowing the VM to operate as part of the normal infrastructure once again.

#### NEW QUESTION 10

What can Veeam service providers deploy in Service Provider Console 7.0?

- A. Enterprise plugins
- B. Veeam Backup for Microsoft 365
- C. Veeam Backup & Replication
- D. Veeam One

**Answer:** B

#### Explanation:

In the Service Provider Console 7.0, Veeam service providers can deploy Veeam Backup for Microsoft 365. This allows them to offer Microsoft 365 backup and recovery services to their customers, managing the protection of Microsoft 365 data including Exchange Online, SharePoint Online, OneDrive for Business, and Microsoft Teams data. References:

? Veeam Service Provider Console Documentation: Backup for Microsoft 365

? Veeam Cloud & Service Provider Program Guide

#### NEW QUESTION 12

In the war against ransomware, a company decided to implement tape backup. The infrastructure contains VMware VMs and physical Windows servers. What is the most efficient approach to getting all servers onto tape?

- A. Create file to tape jobs and write directly to tape.
- B. Create backup jobs, then create file to tape jobs.
- C. Create backup to tape jobs and write directly to tape.
- D. Create backup jobs, then create backup to tape jobs.

**Answer:** D

#### Explanation:

The most efficient approach to getting all servers onto tape, considering there are both VMware VMs and physical Windows servers in the infrastructure, is to first create backup jobs that target both the VMs and the physical servers. After these backups are stored on a disk-based repository, you can then create backup to tape jobs. This method leverages Veeam's ability to handle both types of environments and ensures that all data is efficiently backed up to tape for offsite storage and ransomware protection. References:

? Veeam Backup & Replication User Guide: Tape Device Support  
? Veeam Best Practices: Configuring Tape Jobs

**NEW QUESTION 13**

What can Veeam Service Providers deploy in the Veeam Service Provider Console v7.0?

- A. Enterprise plug-ins
- B. Veeam backup agents
- C. Veeam Backup for Microsoft 365
- D. Veeam One

**Answer: C**

**Explanation:**

In the Veeam Service Provider Console v7.0, Veeam Service Providers can deploy C: Veeam Backup for Microsoft 365. This deployment option is designed to extend the capabilities of Veeam Service Providers, allowing them to offer managed backup services for Microsoft 365 environments, including Exchange Online, SharePoint Online, OneDrive for Business, and Microsoft Teams. Veeam Backup for Microsoft 365 is a comprehensive solution that provides secure backup of Microsoft 365 data, ensuring its availability and recoverability in the event of accidental deletion, security threats, or retention policy gaps. By integrating this solution into the Veeam Service Provider Console, service providers can manage and monitor Microsoft 365 backups across multiple tenants, enhancing their service offerings and providing added value to their customers.

**NEW QUESTION 17**

An engineer needs to test the impact of operating system updates on app functionality in an isolated non-production environment. What Veeam Backup and Replication feature can be used to facilitate this?

- A. Replication
- B. Direct Storage Snapshots
- C. Virtual Labs
- D. Instant Recovery

**Answer: C**

**Explanation:**

Virtual Labs is the ideal feature for testing the impact of operating system updates in an isolated environment. Virtual Labs allow you to create a secure, isolated copy of your production environment where you can test updates, patches, and other changes without affecting the live environment. References: Veeam Backup & Replication Documentation, Veeam Virtual Lab Guide

**NEW QUESTION 18**

There is a company-wide mandate to migrate operations off corporate datacenters and over to AWS, Azure, and GCE. The Veeam engineer has backups of VMware, Hyper-V, and Nutanix VMs stored in on-premises repositories. The performance of a test restore was not satisfactory. Which solution should the engineer deploy?

- A. Caching servers on premises and in the cloud
- B. Veeam WAN Accelerators on premises and in the cloud
- C. Upgraded bandwidth to the Internet
- D. Helper appliance in the cloud

**Answer: B**

**Explanation:**

To improve the performance of test restores from on-premises repositories to cloud environments (AWS, Azure, and GCE), deploying Veeam WAN Accelerators on premises and in the cloud is recommended. WAN Accelerators optimize data transfer over the network, reducing the amount of data that needs to be transferred and thereby improving restore performance. References: Veeam Backup & Replication User Guide, Veeam WAN Accelerator Guide

**NEW QUESTION 19**

It is required that some replicated VMs start on a time delay during a failover. How can this be accomplished?

- A. Create a failover plan.
- B. Adjust boot delay in application group.
- C. Use a pre-freeze/post-thaw script.
- D. Modify the failover template file.

**Answer: A**

**Explanation:**

A failover plan in Veeam Backup & Replication allows you to define the order in which VMs are started during a failover operation. It can include startup delays for certain VMs, ensuring that some VMs can be configured to start after a defined time delay. This meets the requirement of having some replicated VMs start on a time delay. References:

? Veeam Backup & Replication User Guide: Failover Plans  
? Veeam Help Center: Creating Failover Plans

**NEW QUESTION 24**

An engineer wants to make sure that a single SQL Database can be recovered in a consistent manner with an RPO that will offer the least impact on the production environment during production hours. Granular restores should be performed with the Veeam console as the company does not have a DBA and is not using SQL Management Studio (SSMS).

The engineer took the following steps:

- Created a separate job for the MS SQL VMs
- At guest processing, enabled application-aware processing and provide the credentials with sufficient permissions



- Schedule the job to run every 24 hours
- Which other change can the engineer make for this job to achieve the proposed goals?

- A. Schedule transaction log processing every 30 minutes
- B. Remove the VM and add only the SQL Databases in the job
- C. Set the backup job to perform recovery using Veeam Explorer for SQL
- D. Schedule the job to run every 30 minutes

**Answer:** A

**Explanation:**

To achieve the goal of recovering a single SQL Database in a consistent manner with minimal impact on the production environment during production hours, while allowing for granular restores through the Veeam console, the engineer should A: Schedule transaction log processing every 30 minutes. By enabling application-aware processing for the SQL VM and scheduling the main backup job to run every 24 hours, the base image of the SQL database is protected. However, to achieve a more granular Recovery Point Objective (RPO) and ensure the ability to restore to specific points in time, transaction log backups must be performed more frequently. Configuring the backup job to process transaction logs every 30 minutes captures the SQL database changes more frequently without the overhead of a full backup, allowing for point-in-time restores directly from the Veeam console without the need for SQL Management Studio (SSMS) or a Database Administrator (DBA). This setup aligns with the goals of maintaining operational efficiency and minimizing the impact on production while ensuring robust data protection capabilities.

**NEW QUESTION 28**

Which Veeam replication failover function ensures that changes made during a failover are copied to the original production VM?

- A. Fallback
- B. Permanent failover
- C. Undo failover
- D. Undo fallback

**Answer:** A

**Explanation:**

In Veeam replication, the function that ensures changes made during a failover are copied back to the original production VM is Fallback. This process involves reversing the replication direction after a failover, ensuring that any changes made while running on the replica are synchronized back to the original VM. References: Veeam Backup & Replication User Guide, Veeam Replication Fallback Guide

**NEW QUESTION 29**

The engineer configured Veeam Backup & Replications 3 years ago with an all-in-one physical server with one job backing up all VMs. The environment grew considerably and RPOs are no longer met.

The engineer checks the backup job and sees:

Load: Source 0% > Proxy 68% > Network 0% > Target 0%. What should be done to decrease the backup processing time?

- A. Edit the Backup Job settings and enable parallel processing from Advanced options
- B. Split the VMs in several jobs with the same schedule to process the VMs in parade C From Backup Infrastructure add an extra Windows/Linux machine as Backup Proxy
- C. Install another Veeam Backup & Replication server and move half of the VMs to be processed in a separate job

**Answer:** C

**Explanation:**

Given the proxy load of 68% and all other loads (source, network, target) at 0%, the bottleneck is at the proxy. To decrease the backup processing time and accommodate the growth of the environment, adding additional Windows or Linux machines as backup proxies would help distribute the load. This would enable parallel processing and reduce the time taken to complete the backup jobs, thereby helping to meet the RPOs.

References:

Veeam Backup & Replication User Guide: Backup Proxy Veeam Help Center: Managing Backup Proxies

**NEW QUESTION 32**

A company wants to ensure that, during a replication failover, database servers boot before the application servers. How can this be accomplished?

- A. Create a failover plan
- B. Create a disaster recovery template
- C. Create a replica mapping
- D. Create a planned failover

**Answer:** A

**Explanation:**

Veeam Backup & Replication allows you to set up failover plans to control the order in which VMs are started during a failover. By creating a failover plan, you can specify that the database servers boot before the application servers. This is achieved by setting up VM dependencies within the failover plan, ensuring that the database servers (which are critical for the application servers to function) are operational before the application servers start. Creating a disaster recovery template (B), creating a replica mapping (C), or initiating a planned failover (D) does not directly address the boot order of the servers during failover.

**NEW QUESTION 36**

A physical Windows server protected by a centrally managed Veeam agent is physically damaged. A Hyper-V infrastructure is available, and the physical server is eligible for virtualization.

Which recovery step provides the lowest possible RTO?

- A. Use Instant VM Recovery to Hyper-V.
- B. Use Instant Disk Recovery to Hyper-V.
- C. Use Bare Metal Restore to Hyper-V-VMs.

D. Use Export Disk Content as Virtual Disk to create a new VM.

**Answer:** A

**Explanation:**

Instant VM Recovery is a feature in Veeam that allows you to start a virtual machine directly from a backup file without waiting for the full restore. Using Instant VM Recovery to Hyper-V is the best option for achieving the lowest possible Recovery Time Objective (RTO) because it allows the damaged physical server's backup to be run as a VM in the Hyper-V environment almost immediately. The Veeam Agent for Microsoft Windows supports Instant Recovery to a Hyper-V VM, which will enable you to restore service quickly while you can plan for a more permanent recovery solution.

**NEW QUESTION 37**

A customer has a physical windows server running Microsoft SQL 2020. Which component should be used to protect the whole server?

- A. Veeam Agent
- B. Veeam Plug-in for Enterprise Application
- C. Veeam Backup Proxy
- D. Cache Repository

**Answer:** A

**Explanation:**

To protect a physical Windows server running Microsoft SQL 2020, the Veeam Agent should be used. Veeam Agent is designed to provide comprehensive backup and recovery for physical servers, including those running critical applications like Microsoft SQL Server. References: Veeam Agent for Windows User Guide, Veeam Physical Server Backup Guide

**NEW QUESTION 40**

A Windows Server using the ReFS filesystem has been used as a standalone Veeam repository for several years and is due for replacement. A new Windows server using the ReFS filesystem has been created to replace the old server, with twice the capacity. Backup files need to be transferred to the new server with no disruptions to the existing backup chains.

The Veeam engineer has begun to move backup files to the new repository but is now getting alerts that it is running out of space.

How could the engineer have avoided this issue?

- A. Use a Backup Copy Job
- B. Use the "Copy backup..." function
- C. Use the "Move backup..." function
- D. Use Robocopy with the /compress switch

**Answer:** C

**Explanation:**

To avoid running out of space when moving backups to a new repository, the "Move backup..." function in Veeam Backup & Replication should be used. This function allows you to relocate backup files to a new repository without duplicating data, which can save space. Unlike a simple copy action, the move function ensures that the backup chain remains intact and does not require additional space for a copy of the backups during the transfer. When the move is initiated, Veeam will also automatically update the configuration to point to the new backup location, thus preventing any disruptions in the backup chain.

**NEW QUESTION 43**

An engineer is using Veeam Backup and Replication v12.

The only backup repository is a Microsoft Windows server with direct attached Fibre Channel storage array.

The engineer realizes that none of their backups are immutable. A second copy of the backup on a different site and a different media is required.

Which option should be used to provide immutable backups on a secondary site with a different media?

- A. Create a Scale Out Backup Repository with the existing Microsoft Windows Server as the performance tier and an HPe StoreOnce Catalyst share with immutability enabled as the capacity tier.
- B. Create a Scale Out Backup Repository with the existing Microsoft Windows Server as the performance tier and AWS S3 bucket with immutability enabled as the capacity tier.
- C. Create a new hardened repository on a new Microsoft Windows Server, mark it as immutable and create a backup copy job on it.
- D. Create a Scale Out Backup Repository with the existing Microsoft Windows Server as the performance tier and Google Cloud Object Storage with immutability enabled as the capacity tier.

**Answer:** B

**Explanation:**

To provide immutable backups on a secondary site with a different media, the best option given the context is B: Create a Scale Out Backup Repository (SOBR) with the existing Microsoft Windows Server as the performance tier and an AWS S3 bucket with immutability enabled as the capacity tier.

This approach involves leveraging the existing backup infrastructure (Microsoft Windows Server with direct-attached storage) as the performance tier of the SOBR, where the most recent backups are stored for fast access. For long-term storage and immutability, backups can be offloaded to an AWS S3 bucket configured with Object Lock. The Object Lock feature in AWS S3 provides an additional layer of data protection by making the backup data immutable, meaning it cannot be deleted or modified for a specified duration. This setup ensures that backup data is protected against accidental deletion, ransomware, and other malicious activities.

By implementing this configuration, the engineer can achieve the desired level of data protection and immutability, utilizing cloud storage as a secure and scalable secondary backup location, distinct from the primary on-premises storage media.

**NEW QUESTION 44**

Which Veeam Backup & Replication functionality achieves the lowest RPO?

- A. Backup Copy Job
- B. Continuous Data Protection
- C. Snapshot-based Replication
- D. File to Tape

**Answer:** B

**Explanation:**

Within Veeam Backup & Replication, the functionality that achieves the lowest Recovery Point Objective (RPO) is B: Continuous Data Protection (CDP). CDP is designed to protect critical workloads by continuously capturing changes and replicating them to a target site, allowing for very low RPOs, often measured in seconds. This is achieved through the use of VMware's vSphere APIs for I/O Filtering (VAIO), which intercepts and replicates I/O streams almost in real-time. CDP is particularly valuable for applications that require high levels of availability and cannot tolerate significant data loss. By providing near-continuous replication, CDP ensures that in the event of a failure or disaster, data loss can be minimized to a very narrow window, significantly reducing the potential impact on business operations.

**NEW QUESTION 48**

Which two public cloud infrastructures can be backed up without an agent? (Choose two.)

- A. AWS
- B. Tencent Cloud
- C. Alibaba Cloud
- D. Oracle VM Virtualbox
- E. Microsoft Azure

**Answer:** AE

**Explanation:**

Veeam provides agentless backup solutions for several public cloud infrastructures, among which AWS (Amazon Web Services) and Microsoft Azure are the prominent platforms supported. Thus, the correct answers are A: AWS and E: Microsoft Azure.

? For AWS, Veeam offers Veeam Backup for AWS, an agentless solution designed to protect AWS workloads by leveraging native AWS technologies. This solution allows for the backup and recovery of AWS EC2 instances without the need for agents inside the instances, providing efficient and flexible cloud-native data protection.

? In the case of Microsoft Azure, Veeam Backup for Microsoft Azure provides a similar agentless data protection capability, allowing for the backup and recovery of Azure VMs. This solution also utilizes native Azure technologies to facilitate seamless integration and management of backups within the Azure ecosystem.

These solutions are designed to provide comprehensive data protection for cloud workloads, simplifying management while ensuring robust backup and recovery capabilities in these public cloud environments.

**NEW QUESTION 53**

Company security policy states that backups must be copied to a remote location within 8 hours.

What step can a backup administrator take to receive an alert automatically if the backup copy job violates the company's policy?

- A. Set a Data Protection alert in Enterprise Manager
- B. Set a backup copy window alert on the repository
- C. Set up post-thaw scripts to send an email
- D. Enable the appropriate RPO monitor

**Answer:** D

**Explanation:**

To receive an automatic alert if the backup copy job violates the company's 8-hour policy for copying backups to a remote location, the backup administrator should enable the appropriate Recovery Point Objective (RPO) monitor. This feature tracks the age of the latest backup and alerts when it exceeds the defined RPO. References: Veeam Backup & Replication Documentation, Veeam RPO Monitoring and Reporting Guide

**NEW QUESTION 54**

A customer wants to start an on-demand lab from backup files for several mission critical VMs.

What SureBackup feature should be configured to identify the necessary VMs?

- A. Application Group
- B. Virtual Lab
- C. Staged Restore
- D. Secure Restore

**Answer:** A

**Explanation:**

When starting an on-demand lab from backup files for mission-critical VMs, the appropriate SureBackup feature to configure is A: Application Group. An Application Group in Veeam Backup & Replication is a predefined group of VMs that are started together in the SureBackup job. This feature is designed to ensure that interdependent VMs, such as those comprising a multi-tier application, are started in a sequence that respects their operational dependencies, allowing for comprehensive verification and testing. The Application Group can include the mission-critical VMs and any associated VMs required for the application environment to function correctly, ensuring that all components are available and interact as expected within the isolated on-demand lab environment. This setup facilitates effective testing or troubleshooting in a manner that closely mirrors the production environment without impacting live operations.

**NEW QUESTION 55**

A customer's NAS has multiple hardware failures, and the NAS is no longer accessible. All of the users are impacted as they need to access the NAS for day-to-day work.

Which restore method could minimize the service impact to the users?

- A. Restore of files and folders
- B. Instant file share recovery
- C. Rollback to a point in time
- D. Restore of the entire file share

**Answer:** B



**Explanation:**

Instant file share recovery is the most effective method to minimize service impact in this scenario. This feature allows users to instantly access the NAS data directly from the backup files without having to wait for the entire file share to be restored. This approach is beneficial when quick access to data is crucial. References: Veeam Backup & Replication Documentation, Veeam NAS Backup Guide

**NEW QUESTION 57**

A company's infrastructure includes a Fibre Channel SAN where the VMware VMs are located. The administrator wants to create a backup that minimizes the impact on the production environment. What proxy transport mode should be used?

- A. Network
- B. Guest interaction
- C. Direct storage access
- D. Virtual appliance

**Answer: C**

**Explanation:**

For a VMware environment on a Fibre Channel SAN, the most efficient proxy transport mode to minimize impact on the production environment is Direct Storage Access. This mode allows the backup proxy to directly interact with the SAN, bypassing the production network and reducing load on the ESXi hosts. References: Veeam Backup & Replication Best Practices, Veeam VMware Backup Proxy Guide

**NEW QUESTION 58**

A photography company provides online purchase of photographs. The core of the business operates from an Oracle database that stores all company images. New photos are continuously added to the database at widely variable intervals. Company policy only requires the database to be protected. Which Veeam Feature will provide complete backup and recovery for this database?

- A. Use the Veeam Explorer to Identify and backup the database and logs daily along with the log backup set to 15-minute interval.
- B. Use the Veeam Plug-in for Oracle RMAN Back up the database daily Back up the archived redo logs at 15-minute intervals.
- C. Use the Veeam Agen
- D. Back up the entire server including the database with Consistent Server Backup feature
- E. Use the Veeam Plug-in for Oracle RMAN Back up the entire host server including the database and logs daily.

**Answer: B**

**Explanation:**

The Veeam Plug-in for Oracle RMAN is designed specifically for efficient backup and recovery of Oracle databases. It allows for direct integration with Oracle RMAN (Recovery Manager), ensuring that the backups are consistent and reliable. For a photography company that relies heavily on an Oracle database with new photos being continuously added, this feature provides an ideal solution. The daily backup of the database ensures that all new content is secured regularly, while the 15-minute interval for archived redo logs ensures that any recent transactions are also protected. This approach aligns well with the company's requirement to protect only the database. References:  
? Veeam Documentation: Veeam Plug-in for Oracle RMAN  
? Veeam Help Center: Oracle RMAN Backup and Recovery

**NEW QUESTION 60**

A Veeam engineer needs to copy backup files from a Windows repository in Site A to a Linux repository in Site B. The WAN connection between the two sites is busy during business hours. The engineer needs to configure a backup copy job to accomplish this task. Which feature of the backup copy job should be configured to avoid transferring data during business hours?

- A. Immediate copy
- B. Periodic copy
- C. WAN accelerator
- D. Backup Copy Window

**Answer: D**

**Explanation:**

In a scenario where a Veeam engineer needs to manage backup file transfers between two sites without impacting bandwidth during business hours, the most appropriate feature to configure in the backup copy job is D: Backup Copy Window. The Backup Copy Window setting in Veeam Backup & Replication allows for specifying the time frame during which the backup copy job is allowed to transfer data. By configuring this window to exclude business hours, the engineer can ensure that the backup copy job transfers data only during off-peak hours, thereby avoiding additional strain on the WAN connection when it is most needed for business operations. This approach provides the flexibility to balance the need for offsite backups with the practical bandwidth considerations of a busy WAN connection, ensuring that backup activities do not interfere with critical business functions.

**NEW QUESTION 61**

A company needs to ensure that, during a disaster, a group of VMs starts in a certain order with time delays between starting each VM. How can this be accomplished?

- A. Perform a planned failover.
- B. Create a failover plan.
- C. Create a failover template file for the group of VMs.
- D. Create a replica chain in the Veeam Backup & Replication console.

**Answer: B**

**Explanation:**

To ensure that a group of VMs starts in a specific order with time delays during a disaster scenario, the solution is B: Create a failover plan. A failover plan in Veeam Backup & Replication is a feature designed to manage the startup sequence of VMs within a DR site. The failover plan can be customized to specify the order in which VMs should start and to include necessary delays between the startups of each VM. This is especially useful for multi-tier applications where the order of startup is essential for the application stack to become fully operational. By using a failover plan, companies can control the recovery process, ensuring

that VMs are brought online in an orderly and coordinated fashion that respects their interdependencies.

#### NEW QUESTION 65

A mid-sized company uses Veeam Backup and Replication to safeguard their business- critical data from ransomware attacks. The company needs to validate backups and increase security, while improving DevOps efficiency.

How can a SureBackup Job be utilized to address the company's specific needs?

- A. Helps improve the data deduplication and compression ratios
- B. Validates backup data and ensures backups are ransom ware-free
- C. Creates a secure, isolated environment to test new applications
- D. Improves recovery speed reducing RTO

**Answer: C**

#### Explanation:

A SureBackup Job in Veeam Backup and Replication can be utilized to create a secure, isolated environment to test new applications. This feature allows companies to validate backups and run their VMs in an isolated environment, providing an opportunity to test applications, patches, or updates without impacting the production environment. References: Veeam Backup & Replication Documentation, Veeam SureBackup Guide

#### NEW QUESTION 70

For general data protection regulation (GDPR) compliance, Veeam can add a location tag to which component?

- A. File copy job
- B. Proxy server
- C. Scale-out Backup Repositories
- D. WAN accelerator

**Answer: C**

#### Explanation:

For GDPR compliance, Veeam provides the capability to add location tags to Scale-out Backup Repositories. Location tags in Veeam Backup & Replication are used to identify the location of data, which is essential for adhering to data sovereignty laws like GDPR. Location tagging helps ensure that data residency requirements are met by keeping data in a defined geographical area. In the context of GDPR, it's important to manage and control where personal data is stored and processed. Proxy servers, file copy jobs, and WAN accelerators do not have the functionality to be tagged for GDPR compliance in the same manner as repositories within Veeam Backup & Replication.

#### NEW QUESTION 72

Veeam Backup & Replication is currently configured to keep backups for 14 days on a NAS repository. An engineer needs to enable GFS with 12 monthly and 5 yearly full backups to extend the retention for archival purposes but does not have enough space on the repository to store them.

After adding the repository to Scale-Out-Backup Repository (SOBR) as Performance Tier, which option should the engineer choose to solve this issue?

- A. Add an Object Storage as Capacity tier and set the policy to copy backups to object storage as soon as they are created
- B. Add another NAS repository as Capacity tier and set the policy to move backups older than 14 days
- C. Add an Object Storage as Archive tier and set the policy to move all GFS backups
- D. Add an Object Storage as Capacity tier and set the policy to move backups older than 14 days

**Answer: D**

#### Explanation:

To solve the space issue while enabling GFS retention, the engineer should add an Object Storage as a Capacity tier to the Scale-Out Backup Repository (SOBR) and set the policy to move backups that are older than 14 days. This approach allows for efficient use of local NAS storage for short-term retention and leverages object storage for long-term archival purposes. References: Veeam Backup & Replication User Guide, Veeam SOBR Configuration Guide

#### NEW QUESTION 76

In the war against ransomware, a company decided to implement tape backup. The infrastructure contains Hyper-V VMs. What is the correct approach to getting all servers onto tape?

- A. Create media pools, then create file to tape jobs.
- B. Create media sets, then create backup to tape jobs.
- C. Create media sets, then create file to tape jobs.
- D. Create media pools, then create backup to tape jobs.

**Answer: D**

#### Explanation:

The correct approach for backing up Hyper-V VMs to tape in a ransomware protection strategy is to create media pools first and then configure backup to tape jobs. This method ensures organized and efficient tape management while securing VM backups on tape media. References: Veeam Backup & Replication User Guide, Veeam Tape Backup Configuration Guide

#### NEW QUESTION 77

An administrator needs to create a strategy in advance of a disaster to ensure that applications can be started in a specific order. How can this be accomplished?

- A. Attach XML file to existing job with the VM start order
- B. Application group
- C. Failover plan
- D. Veeam ONE migration script

**Answer:** C

**Explanation:**

To ensure that applications can be started in a specific order in advance of a disaster, an administrator should use a Failover Plan in Veeam Backup and Replication. This feature allows for the creation of a predefined sequence for starting up VMs, ensuring that applications are brought online in the correct order during a disaster recovery scenario. References: Veeam Backup & Replication User Guide, Veeam Failover Plan Configuration Guide

**NEW QUESTION 81**

A company is running nightly backups to satisfy their 24-hour RPO. There are two critical applications that cannot be offline more than 4 hours with no more than an hour of data loss.

How can this be accomplished?

- A. Linux hardened repository with immutability
- B. A local SOBR with AWS Object storage
- C. Backup copy jobs with hourly VM replication
- D. Enable Continuous Backup Replication

**Answer:** C

**Explanation:**

To meet the stringent Recovery Time Objective (RTO) of 4 hours and Recovery Point Objective (RPO) of 1 hour for the two critical applications, the most suitable approach is to use a combination of backup copy jobs and hourly VM replication, which corresponds to answer C. Backup copy jobs can ensure that backups are available offsite for disaster recovery purposes, while VM replication provides the ability to quickly failover to a replica VM in case of a primary VM failure, thereby minimizing downtime. Veeam's replication capabilities are designed to create exact copies of VMs at regular intervals, which can then be rapidly activated in case of a failure. This strategy ensures that the applications can be brought back online within the 4-hour RTO, with data loss not exceeding the 1-hour RPO, thus meeting the company's stringent data protection requirements for these critical applications.

**NEW QUESTION 86**

A Veeam proxy server is configured as follows. No modifications are allowed to the transport mode.

When performing a restore of a VMware virtual disk using this proxy server, the restore fails. What is a possible cause?

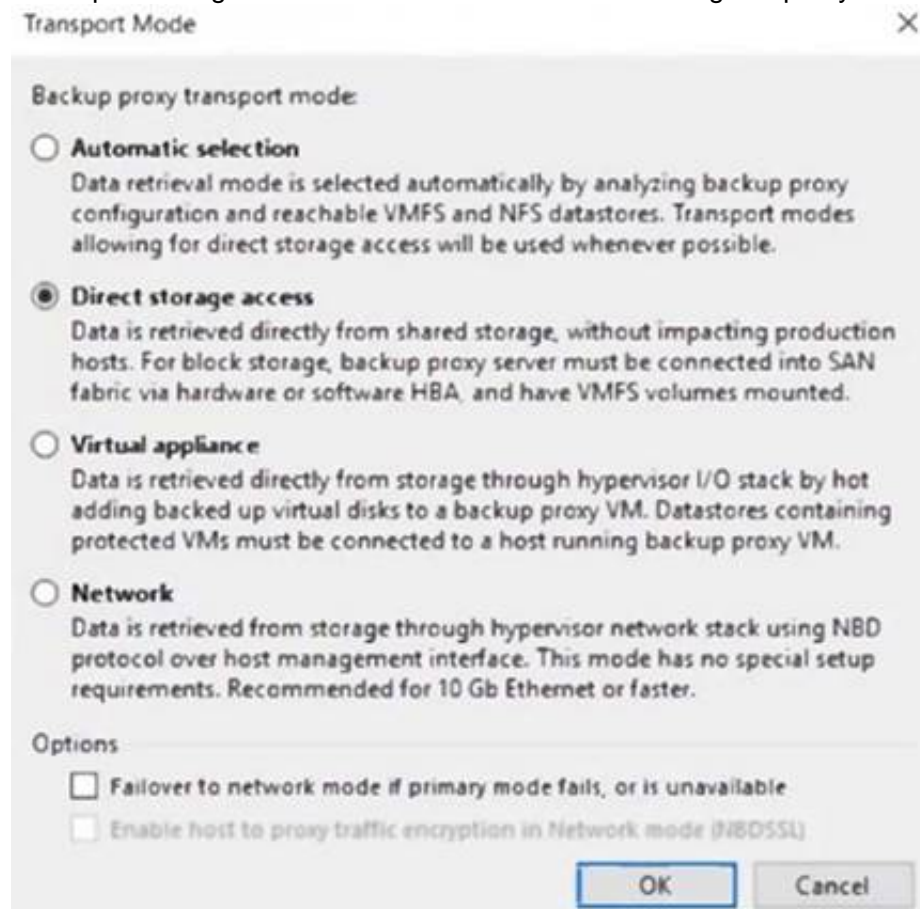

- A. CBT is enabled on the virtual disk.
- B. CBT is disabled on the virtual disk.
- C. The virtual disk is thin-provisioned.
- D. The virtual disk is thick-provisioned

**Answer:** C

**Explanation:**

Given the provided transport modes and the fact that no modifications are allowed to these settings, a possible cause for the restore of a VMware virtual disk to fail using this proxy server is C: The virtual disk is thin-provisioned. In the transport modes shown, the Direct storage access and Virtual appliance options would require the VM disk files to be accessible in a certain way that might not be compatible with thin-provisioned disks depending on the storage configuration and the current state of the VM. If the storage integration specifics or the snapshot handling do not support the thin-provisioned format, the restore operation could fail. It's important to ensure that the transport mode selected is compatible with the type of virtual disk being restored to prevent such issues.

**NEW QUESTION 89**

Veeam Backup and Replication is currently configured with backup jobs that are targeting a local Backup Repository on a Windows Server.

The backups are now configured to run periodically every 6 hours. The engineer wants to create a secondary copy of the backups. However, due to bandwidth and compute restrictions, the copies must be created and transferred only once a day.

Which option should the engineer choose to achieve this goal?

- A. Configure a Hardened Linux Repository, create a Backup Copy job with Periodic Copy (Pruning) mode to this repository and schedule it to run once a day
- B. Add the repository to a Scale-Out Backup repository, extend it with a Public Cloud Object Storage as Capacity tier in copy and move mode, and set the



operational restore window to 7 days

- C. Find a Service Provider with Offsite Backup services, create a Backup Copy job with Immediate Copy (Mirroring) mode to the Service Provider repository
- D. [Add the repository to a Scale-Out Backup repository, extend it with a Public Cloud Object Storage as Capacity tier in copy mode

**Answer:** A

**Explanation:**

To achieve the goal of creating a secondary copy of the backups that is transferred only once a day, the engineer should configure a Hardened Linux Repository and create a Backup Copy job with Periodic Copy (Pruning) mode to this repository, scheduling it to run once a day. This setup respects the bandwidth and compute limitations while ensuring a daily copy of the backups. References: Veeam Backup & Replication User Guide, Veeam Backup Copy Job Configuration Guide

**NEW QUESTION 91**

A physical Linux file server needs to be migrated to VMware ESXi. The server has several volumes: /dev/sda (60GB), /dev/sdb (1TB) and /dev/sdc (4TB). What is the quickest option to migrate the server?

- A. Create an empty VM and perform bare metal recovery inside the VM.
- B. Perform Instant VM Recovery.
- C. Perform Instant Disk Recovery for each volume.
- D. Export all disks, create an empty VM and attach the disks.

**Answer:** B

**Explanation:**

The quickest option for migrating a physical Linux file server with multiple volumes to VMware ESXi is to perform Instant VM Recovery. This feature allows you to run the server directly from the backup file in a VMware environment, significantly reducing the time and complexity involved in migration. References: Veeam Backup & Replication User Guide, Veeam Instant VM Recovery for Physical Servers

**NEW QUESTION 94**

The engineer needs to back up sensitive data located on VMware vSphere encrypted VMs. The company policy prioritizes data security over anything else.

In the backup infrastructure, the engineer has configured:

One physical proxy configured on the DirectSAN Access transport mode, for fast data transfer speed and less load on the production network  
Two physical proxies in NBDSSL  
Encryption has been enabled on the backup job

Which action will allow the VM data to remain encrypted during the entire backup process?

- A. Configure Global Network Traffic Rules to encrypt the backup traffic.
- B. Configure the job to use the proxies with the NBDSSL transport mode.
- C. Configure the job to use the proxy with the DirectSAN Access transport mode.
- D. Upload a custom script that re-encrypts the VM data after the backup job.

**Answer:** B

**Explanation:**

To ensure that the VM data remains encrypted throughout the backup process, the job should be configured to use the proxies with the NBDSSL (Network Block Device SSL) transport mode. This mode encrypts data transferred over the network, adhering to the company policy that prioritizes data security. While DirectSAN Access is fast, it does not provide encryption of in-flight data. References:

? Veeam Backup & Replication User Guide: Transport Modes

? Veeam Best Practices: Securing Backup Traffic

**NEW QUESTION 99**

A daily backup job for seven Hyper-V VMs has been configured at the main site, keeping 14 days' worth of backup files. They want to get a copy of the VM backups to a repository at the disaster recovery site. They want to keep six months' worth of backup files at the disaster recovery site. They also need to be able to restore the VMs to any given day within two months and any given week within the six months. How should a backup copy job be configured to meet these requirements?

- A. Use periodic copy (pruning) mode, keeping 62 days of retention and six monthly GFS restore points.
- B. Use immediate copy (mirroring) mode, keeping 180 days of retention.
- C. Use periodic copy (pruning) mode, keeping 180 days of retention.
- D. Use immediate copy (mirroring) mode, keeping 62 days of retention and 26 weekly GFS restore points.

**Answer:** A

**Explanation:**

To meet the specified requirements, configuring a backup copy job in periodic copy (pruning) mode with 62 days of retention and six monthly Grandfather- Father-Son (GFS) restore points is the best approach. This setup allows for daily backups for up to two months and weekly backups for up to six months, aligning with the desired restore capabilities. References: Veeam Backup & Replication User Guide, Veeam GFS Retention Policy Explanation

**NEW QUESTION 103**

An administrator is asked to change a backup copy job from periodic mode to immediate mode. How can this be accomplished?

- A. Enable immediate in the backup copy job settings drop down.
- B. Right click on the job name and choose immediate.
- C. Copy the original backup copy job to a different folder and remap the job.
- D. Create a new backup copy job and delete the original job.

**Answer:** D

**Explanation:**



To change a backup copy job from periodic mode to immediate mode, the most straightforward approach is D: Create a new backup copy job and delete the original job. Veeam Backup & Replication does not directly allow changing the mode of an existing backup copy job from periodic to immediate within the job settings. Therefore, the recommended practice is to set up a new backup copy job with the desired settings, in this case, immediate mode, which starts copying backups as soon as they are created by the primary backup job. After the new backup copy job is configured and tested to confirm it meets the requirements, the original periodic mode job can be safely deleted. This ensures a seamless transition to the immediate mode operation without risking data protection consistency or coverage.

**NEW QUESTION 104**

An engineer needs to make sure that a backup job includes both the virtual machine's disk files and the Microsoft SQL database transaction logs. Which backup feature in Veeam Backup and Replication should be used?

- A. Guest file system indexing
- B. Crash consistent mode
- C. App consistent mode
- D. Application-aware processing

**Answer:** D

**Explanation:**

To ensure that a backup job includes both the virtual machine's disk files and the Microsoft SQL database transaction logs, Application-aware processing should be used. This feature enables Veeam Backup & Replication to create transactionally consistent backups of VMs running VSS-aware applications like Microsoft SQL Server, ensuring that both the VM disks and the SQL transaction logs are properly backed up. References: Veeam Backup & Replication User Guide, Veeam Application-Aware Processing Guide

**NEW QUESTION 109**

A backup of a Windows VM running on a VMware cluster has been created. In which scenario can the Quick Rollback option be used during a Full VM Restore of the VM?

- A. Migration of VM to VMware host in a different data center
- B. Issues caused by storage data corruption
- C. Migration of VM to Hyper-V host in the same data center
- D. Issues caused by VM guest user error

**Answer:** D

**Explanation:**

The Quick Rollback feature can be used during a Full VM Restore to restore only the changed blocks of data since the last backup. This is typically used when the issues are minor and have been caused by VM guest user error, rather than full-scale data corruption or migrations to a different virtualization host. Quick Rollback can efficiently restore the VM to its previous state without the need to transfer the entire VM's data. References:

? Veeam Backup & Replication User Guide: Quick Rollback

? Veeam Help Center: Performing Quick Rollback

**NEW QUESTION 110**

For Veeam agent backup jobs, what feature is only available with Veeam Agent for Microsoft Windows?

- A. Application-aware processing of
- B. Backup from storage snapshots
- C. Volume backup
- D. File-level backup

**Answer:** A

**Explanation:**

Application-aware processing is a feature exclusive to Veeam Agent for Microsoft Windows. It allows for the creation of consistent backups of Windows-based applications and ensures that databases and applications like Microsoft Active Directory, SQL Server, Exchange, and SharePoint are quiesced and in a consistent state when being backed up. References:

? Veeam Agent for Microsoft Windows User Guide: Application-Aware Processing

? Veeam Help Center: Application-Aware Processing in Veeam Agent for Windows

**NEW QUESTION 114**

A backup administrator decided to move the Veeam Backup & Replication server and configuration database to new servers. Which configuration restore mode should be used?

- A. Restore
- B. Planned failover
- C. Failover plan
- D. Migrate

**Answer:** A

**Explanation:**

When moving the Veeam Backup & Replication server and its configuration database to new hardware or servers, the appropriate process to undertake is a configuration restore, denoted by option A: Restore. This process involves using the Veeam Backup & Replication Configuration Backup utility, which regularly backs up the configuration of the Veeam Backup & Replication server. In the event of a hardware migration or significant system change, this utility allows administrators to restore the server's configuration, including all settings, job configurations, and inventory, onto the new server setup. This ensures a seamless transition with minimal disruption to the backup operations and policies that were previously in place.

**NEW QUESTION 115**

An engineer sets up a backup job with direct backup to the AWS S3. The retention of the job is set to 31 days and the immutable period is set to 31 days. However, one full backup data is not removed automatically after 60 days. Which option could be the reason for this?

- A. The backup job is disabled accidentally.
- B. The backup data is encrypted.
- C. It is an active full backup, not synthetic full.
- D. A retention exception is enabled for the restore point.

**Answer:** D

**Explanation:**

In Veeam Backup & Replication, an immutable backup means that the backup data cannot be modified or deleted during the specified immutable period. However, even with immutability enabled, once the period expires, the data should be automatically subject to the defined retention policy. If a backup still persists beyond the retention period, a likely explanation is that a retention lock or exception has been applied to that particular restore point, preventing it from being deleted. Other listed reasons wouldn't typically prevent the deletion of the backup file after the immutable period has lapsed.

**NEW QUESTION 116**

What is a Recovery Point Objective (RPO) in regards to disaster recovery?

- A. The number of recovery points created during the backup process
- B. The acceptable data loss measured in time that can be tolerated
- C. The maximum amount of time it takes to restore a system
- D. The total cost associated with recovering a system

**Answer:** B

**Explanation:**

In the context of disaster recovery, the Recovery Point Objective (RPO) is best defined by option B: The acceptable data loss measured in time that can be tolerated. RPO is a critical metric in disaster recovery and business continuity planning that specifies the maximum amount of data (measured in time) that an organization can afford to lose in the event of a disaster or system failure. It effectively sets the limit for how frequently data backups or replications should occur. For instance, an RPO of 4 hours means that the organization must be able to recover data from no more than 4 hours prior to the disaster, implying that backup or replication operations should occur at least every 4 hours. Establishing an RPO is essential for developing an effective data protection strategy, as it guides the choice of backup methodologies and technologies to meet the organization's tolerance for data loss.

**NEW QUESTION 121**

.....

## Thank You for Trying Our Product

### We offer two products:

1st - We have Practice Tests Software with Actual Exam Questions

2nd - Questions and Answers in PDF Format

### VMCE\_v12 Practice Exam Features:

- \* VMCE\_v12 Questions and Answers Updated Frequently
- \* VMCE\_v12 Practice Questions Verified by Expert Senior Certified Staff
- \* VMCE\_v12 Most Realistic Questions that Guarantee you a Pass on Your FirstTry
- \* VMCE\_v12 Practice Test Questions in Multiple Choice Formats and Updatesfor 1 Year

**100% Actual & Verified — Instant Download, Please Click**  
**[Order The VMCE\\_v12 Practice Test Here](#)**