



Microsoft

Exam Questions AB-730

AI Business Professional

NEW QUESTION 1

You have a Microsoft 365 Copilot license.
You plan to run several prompts.

What should you use to ensure that Copilot generates the best response for each prompt? More than one answer choice may achieve the goal. To answer, select the Best options in the answer area.

NOTE: Each correct selection is worth one point.

Answer Area

Prompt 1: From /Feedback_Q1–Q3.xlsx, consolidate all the sheets, categorize the feedback by theme, compute the positive/negative sentiment by product line, and visualize the top five drivers.

The Analyst agent
 Chat
 The Researcher agent

Prompt 2: Using our SharePoint folder '/Go-To-Market/2025' and reputable web sources, produce a 1-page brief about AI trends that includes five key insights, citations, and callouts on gaps/risks.

The Analyst agent
 Chat
 The Research agent

Prompt 3: For a VP, prepare a polished executive email that distills the strategic priorities, critical decisions, and immediate next steps from the attached Strategic_Plan_2025.docx, ensuring that the tone aligns with senior leadership's communication standards.

The Analyst agent
 Chat
 The Researcher agent

- A. Mastered
- B. Not Mastered

Answer: A

Explanation:

Answer Area

Prompt 1: From /Feedback_Q1–Q3.xlsx, consolidate all the sheets, categorize the feedback by theme, compute the positive/negative sentiment by product line, and visualize the top five drivers.

The Analyst agent
 Chat
 The Researcher agent

Prompt 2: Using our SharePoint folder '/Go-To-Market/2025' and reputable web sources, produce a 1-page brief about AI trends that includes five key insights, citations, and callouts on gaps/risks.

The Analyst agent
 Chat
 The Research agent

Prompt 3: For a VP, prepare a polished executive email that distills the strategic priorities, critical decisions, and immediate next steps from the attached Strategic_Plan_2025.docx, ensuring that the tone aligns with senior leadership's communication standards.

The Analyst agent
 Chat
 The Researcher agent

NEW QUESTION 2

You plan to summarize a proposal for a partnership between your company and another company.

You need to use Microsoft 365 Copilot to summarize the information in the proposal as a bulleted list of three to five key points for a project kickoff meeting. Each bullet point must be concise and simply worded.
 Which two details should you include in the prompt?

- A. profiles of both companies generated by using the Researcher agent
- B. concise instructions for what to do with the proposal
- C. a list of contact details for key stakeholders of the partnership
- D. a specific knowledge source to ground the response

Answer: BD

Explanation:

Effective prompting in Microsoft 365 Copilot requires two critical components: clear instructions and grounding in authoritative content. Microsoft guidance emphasizes that prompts should explicitly state the desired output format, tone, length, and purpose. In this case, specifying "a bulleted list of three to five concise, simply worded key points" represents concise instructions, making option B essential. Additionally, grounding the response in a specific knowledge source—such as attaching or referencing the proposal document—ensures factual accuracy and reduces hallucination. Option D ensures Copilot uses the actual proposal content rather than relying on generalized model knowledge. Profiles and stakeholder contact details are unrelated to summarization requirements. Therefore, the correct selections are B and D.

=====

NEW QUESTION 3

You use the Researcher agent in Microsoft 365 Copilot to generate a report.
 What can you use to verify whether the report was generated by using valid sources?

- A. citations
- B. instructions
- C. memory
- D. capabilities

Answer: A

Explanation:

The Researcher agent in Microsoft 365 Copilot is designed to gather and synthesize information from web and organizational sources. To support transparency and trust, Copilot provides citations alongside generated content when external or referenced material is used. Citations allow users to review the original sources that informed the generated report. This aligns with Microsoft's Responsible AI commitment to transparency and verifiability. By selecting or reviewing citations, users can confirm that the information originates from credible and relevant references rather than unsupported model-generated text. Instructions define how the agent behaves but do not validate source authenticity. Memory refers to conversational context retention and does not confirm source validity. Capabilities describe what the agent can do, not whether its output is grounded in legitimate sources. Therefore, to verify that a report generated by the Researcher agent uses valid sources, you should review the citations.

NEW QUESTION 4

Select the answer that correctly completes the sentence.

Answer Area

You are creating an agent in the Microsoft 365 Copilot app. The agent persona must be warm and friendly. To set the persona, you should modify the

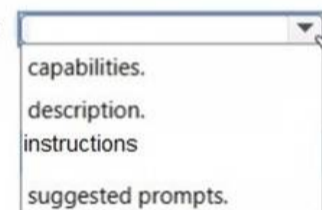

- A. Mastered
- B. Not Mastered

Answer: A

Explanation:

The correct answer is instructions because an agent's persona—such as being warm, friendly, formal, or analytical—is defined through its behavioral and communication guidance. In Microsoft 365 Copilot, the Instructions field controls how the agent responds, including tone, style, personality, response structure, and interaction patterns. The description typically explains what the agent does, not how it communicates. Capabilities define what tasks the agent can perform, such as summarizing documents or analyzing data. Suggested prompts provide example user queries but do not control the agent's personality or communication style. To establish a warm and friendly persona, the instructions should explicitly state guidance such as: "Respond in a supportive, conversational tone. Use clear and positive language. Be encouraging and approachable." This ensures consistent tone across all interactions. Defining persona through instructions reflects prompt engineering best practices in generative AI, enabling predictable behavior, improved user experience, and alignment with organizational communication standards within Microsoft 365 Copilot environments.

NEW QUESTION 5

You are creating a custom agent in the Microsoft 365 Copilot app for the marketing team at your company. The agent will be used to produce marketing collateral, including copy, logos, and artwork.
 What should you add to the agent? More than one answer choice may achieve the goal. Select the BEST answer.

- A. a template
- B. a suggested prompt
- C. image generator
- D. code interpreter

Answer: C

Explanation:

When building a custom agent in Microsoft 365 Copilot for marketing use cases, the required capabilities must align with the intended outputs. Marketing collateral includes written copy as well as visual assets such as logos and artwork. According to Microsoft AI Business Professional documentation, generative AI solutions that produce visual creative assets require integrated image generation capabilities powered by multimodal AI models.

Option C is correct because an image generator enables the agent to create visual marketing materials such as logos, artwork, and design elements. While templates and suggested prompts can improve usability and consistency, they do not provide the underlying capability to generate images. A code interpreter is designed for data analysis, calculations, or technical scripting tasks and is not relevant to creative marketing asset production. Therefore, to fulfill the requirement of producing both textual and visual marketing collateral, the most essential addition to the custom agent is an image generator.

NEW QUESTION 6

Select the answer that correctly completes the sentence.

Answer Area

Overreliance is a common risk associated with generative AI, where

users exploit vulnerabilities to elicit unauthorized behavior.

the model is tricked into exposing confidential information.

the model generates misleading, inaccurate, or irrelevant content.

users accept the AI-generated output without verifying its accuracy

- A. Mastered
- B. Not Mastered

Answer: A

Explanation:

Answer Area

Overreliance is a common risk associated with generative AI, where

users exploit vulnerabilities to elicit unauthorized behavior.

the model is tricked into exposing confidential information.

the model generates misleading, inaccurate, or irrelevant content.

users accept the AI-generated output without verifying its accuracy

NEW QUESTION 7

You use Microsoft 365 Copilot.
 You discover that you had a conversation that used a knowledge source that contains confidential information.
 You need to delete the conversation data without requiring administrative approval. You must retain your other conversations, if possible.
 What should you use?

- A. the Microsoft 365 Copilot app
- B. the Microsoft 365 admin center
- C. the Microsoft Purview compliance portal
- D. the My Account portal in Microsoft 365 Copilot

Answer: D

Explanation:

Microsoft 365 Copilot follows Microsoft's enterprise data governance and privacy principles, which allow users to manage their own conversation history where appropriate. According to Microsoft AI Business Professional guidance, users can review and delete individual Copilot conversation histories directly from their personal account settings without requiring administrative intervention.

Option D is correct because the My Account portal in Microsoft 365 Copilot allows individual users to manage their activity history, including deleting specific conversations. This enables targeted removal of sensitive interactions while retaining other conversation data. Option A is incorrect because the Copilot app itself does not provide full account-level activity management capabilities. Options B and C are administrative tools used for tenant-wide governance, compliance, retention policies, and eDiscovery. These portals typically require administrative privileges and are not intended for individual user self-service deletion of specific conversations. Therefore, to delete a single confidential Copilot conversation without affecting other chats and without requiring administrator approval, the correct tool is the My Account portal in Microsoft 365 Copilot.

NEW QUESTION 8

You use Microsoft 365 Copilot.
 You regularly upload the same five files to Copilot chats.
 You need to simplify referencing the files in the chats.
 What are two ways to achieve the goal?

- A. Send a prompt that includes the files, and then save the prompt.

- B. Create a notebook that references the files.
- C. Ask the data engineers to create a fine-tuned model.
- D. Create an agent that has a knowledge source.
- E. Zip the documents and upload the ZIP file to the chats.

Answer: BD

Explanation:

Microsoft 365 Copilot provides structured ways to persist and reuse knowledge sources to avoid repeatedly uploading the same files. Creating a notebook that references the five files (Option B) allows those documents to remain attached within a persistent workspace. Copilot can then consistently ground responses in those files without re-uploading them for every conversation. Creating an agent with a defined knowledge source (Option D) also provides a reusable solution. By configuring the five files as part of the agent's knowledge base, the agent can automatically reference them in future interactions. Saving a prompt does not persist file attachments. Fine-tuning models is not part of standard Microsoft 365 Copilot user workflows. Uploading a ZIP file does not improve reference management and may reduce accessibility of individual documents. Therefore, the correct solutions are to create a notebook that references the files and to create an agent with a knowledge source.

NEW QUESTION 9

You plan to use a notebook in Microsoft 365 Copilot. What is the purpose of a notebook?

- A. to create a transcript of a conversation that you can easily email to other users
- B. to provide a private location that can be used to organize reference materials across related conversations
- C. to generate a summary of all the interactions you had with Copilot during a specific conversation

Answer: B

Explanation:

In Microsoft 365 Copilot, a Notebook is a focused, AI-powered workspace designed to organize reference materials for specific projects or topics. It acts as a curated container where you can bring together various resources--such as Word documents, PDFs, PowerPoint decks, meeting notes, and even previous Copilot chats--into one location.

Reference:

<https://support.microsoft.com/en-us/topic/how-microsoft-365-copilot-notebooks-works-4071d73d-8bdd-478f-8968-8dc1d7c3d43e>

NEW QUESTION 10

You need to improve prompt-grounding during a Microsoft 365 Copilot conversation. What is the best approach to achieve the goal? More than one answer choice may achieve the goal. Select the BEST answer.

- A. Use shorter prompt
- B. Provide the desired output form
- C. Avoid technical jargon
- D. Reference specific files.

Answer: D

Explanation:

To significantly improve prompt-grounding and accuracy during a Microsoft 365 Copilot conversation, you should explicitly reference specific files, folders, or emails. While Copilot automatically attempts to ground responses in your Microsoft Graph data, guiding it to precise, authorized sources reduces the risk of generating "ungrounded" (hallucinated) content.

Here are the best practices for referencing files to ground your Copilot prompts:

Methods for Referencing Files

Use the Forward Slash (/): Typing a forward slash (/) followed by the file name in the Copilot chat box is the primary way to bring up a list of relevant, recently used files.

Use the Attachment Icon: Click the attachment icon to browse your OneDrive or SharePoint for specific documents, spreadsheets, or presentations.

Explicit Naming: Use clear, descriptive names. For example: "Summarize the findings in '/ProjectAlpha_Draft.docx'".

Copy/Paste Links: If a file does not appear in the suggestions, open the file in SharePoint or OneDrive, copy the link, and paste it directly into the prompt.

Reference:

<https://www.datastudios.org/post/microsoft-copilot-prompting-techniques-structure-grounding-and-workflow-optimisation>

NEW QUESTION 10

You sign in to the Microsoft 365 Copilot app by using your work account as shown in the following exhibit

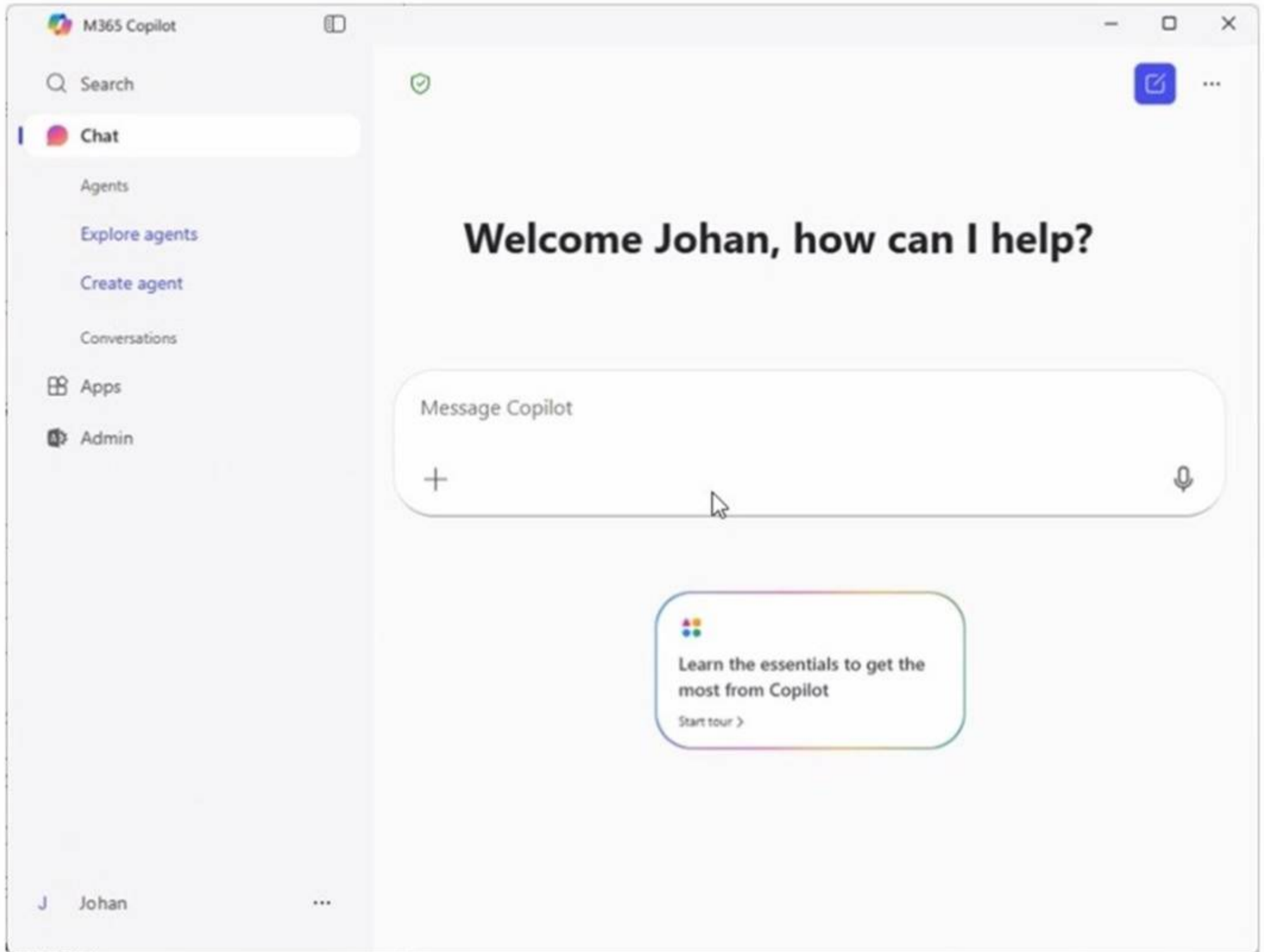

A colleague tells you that when they open the Microsoft 365 Copilot app, they have access to the Researcher agent. You need to access to the Researcher agent. What should you do?

- A. From Microsoft Edge, use your work account to sign in to <https://copilot.microsoft.com>.
- B. Select Explore agents and then search for Researcher.
- C. Sign in to the Copilot app by using a personal account
- D. Request a Microsoft 365 Copilot license from an administrator.

A.

Answer: B

NEW QUESTION 12

HOTSPOT

For each of the following statements, select Yes if the statement is true. Otherwise, select No. NOTE: Each correct selection is worth one point.

Answer Area

| Statements | Yes | No |
|---|-----------------------|-----------------------|
| Prompt injection can cause data exposure and unintended system behavior. | <input type="radio"/> | <input type="radio"/> |
| Prompt injection can be used to embed malicious or harmful instructions. | <input type="radio"/> | <input type="radio"/> |
| Prompt injection is a security vulnerability unique to generative AI systems that interpret and respond to natural language inputs. | <input type="radio"/> | <input type="radio"/> |

- A. Mastered
- B. Not Mastered

Answer: A

Explanation:

Prompt injection is a generative AI security risk where an attacker inserts instructions (often hidden in text, documents, webpages, or user inputs) to override or manipulate the assistant's intended behavior. This can lead to unintended actions such as ignoring policy controls, producing unsafe outputs, or attempting to reveal sensitive information. Because generative AI systems follow natural-language instructions, they can be socially engineered to prioritize malicious content unless safeguards are in place. This is why prompt injection can cause data exposure (for example, attempting to extract confidential content from grounded sources) and can also embed harmful instructions that redirect the model's behavior. In enterprise settings like Microsoft 365 Copilot, mitigations include grounding boundaries, permission trimming, content filtering, and instruction hierarchy (system policies over user instructions). From a business governance perspective, users should treat untrusted inputs (emails, documents, web text) as potentially hostile and apply least-privilege access and validation when using AI outputs in decision-making.

NEW QUESTION 17

HOTSPOT

For each of the following statements, select Yes if the statement is true. Otherwise, select No. NOTE: Each correct selection is worth one point.

Answer Area

| Statements | Yes | No |
|--|-----------------------|-----------------------|
| You can review the Microsoft 365 Copilot activity history from the My Account portal. | <input type="radio"/> | <input type="radio"/> |
| When you delete the Microsoft 365 Copilot activity history, you also immediately delete all the associated notebooks and pages. | <input type="radio"/> | <input type="radio"/> |
| Users can delete their entire Microsoft 365 Copilot activity history, including their prompts and the responses Copilot returns. | <input type="radio"/> | <input type="radio"/> |

- A. Mastered
- B. Not Mastered

Answer: A

Explanation:

Answer Area

| Statements | Yes | No |
|--|----------------------------------|----------------------------------|
| You can review the Microsoft 365 Copilot activity history from the My Account portal. | <input checked="" type="radio"/> | <input type="radio"/> |
| When you delete the Microsoft 365 Copilot activity history, you also immediately delete all the associated notebooks and pages. | <input type="radio"/> | <input checked="" type="radio"/> |
| Users can delete their entire Microsoft 365 Copilot activity history, including their prompts and the responses Copilot returns. | <input checked="" type="radio"/> | <input type="radio"/> |

NEW QUESTION 20

You are a merchandiser who is planning for the upcoming season. You prompt Microsoft 365 Copilot to suggest which products to stock based on historical sales data. Without reviewing the suggestions or checking current market trends, you place a large order based solely on the output of Copilot. What is this an example of?

- A. verification
- B. overreliance
- C. fabrication
- D. prompt injection

Answer: B

NEW QUESTION 23

HOTSPOT - Select the answer that correctly completes the sentence.

Answer Area

You generate a report by using the Researcher agent in Microsoft 365 Copilot. You can use  to save and edit the response.

- A. Mastered
- B. Not Mastered

Answer: A

Explanation:

Answer Area

You generate a report by using the Researcher agent in Microsoft 365 Copilot. You can use  to save and edit the response.

NEW QUESTION 24

You are using Microsoft 365 Copilot to plan a trip and have asked Copilot to remember several details about the trip. You cancel the trip plans. You need to ensure that Copilot forgets the details. What should you do?

- A. From the My Account portal, delete the Copilot activity history.
- B. From Copilot delete custom instructions.
- C. From Copilot delete memories.
- D. From Copilot delete all the conversation about the trip.

Answer: C

Explanation:

Microsoft 365 Copilot includes a memory capability that allows it to retain user-provided preferences or details across interactions when explicitly instructed to remember them. These stored details are referred to as memories and are separate from standard conversation history. If you previously asked Copilot to remember specific trip-related details, those details are stored as structured memory items. Simply deleting the conversation does not necessarily remove stored memory entries. Likewise, deleting activity history through the My Account portal removes conversation records but does not directly manage structured Copilot memories. Custom instructions define persistent behavioral preferences and are unrelated to trip-specific stored data. To ensure Copilot no longer retains those trip details, you must delete the stored memories directly within Copilot. Microsoft documentation explains that users can view and manage saved memories and remove them individually to control what Copilot retains. Therefore, the correct action to ensure Copilot forgets the trip details is to delete the memories.

NEW QUESTION 26

In a Microsoft 365 Copilot conversation, you generate a report, and then edit the report in a page. You need to collaborate with a colleague on the report. What are two ways to achieve the goal?

- A. @mention the colleague in the page.
- B. Add the page to a notebook.
- C. Open the page in Microsoft Word.
- D. Share the page link.

Answer: AD

Explanation:

Microsoft 365 Copilot Pages supports collaboration similarly to other Microsoft 365 documents. Collaboration requires notifying or granting access to colleagues. Using @mentions within the page (Option A) directly notifies the colleague and facilitates collaborative engagement. Sharing the page link (Option D) allows others to access and edit the content according to permissions. These two methods provide complete collaboration workflows. Adding the page to a notebook does not grant collaborative access. Opening the page in Word changes the editing surface but does not inherently enable collaboration unless shared. Therefore, the correct answers are A and D.

=====

NEW QUESTION 27

You are using Microsoft 365 Copilot to enhance your productivity in Microsoft Word.

Which two tasks can you achieve by using Copilot in Word?

- A. Insert a table of contents based on the headings in your document.
- B. Insert a custom watermark that has specific text and formatting.
- C. Generate a summary of the key points in your document.
- D. Customize the page margins to match your company's document standards.

Answer: AC

Explanation:

Copilot in Word assists with content generation, summarization, rewriting, and structural organization. It can analyze document headings and insert a table of contents based on structured heading styles, supporting document navigation. It can also generate summaries of key points, which aligns directly with generative AI text analysis capabilities.

Custom watermark formatting and precise page margin configuration are traditional Word formatting functions and are not core generative AI capabilities of Copilot.

Therefore, the correct answers are A and C.

=====

NEW QUESTION 32

You create a Microsoft 365 Copilot notebook and add a file named Process.docx from a local folder. Yesterday, you updated Process.docx in the local folder. What will occur when you chat in the notebook?

- A. The chat will reference both versions of Process.docx.
- B. The chat will reference the most recent version of Process.docx.
- C. The chat will reference only the original version of Process.docx.

A.

Answer: C

Explanation:

Microsoft 365 Copilot notebooks use the version of a file that was uploaded or attached at the time it was added to the notebook. When a document such as Process.docx is added from a local folder, Copilot references that uploaded snapshot of the file. If the file is later modified locally, the notebook does not automatically sync or refresh with the updated local version unless the updated file is re-uploaded.

Microsoft guidance on grounding and file references explains that Copilot works with the specific content stored in Microsoft 365 or the attached artifact within the notebook session. Since the updated version remains in the local folder and was not reattached, Copilot continues to use the originally added version.

Therefore, during subsequent chats in the notebook, Copilot references only the original uploaded version of Process.docx.

=====

NEW QUESTION 34

You use Microsoft 365 Copilot to generate a training plan.

You need to check if there are any existing training plans in your organization that are similar to the new training plan. What should you use in Copilot?

- A. Search
- B. Designer
- C. Apps
- D. Pages

A.

Answer: A

Explanation:

Microsoft 365 Copilot integrates with Microsoft Search to help users discover relevant content across their organization's Microsoft 365 data estate, including SharePoint, OneDrive, Teams, and Exchange. When the objective is to determine whether similar training plans already exist, the appropriate action is to perform a search across organizational content.

Using Search allows Copilot to query indexed enterprise documents and return files, plans, or related materials that the user has permission to access. This supports content reuse, avoids duplication of work, and aligns with Microsoft's guidance on leveraging organizational knowledge efficiently.

Designer is focused on visual content creation, Apps provides access to Microsoft 365 applications, and Pages is used for creating and organizing content within Copilot. None of these options are intended for discovering existing documents across the tenant.

Therefore, to identify similar existing training plans within your organization, the correct tool to use in Copilot is Search.

=====

NEW QUESTION 35

You are comparing the difference between Microsoft 365 Copilot and Microsoft 365 Copilot Chat.

What is available in both versions?

- A. the Researcher agent
- B. Copilot Pages
- C. Copilot Notebooks

Answer: B

NEW QUESTION 40

You use Microsoft 365 Copilot to create a proposal in Microsoft Word based on a document in a Microsoft SharePoint library.

You need to ensure that the information cited in the proposal is accurate.

What is the best approach to achieve the goal? More than one answer choice may achieve the goal. Select the BEST answer.

- A. Manually verify the citations in the generated content.

- B. Use Copilot in Word to verify the citations.
- C. Create an agent that contains your organization's editorial standards and use the agent to verify the citations.
- D. Create a notebook that contains all the reference material and use the notebook to verify the citations.

Answer: A

NEW QUESTION 43

You run a saved prompt and receive the following response:
"You asked for a summary of File.docx. However, the file appears to be either empty, corrupted, or in a format that I cannot process."
What is a possible cause of the response?

- A. You did NOT schedule the prompt to run.
- B. You ran the prompt from a web app instead of a desktop app.
- C. You used the wrong agent to run the prompt.
- D. You do NOT have access to the file.

Answer: D

NEW QUESTION 44

HOTSPOT
Select the answer that correctly completes the sentence.

Answer Area

If you start a temporary chat in Microsoft 365 Copilot, and then start a new chat, all the prompts and responses from the temporary chat will be

- deleted immediately
- deleted after one hour.
- moved to a private notebook.
- moved to your Microsoft OneDrive.

- A. Mastered
- B. Not Mastered

Answer: A

Explanation:

Answer Area

If you start a temporary chat in Microsoft 365 Copilot, and then start a new chat, all the prompts and responses from the temporary chat will be

- deleted immediately
- deleted after one hour.
- moved to a private notebook.
- moved to your Microsoft OneDrive.

NEW QUESTION 48

HOTSPOT
From Microsoft 365 Copilot, you add custom instructions.
For each of the following statements, select Yes if the statement is true. Otherwise, select No.
NOTE: Each correct selection is worth one point.

| Statements | Yes | No |
|---|-----------------------|-----------------------|
| The instructions will apply to new chat conversations. | <input type="radio"/> | <input type="radio"/> |
| The instructions will apply to new conversations with the Researcher agent and the Analyst agent. | <input type="radio"/> | <input type="radio"/> |
| The instructions will apply to previous responses in existing conversation. | <input type="radio"/> | <input type="radio"/> |

- A. Mastered
- B. Not Mastered

Answer: A

Explanation:

| Statements | Yes | No |
|---|----------------------------------|----------------------------------|
| The instructions will apply to new chat conversations. | <input checked="" type="radio"/> | <input type="radio"/> |
| The instructions will apply to new conversations with the Researcher agent and the Analyst agent. | <input checked="" type="radio"/> | <input type="radio"/> |
| The instructions will apply to previous responses in existing conversation. | <input type="radio"/> | <input checked="" type="radio"/> |

NEW QUESTION 52

You sign in to the Microsoft 365 Copilot app by using your work account as shown in the exhibit.

A colleague tells you that when they open the Microsoft 365 Copilot app, they have access to the Researcher agent. You need to access the Researcher agent. What should you do?

- A. From Microsoft Edge, use your work account to sign in to <https://copilot.microsoft.com>.
- B. Select Explore agents and then search for Researcher.
- C. Sign in to the Copilot app by using a personal account.
- D. Request a Microsoft 365 Copilot license from an administrator.

Answer: B

NEW QUESTION 54

HOTSPOT

What are two limitations of prompt scheduling in Microsoft 365 Copilot? To answer, select the appropriate options in the answer area.

NOTE: Each correct selection is worth one point.

You can schedule the prompt to run as often as:

- Once per hour
- Once per day**
- Once per week

The maximum number of times that a scheduled prompt can run is:

- 15 times**
- 365 times
- Unlimited

- A. Mastered
- B. Not Mastered

Answer: A

Explanation:

You can schedule the prompt to run as often as:

- Once per hour
- Once per day**
- Once per week

The maximum number of times that a scheduled prompt can run is:

- 15 times**
- 365 times
- Unlimited

NEW QUESTION 57

You attend many Microsoft Teams meetings.

You want to ensure that you can catch up on key points and next steps after each meeting. Which Microsoft 365 Copilot feature should you use after the

meetings?

- A. Recap
- B. Meeting Whiteboard
- C. Meeting info
- D. Thread summaries

Answer: A

NEW QUESTION 59

HOTSPOT

For each of the following statements, select Yes if the statement is true. Otherwise, select No. NOTE: Each correct selection is worth one point.

Answer Area

| Statements | Yes | No |
|---|-----------------------|-----------------------|
| Microsoft 365 Copilot is trained on your organization's business data. | <input type="radio"/> | <input type="radio"/> |
| Microsoft 365 Copilot can summarize emails in mailboxes that were shared with you. | <input type="radio"/> | <input type="radio"/> |
| Microsoft 365 Copilot leverages the security framework defined in Microsoft 365 to provide you with access to emails, documents, and other enterprise data. | <input type="radio"/> | <input type="radio"/> |

- A. Mastered
- B. Not Mastered

Answer: A

Explanation:

Answer Area

| Statements | Yes | No |
|---|----------------------------------|----------------------------------|
| Microsoft 365 Copilot is trained on your organization's business data. | <input type="radio"/> | <input checked="" type="radio"/> |
| Microsoft 365 Copilot can summarize emails in mailboxes that were shared with you. | <input checked="" type="radio"/> | <input type="radio"/> |
| Microsoft 365 Copilot leverages the security framework defined in Microsoft 365 to provide you with access to emails, documents, and other enterprise data. | <input checked="" type="radio"/> | <input type="radio"/> |

NEW QUESTION 63

You open Microsoft 365 Copilot as shown in the exhibit. What can you infer about the Standings conversation?

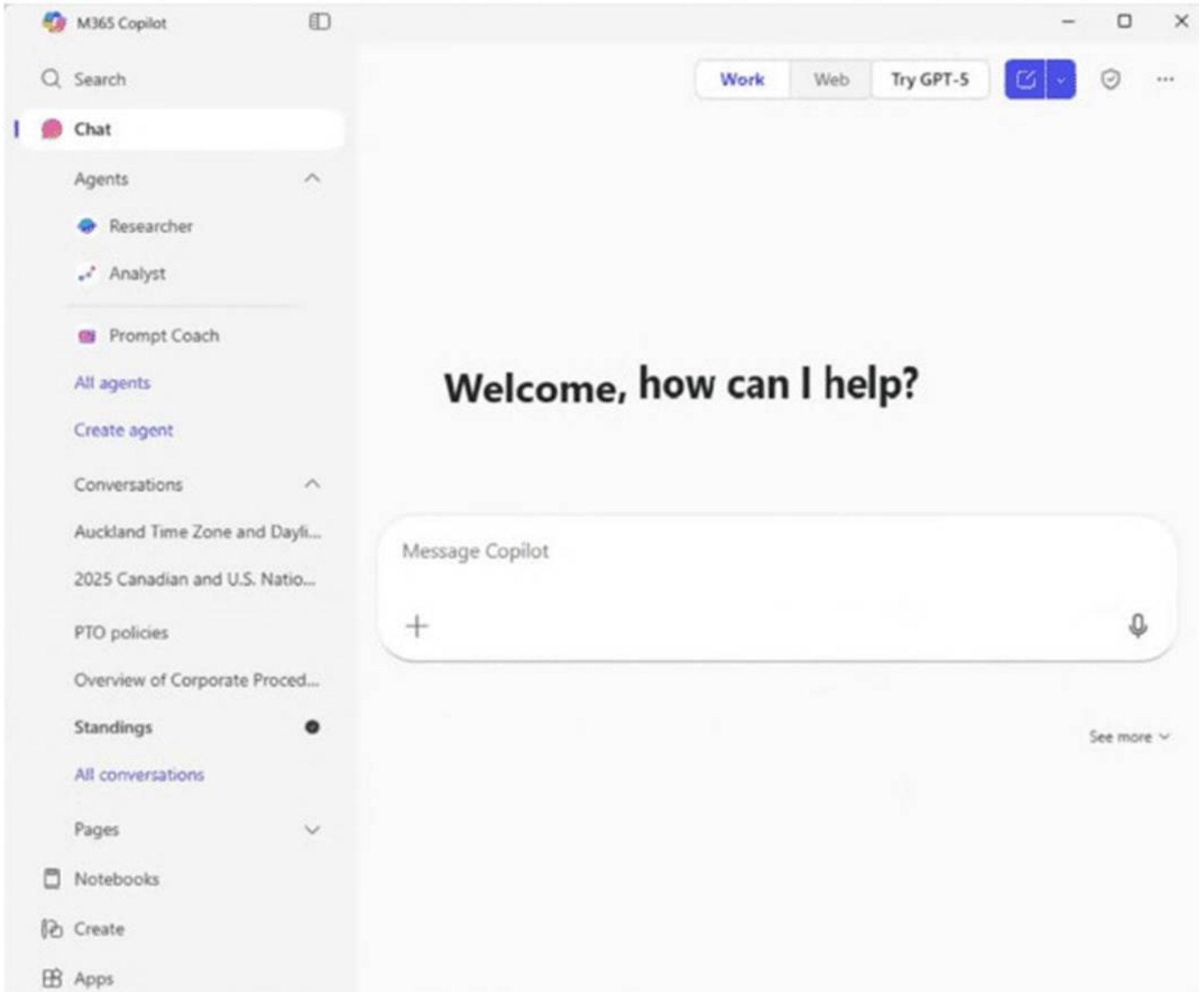

- A. The conversation contains only anonymous data.
- B. The conversation contains a verified response.
- C. The conversation was added to a notebook.
- D. The conversation contains a scheduled prompt.
- E. The conversation was shared.

Answer: B

NEW QUESTION 67

HOTSPOT

You have a Microsoft 365 subscription.

You do NOT have a Microsoft 365 Copilot license.

For each of the following statements, select Yes if the statement is true. Otherwise, select No.

NOTE: Each correct selection is worth one point.

Answer Area

Statements

| | Yes | No |
|---|-----------------------|-----------------------|
| Microsoft 365 Copilot Chat lets you upload documents from your local computer. | <input type="radio"/> | <input type="radio"/> |
| Microsoft 365 Copilot Chat is included with Microsoft 365 Business Standard. | <input type="radio"/> | <input type="radio"/> |
| Microsoft 365 Copilot Chat lets you create and use agents that can access Microsoft SharePoint folders. | <input type="radio"/> | <input type="radio"/> |

- A. Mastered
- B. Not Mastered

Answer: A

Explanation:

| Answer Area | | |
|---|-------------------------------------|-------------------------------------|
| Statements | Yes | No |
| Microsoft 365 Copilot Chat lets you upload documents from your local computer. | <input checked="" type="checkbox"/> | <input type="checkbox"/> |
| Microsoft 365 Copilot Chat is included with Microsoft 365 Business Standard. | <input checked="" type="checkbox"/> | <input type="checkbox"/> |
| Microsoft 365 Copilot Chat lets you create and use agents that can access Microsoft SharePoint folders. | <input type="checkbox"/> | <input checked="" type="checkbox"/> |

NEW QUESTION 69

.....

Thank You for Trying Our Product

We offer two products:

1st - We have Practice Tests Software with Actual Exam Questions

2nd - Questions and Answers in PDF Format

AB-730 Practice Exam Features:

- * AB-730 Questions and Answers Updated Frequently
- * AB-730 Practice Questions Verified by Expert Senior Certified Staff
- * AB-730 Most Realistic Questions that Guarantee you a Pass on Your FirstTry
- * AB-730 Practice Test Questions in Multiple Choice Formats and Updatesfor 1 Year

100% Actual & Verified — Instant Download, Please Click
[Order The AB-730 Practice Test Here](#)