

VEEAM

Exam Questions VMCE_v12

Veeam Certified Engineer v12



NEW QUESTION 1

The compliance team is requesting a Veeam engineer complete the following tasks on the backup environment:

- * 1. All image-level backups are to be tested and validated
- * 2. Recovery verification with a well-known malware scan
- * 3. Send an email to the Veeam engineer with test results

What is the recovery verification function to meet this requirement?

- A. On-Demand Sandbox
- B. SureBackup
- C. Quick Migration
- D. SureReplica

Answer: B

Explanation:

SureBackup is the Veeam technology that allows you to verify the recoverability of backups. It can automatically verify the integrity of the backup, test it for malware (with the aid of third-party antivirus software), and send email notifications upon the completion of the job. This is accomplished by running the backups in an isolated environment called a Virtual Lab, without making any changes to the actual production environment. By using SureBackup, Veeam engineers can ensure that image-level backups are recoverable, can be verified against malware, and can report the results via email, thus meeting the compliance team's requests.

NEW QUESTION 2

A customer wants to set up a Scale-Out Backup Repository. Due to malware concerns, immutability is recommended. An on-premises server can be used to hold primary backups, but it can only hold about 21 days of backups. A copy of the backups should be stored in AWS. The retention for all backups is 60 days. Which configuration of a Scale-out Backup repository meets these requirements?

- A. Copy mode Performance Tier: Windows REFS, immutability set for 11 days Capacity Tier: Amazon S3, immutability set for 60 days
- B. Copy and move mode Performance Tier: Windows REFS, immutability set for 11 days Capacity Tier: Amazon S3, immutability set for 60 days
- C. Copy mode Performance Tier: Linux Hardened Repository, XFS, immutability set for 11 days Capacity Tier: Amazon S3, immutability set for 60 days
- D. Copy and move mode Performance Tier: Linux Hardened Repository, XFS, immutability set for 11 days Capacity Tier: Amazon S3, immutability set for 60 days

Answer: D

Explanation:

To meet the requirements of setting up a Scale-Out Backup Repository (SOBR) with immutability for malware protection and specific retention policies, the most fitting configuration is D: Copy and move mode with a Performance Tier configured on a Linux Hardened Repository using the XFS file system and immutability set for 21 days, and a Capacity Tier on Amazon S3 with immutability set for 60 days. This setup utilizes the copy and move mode to ensure that backups are first stored on the on-premises Linux Hardened Repository with an immutability setting that prevents modifications to backups, providing protection against malware for the most recent 21 days of backups. As this on-premises server has limited capacity, older backups beyond 21 days are moved to the Capacity Tier in Amazon S3, where they are also protected with immutability for the entire 60-day retention period. This configuration leverages the strengths of both on-premises and cloud storage while ensuring that all backups are protected from modification or deletion by immutability, aligning with the customer's malware protection concerns and retention requirements.

NEW QUESTION 3

A corporation needs to give their MS SQL DBAs a way to restore their MS SQL databases.

Which action would allow the corporation to grant this access without giving access to other operations?

- A. Deny access to restore VMs in Enterprise Manager
- B. Give the DBA group Restore Operator access to the backup server
- C. Give the DBA group Restore Operator access to MS SQL DBs in Enterprise Manager
- D. Delegate application item recoveries to the DBA Group

Answer: C

Explanation:

To grant MS SQL DBAs the ability to restore their databases without giving access to other operations, the appropriate action is to give the DBA group Restore Operator access specifically to MS SQL databases within Veeam Enterprise Manager. This role-based access control allows DBAs to perform the needed restores while restricting access to other functionality. References:

- ? Veeam Backup & Replication User Guide: Role-Based Access Control
- ? Veeam Enterprise Manager Guide: Delegating Restore Operations

NEW QUESTION 4

Which feature can be used in Veeam Explorer for Microsoft Exchange?

- A. Export to BAK file
- B. Restore databases from backups created with Veeam RMAN plug-in
- C. Recover from litigation and in-place hold items
- D. Restore original password for account objects

Answer: C

Explanation:

Veeam Explorer for Microsoft Exchange allows recovery of items that are under litigation hold or in-place hold. This feature is essential for compliance and legal discovery processes where emails and other items need to be preserved and may be subject to eDiscovery requests. It is not used for restoring databases from backups created with Veeam RMAN plug-in, exporting to BAK files, or restoring original passwords for account objects. References:

- ? Veeam Explorer for Microsoft Exchange User Guide: Working with Items under Litigation Hold
- ? Veeam Knowledge Base: Recovery of Exchange Items

NEW QUESTION 5

Management asks a backup administrator to deploy the Veeam Agent on a number of Amazon EC2 instances running Windows and Linux operating systems. A Veeam Protection Group is also required by management. The Veeam Distribution Server does not have network access to these instances. What protection group type should be used to select these objects?

- A. Individual computers
- B. Microsoft Active Directory objects
- C. Computers listed in a CSV file
- D. Cloud machines

Answer: D

Explanation:

For deploying the Veeam Agent on Amazon EC2 instances running Windows and Linux operating systems without direct network access from the Veeam Distribution Server, the appropriate type of Protection Group to use is D: Cloud machines. The "Cloud machines" protection group type in Veeam Backup & Replication is specifically designed for protecting cloud-based workloads, including instances in public cloud environments like Amazon EC2. This protection group type allows the Veeam Agent to be deployed and managed remotely, even when the Veeam Distribution Server cannot directly access the instances over the network. It facilitates centralized management of backup tasks for cloud instances, ensuring that the EC2 instances are adequately protected as per management's request, despite the network accessibility constraints.

NEW QUESTION 6

A request to protect some new domain controllers has been submitted in the ticketing system. The engineer creates a backup job with the following steps:

- * 1. Right-clicks on the Jobs navigation item on the left
- * 2. Selects VMware vSphere from the menu
- * 3. Enters a name for the job.
- * 4. Selects workloads to protect.
- * 5. Defines a job schedule.
- * 6. Clicks the Finish button.

When testing restores, the engineer finds that the backups are crash-consistent. Which set of steps should the engineer use to avoid crash-consistent backups for the domain controllers?

- A. Launch the New Backup Job Wizard
- B. Enter a name for the job
- C. Select workloads to protect
- D. Choose a destination
- E. Enable the Application-Aware checkbox and configure settings
- F. Define a job schedule
- G. Click the Finish button.
- H. Launch the New Backup Job Wizard
- I. Enter a name and a description
- J. Select a resource pool to protect
- K. Specify a backup repository with copy-mode enabled
- L. Define a job schedule
- M. Click the Finish button.
- N. Launch the New Backup Job Wizard. Enter a name for the job. Specify a backup repository.
- O. Specify Guest Processing settings
- P. Define a job schedule. Click the Finish button.
- Q. Launch the New Backup Job Wizard. Enter a name or description for the job.
- R. Select the vSphere environment to protect
- S. Choose the Default Backup Repository. Check the box labeled "Run the job when I click Finish". Specify Guest Processing settings
- T. Define a job schedule.

Answer: A

Explanation:

Application-aware processing is a feature in Veeam Backup & Replication that creates transactionally consistent backup images of VMs. For domain controllers, this feature ensures that backups are consistent with the applications running on the VM, like Active Directory services. To avoid crash-consistent backups and ensure application consistency, the engineer must enable the Application-Aware Processing option during the job configuration. References:

- ? Veeam Backup & Replication User Guide: Application-Aware Processing
- ? Veeam Best Practices: Protecting Active Directory Domain Controllers

NEW QUESTION 7

A customer has a local VMware environment that they back up locally and offload all retention to Wasabi's Cloud. The local backups have become unavailable, and the customer has to recover from Wasabi's Cloud.

What method would provide the fastest RTO from Wasabi so that users can interact with the recovered system?

- A. Instant Recovery to EC2 VM
- B. Restore Entire VM to local VMware VM
- C. Instant Recovery to Wasabi Cloud VM
- D. Instant Recovery to local VMware VM

Answer: D

Explanation:

In a scenario where a customer needs to recover from Wasabi's Cloud due to local backups becoming unavailable, the method that would provide the fastest Recovery Time Objective (RTO) while allowing users to interact with the recovered system as quickly as possible is D: Instant Recovery to local VMware VM. Veeam's Instant Recovery feature allows for the restoration of a backup directly into the production environment without the need to fully copy the backup data. When recovering from cloud storage like Wasabi, the backup data will be streamed on-demand to the local VMware environment, allowing the VM to start running immediately while the remaining data is transferred in the background. This method minimizes downtime and provides the quickest path to operational recovery, ensuring users can access the recovered system with minimal delay. It's important to note that the effectiveness of this approach depends on the available bandwidth and the size of the data being recovered.

NEW QUESTION 8

What type of backup can Veeam Plug-ins for Enterprise Applications provide?

- A. A complete backup of the database and the host server
- B. A transactionally consistent backup of the database and its database logs
- C. A transactionally consistent backup of active director
- D. A backup of changes to the database after the agent backs up the whole server

Answer: B

Explanation:

Veeam Plug-ins for Enterprise Applications provide a transactionally consistent backup of databases and their database logs. This ensures that the backup is not only complete but also consistent at a transactional level, capturing all transactions up to the point of the backup. This is crucial for databases to ensure data integrity and consistency when restored. References: Veeam Plug-ins for Enterprise Applications Guide, Veeam Database Backup Best Practices

NEW QUESTION 9

For which workload can Veeam Data Platform achieve image-level backups?

- A. AS/400
- B. Solaris
- C. IOS
- D. IHP-UX

Answer: B

Explanation:

Veeam Data Platform can achieve image-level backups for Solaris workloads. This means it can create a complete backup of the system at the image level, capturing the entire state of the Solaris system, including the operating system, applications, and data. References: Veeam Data Platform Documentation, Veeam Solaris Backup Guide

NEW QUESTION 10

Hourly backup jobs are configured to local repositories. Daily backups must be sent from Site B to the repository on Site A. The connection between the two sites does not allow a direct backup to complete within the backup window. Impact on the source VMs at Site B should be minimized. Which type of job and Veeam components should be used to provide the necessary protection?

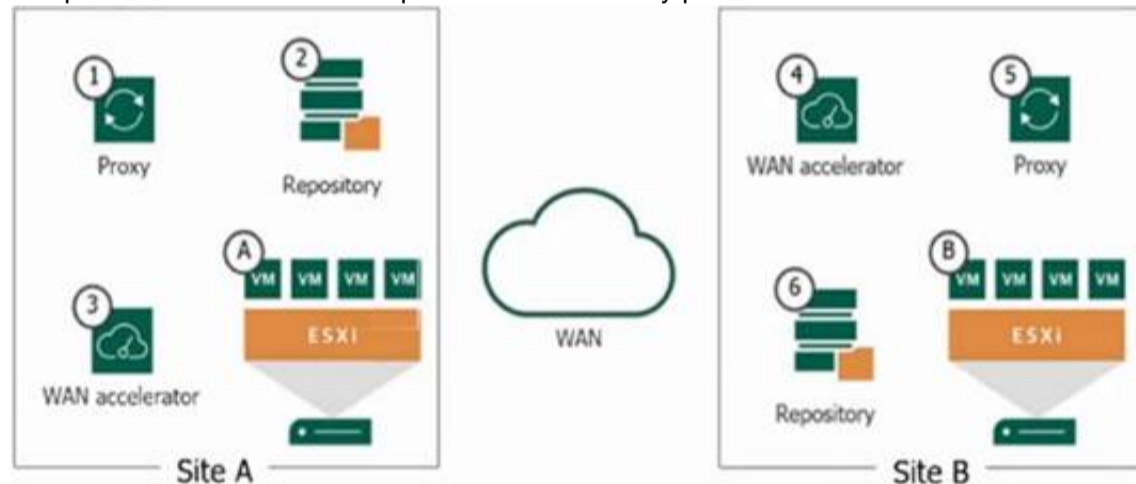

- A. A backup copy job and components 6 ? 4 ? 3 ? 2
- B. A backup job and components 5 ? 4 ? 3 ? 2
- C. A backup job and components 5 ? 2
- D. A backup copy job and components 6?5?4?3?1 ? 2

Answer: A

Explanation:

For the given scenario where daily backups need to be sent from Site B to a repository at Site A and the connection between the two sites is limited, thus impacting the ability to complete direct backups within the backup window, a Backup Copy Job would be appropriate. A Backup Copy Job is a feature in Veeam Backup & Replication that allows you to create several instances of the same backup files across different locations (repositories).

In the image provided, the components involved in the Backup Copy Job from Site B to Site A would be:

? 6 (Repository at Site B): This is the source repository where the hourly backup jobs are stored.

? 4 and 3 (WAN Accelerators at both sites): These components optimize data transfer over the WAN.

? 2 (Repository at Site A): This is the target repository where the backup copies will be stored.

This setup would minimize impact on the source VMs at Site B since the Backup Copy Job works with backup data rather than directly with the production VMs, thus reducing the load on those VMs during the process.

NEW QUESTION 10

Backup jobs are configured to local repositories. Backups must be sent from Site B to the repository on Site A. The connection between the two sites does not allow a direct backup to complete within the backup window. Which type of job and Veeam components should be used to provide the necessary protection?

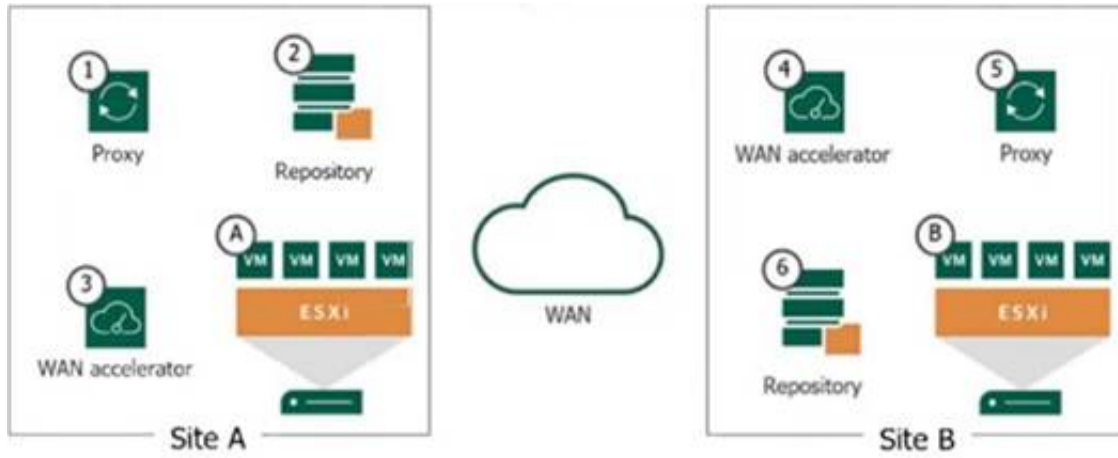

- A. A backup copy job and components 6 ? 4 ? 3 ? 2
- B. A backup job and components 5 ? 4 ? 3 ? 2
- C. A backup copy job and components 6?5?4?3?1?2
- D. A backup copy job and components 6 ? 4 ? 2

Answer: A

Explanation:

In a scenario where backups need to be sent from Site B to a repository at Site A and the direct backup cannot complete within the backup window due to connection limitations, a Backup Copy Job is the most suitable type of job. The Backup Copy Job can transfer data efficiently and with reduced impact on the production environment. The components involved would be:

? 6 (Repository at Site B): Where the initial backups are stored.

? 4 (WAN Accelerator at Site A): To optimize the data transfer over the WAN.

? 3 (WAN Accelerator at Site B): To prepare the backup data for transfer.

? 2 (Repository at Site A): The target repository for the backup copies. This configuration leverages the WAN Accelerators to reduce the amount of data that needs to travel over the WAN, thus allowing the backup copy job to complete within the available window.

NEW QUESTION 15

Company security policy states that backups must be copied to a remote location within 8 hours.

What step can a backup administrator take to receive an alert automatically if the backup copy job violates the company's policy?

- A. Set a Data Protection alert in Enterprise Manager
- B. Set a backup copy window alert on the repository
- C. Set up post-thaw scripts to send an email
- D. Enable the appropriate RPO monitor

Answer: D

Explanation:

To receive an automatic alert if the backup copy job violates the company's 8-hour policy for copying backups to a remote location, the backup administrator should enable the appropriate Recovery Point Objective (RPO) monitor. This feature tracks the age of the latest backup and alerts when it exceeds the defined RPO. References: Veeam Backup & Replication Documentation, Veeam RPO Monitoring and Reporting Guide

NEW QUESTION 20

A Veeam engineer needs to copy backup files from a Windows repository in Site A to a Linux repository in Site B. The WAN connection between the two sites is busy during business hours. The engineer needs to configure a backup copy job to accomplish this task.

Which feature of the backup copy job should be configured to avoid transferring data during business hours?

- A. Immediate copy
- B. Periodic copy
- C. WAN accelerator
- D. Backup Copy Window

Answer: D

Explanation:

In a scenario where a Veeam engineer needs to manage backup file transfers between two sites without impacting bandwidth during business hours, the most appropriate feature to configure in the backup copy job is D: Backup Copy Window. The Backup Copy Window setting in Veeam Backup & Replication allows for specifying the time frame during which the backup copy job is allowed to transfer data. By configuring this window to exclude business hours, the engineer can ensure that the backup copy job transfers data only during off-peak hours, thereby avoiding additional strain on the WAN connection when it is most needed for business operations. This approach provides the flexibility to balance the need for offsite backups with the practical bandwidth considerations of a busy WAN connection, ensuring that backup activities do not interfere with critical business functions.

NEW QUESTION 22

A mid-sized company uses Veeam Backup and Replication to safeguard their business- critical data from ransomware attacks. The company needs to validate backups and increase security, while improving DevOps efficiency.

How can a SureBackup Job be utilized to address the company's specific needs?

- A. Helps improve the data deduplication and compression ratios
- B. Validates backup data and ensures backups are ransom ware-free
- C. Creates a secure, isolated environment to test new applications
- D. Improves recovery speed reducing RTO

Answer: C

Explanation:

A SureBackup Job in Veeam Backup and Replication can be utilized to create a secure, isolated environment to test new applications. This feature allows companies to validate backups and run their VMs in an isolated environment, providing an opportunity to test applications, patches, or updates without impacting the production environment. References: Veeam Backup & Replication Documentation, Veeam SureBackup Guide

NEW QUESTION 24

Veeam Backup & Replication is currently configured to keep backups for 14 days on a NAS repository. An engineer needs to enable GFS with 12 monthly and 5 yearly full backups to extend the retention for archival purposes but does not have enough space on the repository to store them. After adding the repository to Scale-Out-Backup Repository (SOBR) as Performance Tier, which option should the engineer choose to solve this issue?

- A. Add an Object Storage as Capacity tier and set the policy to copy backups to object storage as soon as they are created
- B. Add another NAS repository as Capacity tier and set the policy to move backups older than 14 days
- C. Add an Object Storage as Archive tier and set the policy to move all GFS backups
- D. Add an Object Storage as Capacity tier and set the policy to move backups older than 14 days

Answer: D

Explanation:

To solve the space issue while enabling GFS retention, the engineer should add an Object Storage as a Capacity tier to the Scale-Out Backup Repository (SOBR) and set the policy to move backups that are older than 14 days. This approach allows for efficient use of local NAS storage for short-term retention and leverages object storage for long-term archival purposes. References: Veeam Backup & Replication User Guide, Veeam SOBR Configuration Guide

NEW QUESTION 28

A Veeam administrator wants to diagnose known issues in the configuration and performance of backup infrastructure without involving Veeam Technical Support. What feature of Veeam One should the administrator use?

- A. Intelligent Diagnostics
- B. Log Shipping Servers
- C. Business View
- D. Best Practices Analyzer

Answer: A

Explanation:

For diagnosing known issues in the configuration and performance of the backup infrastructure without the direct involvement of Veeam Technical Support, the administrator should utilize A: Intelligent Diagnostics in Veeam One. Intelligent Diagnostics is a feature designed to proactively detect known issues within the Veeam backup infrastructure by analyzing the system's event logs, performance data, and configurations. It uses predefined patterns and rules derived from common issues identified by Veeam Support to provide early warnings and suggest corrective actions. This self-service approach enables administrators to address potential problems before they impact operations, enhancing the reliability and efficiency of the backup infrastructure.

NEW QUESTION 29

Veeam is being used to back up a Microsoft SQL VM with transaction logs being backed up every 30 minutes to a repository that is local to the Veeam Backup and Replication server. Business requirements dictate that the database backup and all logs also be stored on a secondary, standalone repository in the DR datacenter. What should the Veeam engineer configure to meet the requirements?

- A. Backup Copy Job in Periodic Copy mode
- B. SOBR with Copy mode enabled
- C. Backup Copy Job using the SQL Transaction Log Job as the source
- D. Backup Copy Job in Immediate mode

Answer: C

Explanation:

In Veeam Backup & Replication, to meet the business requirements of having both the database backup and transaction logs stored at a secondary location, a Backup Copy Job can be configured. The Backup Copy Job can be set to include both the VM backup and the transaction logs, ensuring that the database's recovery points are consistent and available at the DR site. The transaction logs backup every 30 minutes can be specified as the source for the Backup Copy Job, ensuring that the transaction log backups are also copied to the secondary repository.

NEW QUESTION 34

A company is running nightly backups to satisfy their 24-hour RPO. There are two critical applications that cannot be offline more than 4 hours with no more than an hour of data loss. How can this be accomplished?

- A. Linux hardened repository with immutability
- B. A local SOBR with AWS Object storage
- C. Backup copy jobs with hourly VM replication
- D. Enable Continuous Backup Replication

Answer: C

Explanation:

To meet the stringent Recovery Time Objective (RTO) of 4 hours and Recovery Point Objective (RPO) of 1 hour for the two critical applications, the most suitable approach is to use a combination of backup copy jobs and hourly VM replication, which corresponds to answer C. Backup copy jobs can ensure that backups are available offsite for disaster recovery purposes, while VM replication provides the ability to quickly failover to a replica VM in case of a primary VM failure, thereby minimizing downtime. Veeam's replication capabilities are designed to create exact copies of VMs at regular intervals, which can then be rapidly activated in case of a failure. This strategy ensures that the applications can be brought back online within the 4-hour RTO, with data loss not exceeding the 1-hour RPO, thus meeting the company's stringent data protection requirements for these critical applications.

NEW QUESTION 38

An engineer needs to be able to perform all functions without needing to access the backup server locally or over remote desktop. What should the engineer do?

- A. Use SSH to connect to the Veeam Backup & Replication server.
- B. Install the required Veeam Explorers locally
- C. Install the Veeam console on the engineer's desktop.
- D. Use Enterprise Manager to connect to the Veeam Backup & Replication server.

Answer: C

Explanation:

To perform all functions without needing to access the backup server locally or over remote desktop, the engineer can install the Veeam console on their desktop. This allows the engineer to remotely manage and control the Veeam Backup & Replication infrastructure. The console provides full access to the backup server's capabilities from any machine within the network, making it unnecessary to log in directly to the server. References:
 ? Veeam Backup & Replication User Guide: Veeam Backup & Replication Console
 ? Veeam Help Center: Remote Management with Veeam Backup & Replication Console

NEW QUESTION 43

A Veeam proxy server is configured as follows. No modifications are allowed to the transport mode. When performing a restore of a VMware virtual disk using this proxy server, the restore fails. What is a possible cause?

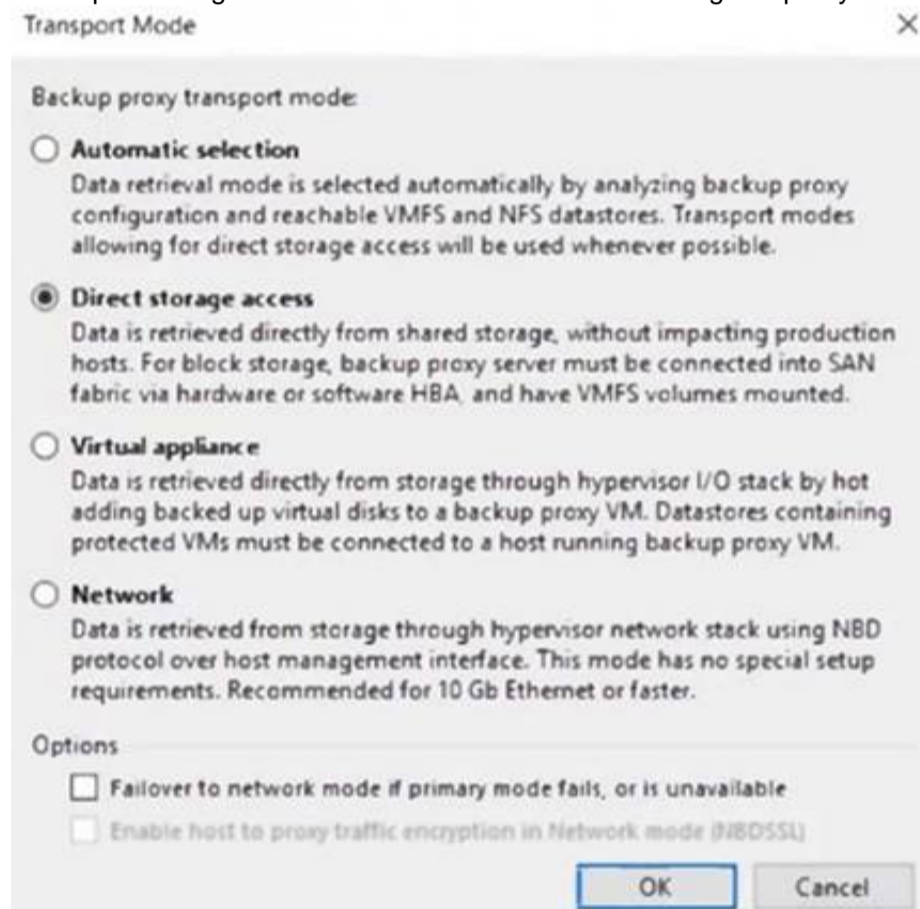

- A. CBT is enabled on the virtual disk.
- B. CBT is disabled on the virtual disk.
- C. The virtual disk is thin-provisioned.
- D. The virtual disk is thick-provisioned

Answer: C

Explanation:

Given the provided transport modes and the fact that no modifications are allowed to these settings, a possible cause for the restore of a VMware virtual disk to fail using this proxy server is C: The virtual disk is thin-provisioned. In the transport modes shown, the Direct storage access and Virtual appliance options would require the VM disk files to be accessible in a certain way that might not be compatible with thin-provisioned disks depending on the storage configuration and the current state of the VM. If the storage integration specifics or the snapshot handling do not support the thin-provisioned format, the restore operation could fail. It's important to ensure that the transport mode selected is compatible with the type of virtual disk being restored to prevent such issues.

NEW QUESTION 44

A planned failover of three VMs has just completed successfully, starting the VMs at the disaster recovery location. What next actions are available for the failover plan?

- A. Undo, Start, Edit, Delete
- B. Undo, Start, Copy, Delete
- C. Cancel
- D. Start, Edit, Delete
- E. Cancel, Start, Copy, Delete

Answer: A

Explanation:

After completing a planned failover for VMs to the disaster recovery site, the typical actions available in Veeam Backup & Replication for a failover plan are:
 ? Undo: This allows you to reverse the failover and return the VMs to the original location.
 ? Start: This would be used to initiate the failover plan if it needs to be executed again.
 ? Edit: This option permits modifications to the failover plan.
 ? Delete: This allows the removal of the failover plan if it is no longer needed. There are no options for Copy in the context of a failover plan, and the Cancel option

is typically available before and during the failover process, not after completion.

NEW QUESTION 49

Why is it recommended to install Veeam ONE before Veeam Backup & Replication?

- A. Veeam ONE stores the license file necessary for Veeam Backup & Replication.
- B. Veeam ONE can verify that the server meets the minimum requirements to install Veeam Backup & Replication.
- C. Veeam ONE is a prerequisite for Veeam Backup & Replication installation.
- D. Veeam ONE can potentially identify infrastructure issues prior to performing a backup.

Answer: D

Explanation:

It is recommended to install Veeam ONE before Veeam Backup & Replication because Veeam ONE can potentially identify infrastructure issues that might affect backup operations before they are performed. This proactive approach ensures that the environment is optimized for successful backup and replication tasks. References: Veeam Installation and Configuration Guide, Veeam ONE Deployment Best Practices

NEW QUESTION 50

.....

Thank You for Trying Our Product

We offer two products:

1st - We have Practice Tests Software with Actual Exam Questions

2nd - Questions and Answers in PDF Format

VMCE_v12 Practice Exam Features:

- * VMCE_v12 Questions and Answers Updated Frequently
- * VMCE_v12 Practice Questions Verified by Expert Senior Certified Staff
- * VMCE_v12 Most Realistic Questions that Guarantee you a Pass on Your FirstTry
- * VMCE_v12 Practice Test Questions in Multiple Choice Formats and Updatesfor 1 Year

100% Actual & Verified — Instant Download, Please Click
[Order The VMCE_v12 Practice Test Here](#)